

EXHIBIT "A"

LEGAL DESCRIPTION

ESCROW NO.: 030202997

Parcel 4J as set forth on Parcel Map #4 LDA 01-016 for MIKIM DEVELOPMENT, filed in the office of the County Recorder of Douglas County, State of Nevada, on August 13, 2002 in Book 0802, at Page 3357, as Document No. 549324.

ASSESSOR'S PARCEL NO. 1219-15-002-063

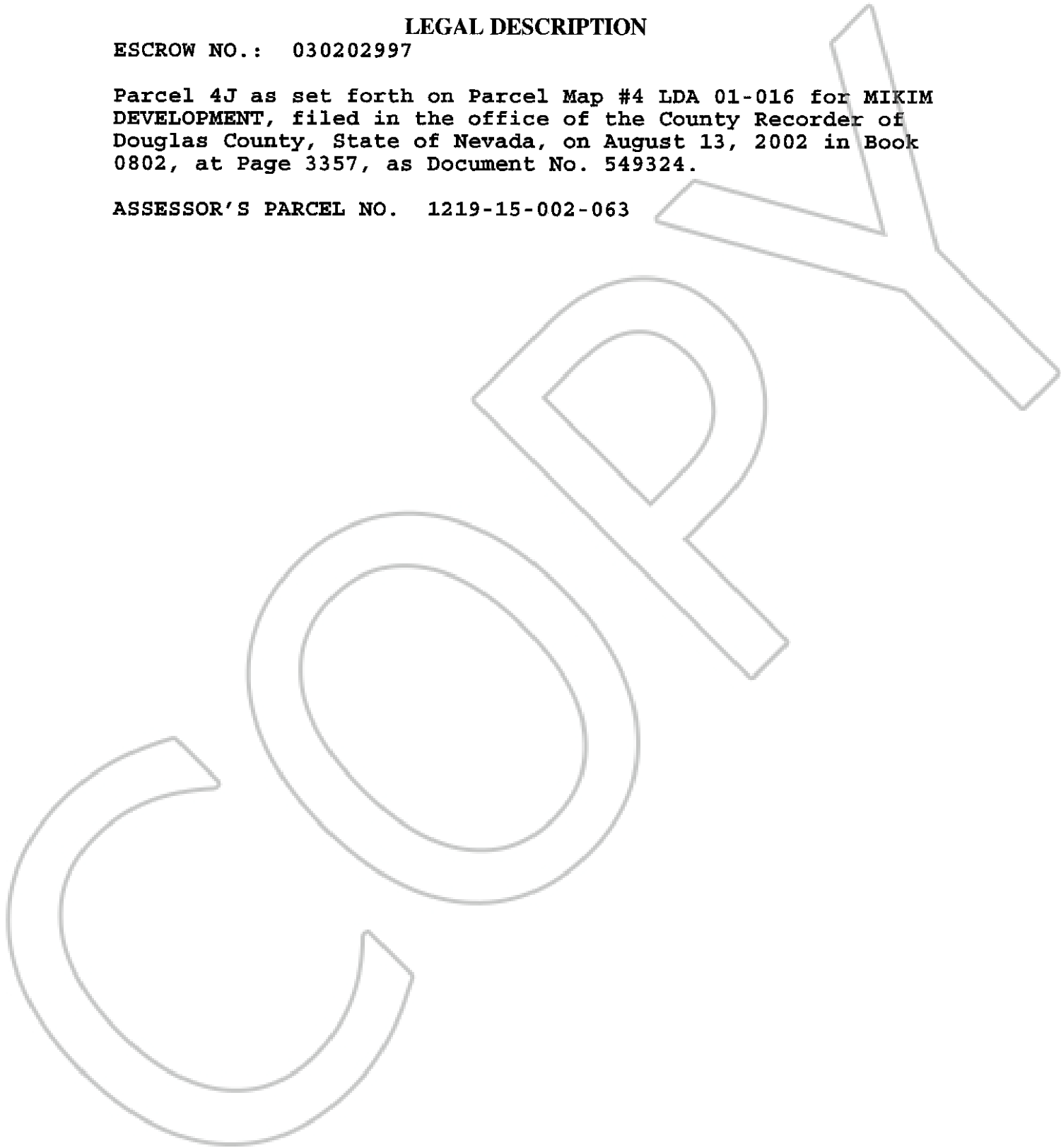

0594712
BK1003PG12493