

A.P.N. # 1219-15-002-056  
R.P.T.T. \$ 0.00 \$5  
ESCROW NO. 030103675  
RECORDING REQUESTED BY:  
**STEWART TITLE COMPANY**  
MAIL TAX STATEMENTS TO:  
**SAME AS BELOW**

REQUESTED BY  
**Stewart Title of Douglas County**  
IN OFFICIAL RECORDS OF  
DOUGLAS CO., NEVADA  
2003 OCT 29 PM 3:17  
WERNER CHRISTEN  
RECORDER  
\$15<sup>00</sup> PAID kg DEPUTY

WHEN RECORDED MAIL TO:  
**GRANTEE**  
2568 LAKE TAHOE  
S. LAKE TAHOE, CA 96150

(Space Above for Recorder's Use Only)

**GRANT, BARGAIN, SALE DEED**

THIS INDENTURE WITNESSETH: That **PHILLIP JOE SMITH, spouse of the Grantee herein**

in consideration of \$10.00, the receipt of which is hereby acknowledged, does hereby Grant, Bargain Sell and Convey to **LISBETH T. SMITH, a married woman as her sole and separate property**

and to the heirs and assigns of such Grantee forever, all that real property situated in the County of **Douglas** State of Nevada, bounded and described as :

**SEE EXHIBIT "A" ATTACHED HERETO AND MADE A PART HEREOF**

IT IS THE EXPRESS INTENT OF THE GRANTOR, BEING THE SPOUSE OF THE GRANTEE, TO CONVEY ALL RIGHT, TITLE AND INTEREST OF THE GRANTOR, COMMUNITY OR OTHERWISE, IN AND TO THE HEREIN DESCRIBED PROPERTY TO THE GRANTEE AS GRANTEE'S SOLE AND SEPARATE PROPERTY.

Together with all and singular the tenements, hereditaments and appurtenances thereunto belonging or in anywise appertaining, and any reversions, remainders, rents, issues or profits thereof.

DATE: **October 10, 2003**

*Phillip Joe Smith*  
**PHILLIP JOE SMITH**

**SUZANNE CHEECHOV**  
NOTARY PUBLIC  
STATE OF NEVADA  
Appt. Rec. in Douglas County  
My Appt. Expires June 25, 2007  
No: 99-36456-5

**SUZANNE CHEECHOV**  
NOTARY PUBLIC  
STATE OF NEVADA  
Appt. Recorded in Douglas County  
My Appt. Expires June 25, 2007  
No: 99-36456-5

STATE OF NEVADA }  
COUNTY OF DOUGLAS } SS.

This instrument was acknowledged before me on 10-27-03  
by, **PHILLIP JOE SMITH**

Signature *Suzanne Cheechov*  
Notary Public (One Inch Margin on all sides of Document for Recorder's Use Only)

0595226

**EXHIBIT "A"**

**LEGAL DESCRIPTION**

**ESCROW NO.: 030103675**

**Parcel 4C as set forth on Parcel Map #1 LDA 01-013 for MIKIM DEVELOPMENT, filed in the office of the County Recorder of Douglas County, State of Nevada, on August 13, 2002 in Book 0802, at Page 3354, as Document No. 549321.**

**Assessor's Parcel No. 1219-15-002-056**

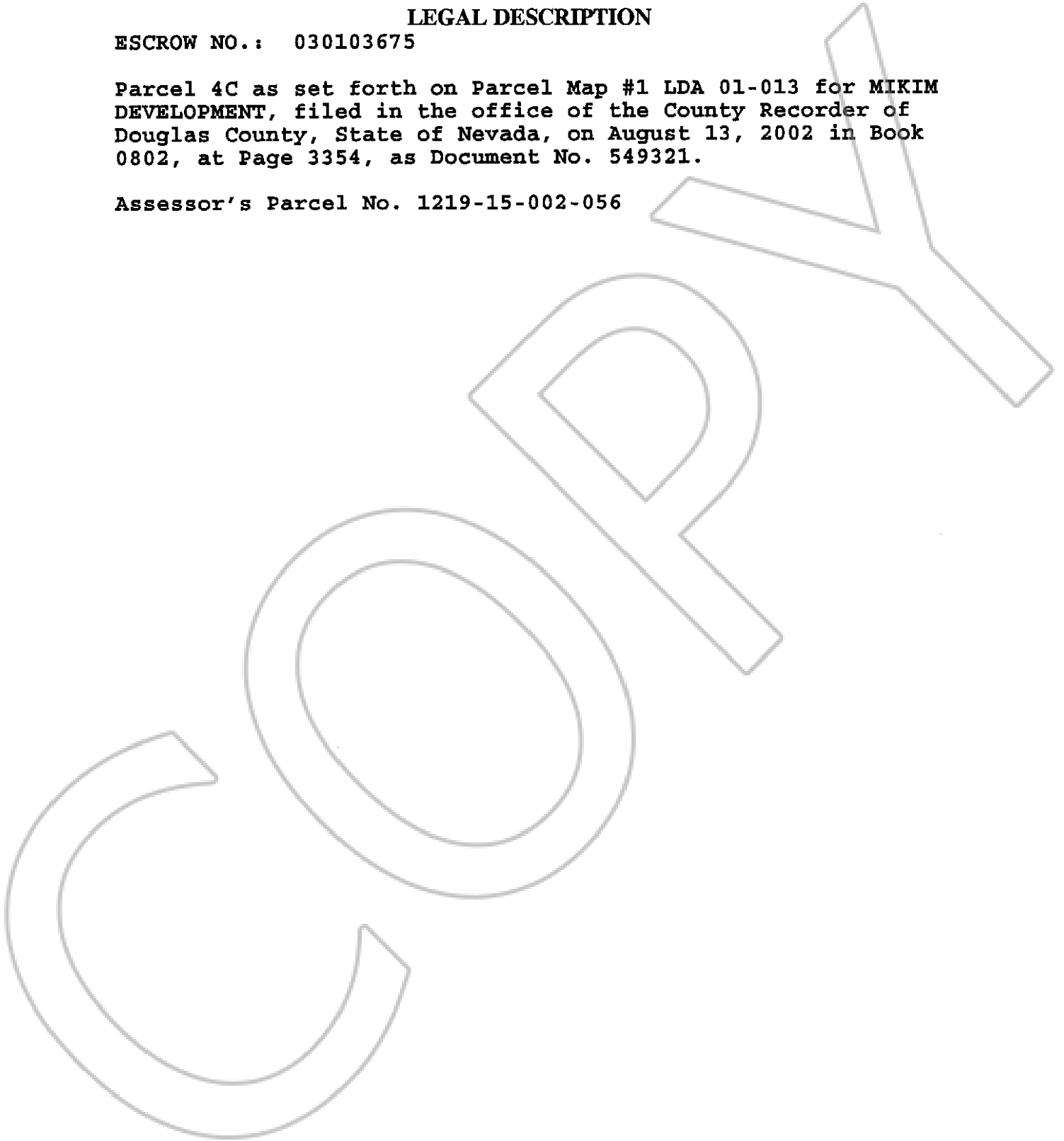

**0595226**

**BK1003PG15283**