

APN: 1420-29-710-007

RPTT \$¹⁶ Full Value Full Value less liens

2003 NOV -3 AM 11: 32

WHEN RECORDED MAIL TO:
Name CHERYL A. GLASER
Street 1135 COUNTRY CLUB DR.
Address
City, State MINDEN, NV 89423
Zip

MAIL TAX STATEMENTS TO:
Name CHERYL A. GLASER
Street 1135 COUNTRY CLUB DR.
Address
City, State MINDEN, NV 89423
Zip
Order 00088995-201- KLS
No.

WERNER CHRISTEN
RECORDER

\$16 PAID *KJ* DEPUTY

(SPACE ABOVE THIS LINE FOR RECORDERS USE)

GRANT, BARGAIN AND SALE DEED

THIS INDENTURE WITNESSETH: That

FOR A VALUABLE CONSIDERATION, receipt of which is hereby acknowledged, CHERYL ANN GLASER, A MARRIED WOMAN AS HER SOLE AND SEPARATE PROPERTY, do(es) hereby GRANT(s) BARGAIN SELL and CONVEY to CHERYL ANN GLASER, TRUSTEE OR SUCCESSOR TRUSTEE OF THE CHERYL ANN GLASER TRUST DATED OCTOBER 15, 1998 and to the heirs and assigns of such Grantee forever, all the following real property situated in the County of Douglas, State of Nevada bounded and described as follows:

See Exhibit A attached hereto and made a part hereof.

TOGETHER with all tenements, hereditaments and appurtenances, if any, thereto belonging or appertaining, and any reversions, remainders, rents, issues or profits thereof.

Dated: October 23, 2003

0595607

BK 1103 PG 00304

Cheryl Ann Glaser
CHERYL ANN GLASER

STATE OF NEVADA

COUNTY OF Douglas
This instrument was acknowledged before me on
October 23, 2003
by Cheryl Ann Glaser.

Kathy Swain
Notary Public

} ss



0595607

BK 1103PG00305

Exhibit A

All that real property situate in the County of Douglas, State of Nevada, described as follows:

Lot 72, in Block H, as set forth on FINAL MAP OF SARATOGA SPRINGS ESTATES UNIT NO. 3, a Planned Unit Development, filed for record in the office of the County Recorder of Douglas County, State of Nevada, on June 23, 1998, in Book 698, Page 5063, as Document No. 442616, Official Records of Douglas County, Nevada.

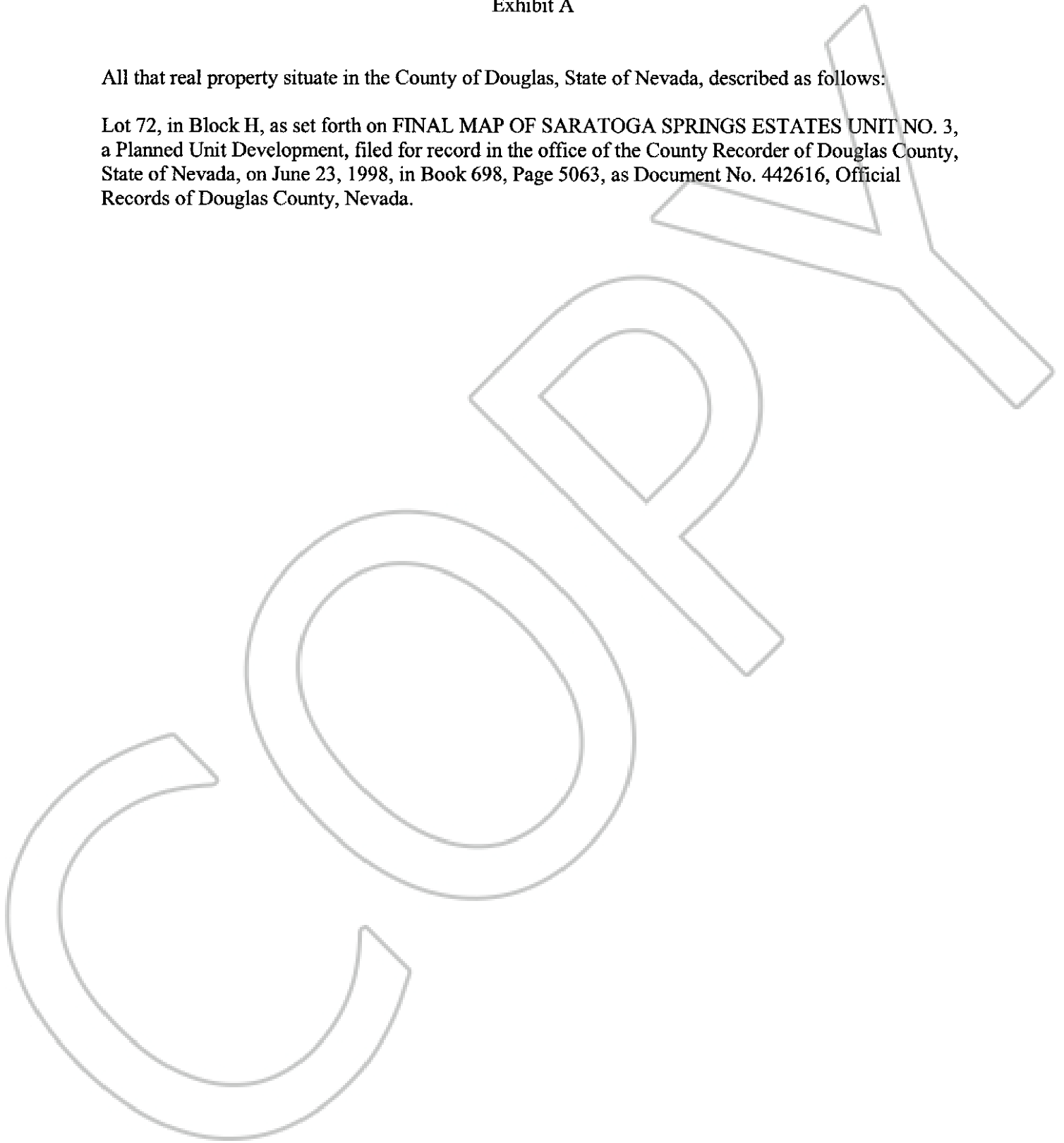

0595607
BK 1103 PG 00306