



**EXHIBIT "A"**

**LEGAL DESCRIPTION**

**ESCROW NO.: 030803531**

**Parcel 2-B, as set forth on that certain Parcel Map for CLAY KRUGER, located in a portion of Section 33, Township 13 North, Range 19 East, M.D.B&M., filed for record in the office of the County Recorder of Douglas County, Nevada on March 29, 1985, as Document No. 115403.**

**Assessor's Parcel No. 1319-33-002-011**

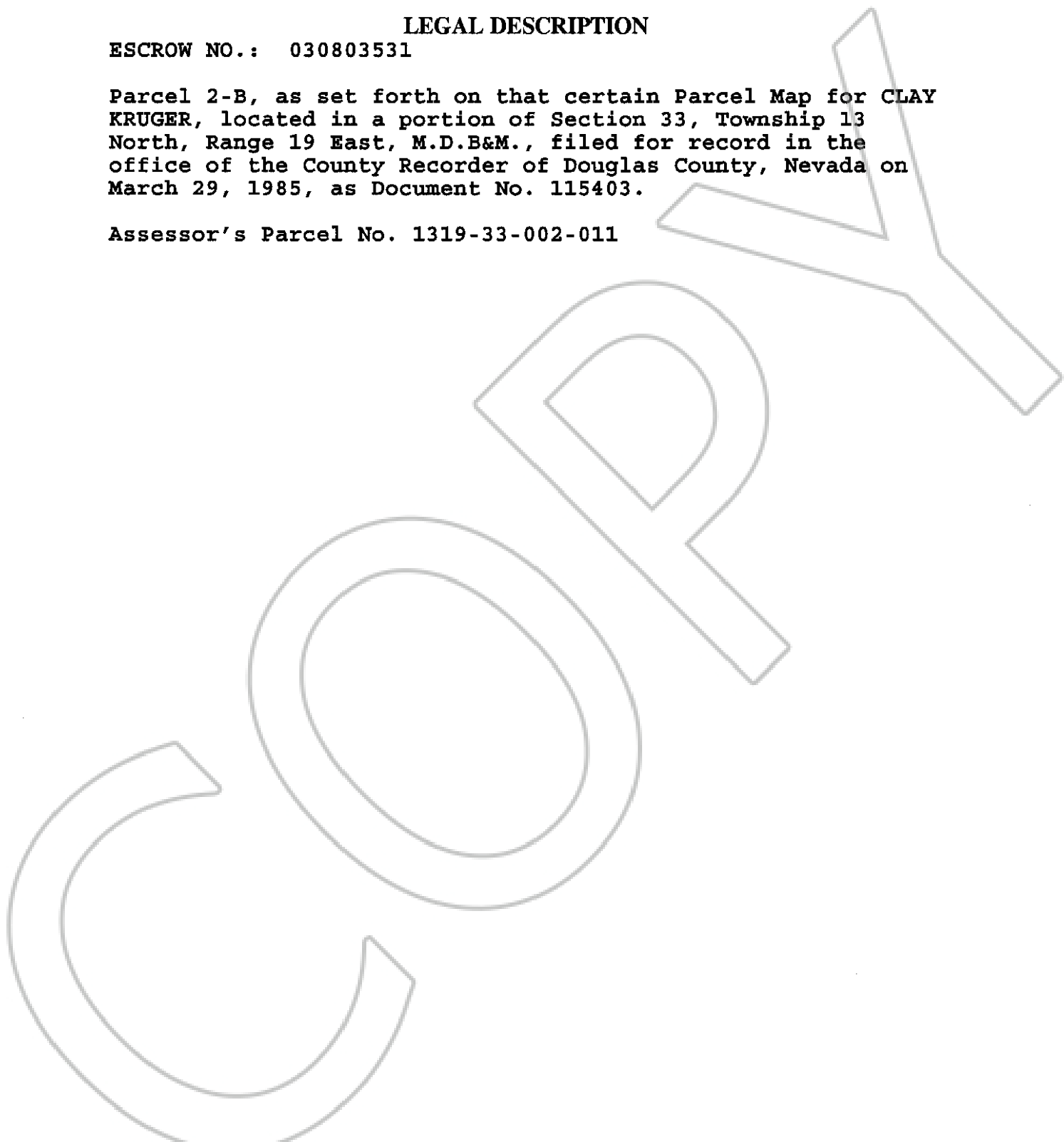

**0596365**

**BK1103PG04328**