

15

A.P.N. # 1220-15-410-038

R.P.T.T. \$ 0.00 #5  
ESCROW NO. \_\_\_\_\_

RECORDING REQUESTED BY:  
**STEWART TITLE COMPANY**  
MAIL TAX STATEMENTS TO:  
**SAME AS BELOW**

WHEN RECORDED MAIL TO:  
**GRANTEE**  
✓ **822 LONG VALLEY ROAD**  
**GARDNERVILLE, NV 89460**

REQUESTED BY  
Jennifer Blythe  
IN OFFICIAL RECORDS OF  
DOUGLAS CO., NEVADA

2003 NOV 14 PM 4:20

WERNER CHRISTEN  
RECORDER

\$15.00 PAID KJ DEPUTY

(Space Above for Recorder's Use Only)

**GRANT, BARGAIN, SALE DEED**

THIS INDENTURE WITNESSETH: That **JENNIFER LEE BLYTHE, A MARRIED WOMAN**

in consideration of \$10.00, the receipt of which is hereby acknowledged, does hereby Grant, Bargain Sell and Convey to **WILLIAM BLYTHE AND JENNIFER LEE BLYTHE, HUSBAND AND WIFE, AS JOINT TENANTS**

and to the heirs and assigns of such Grantee forever, all that real property situated in the County of **DOUGLAS** State of Nevada, bounded and described as:

**SEE EXHIBIT "A" ATTACHED HERETO AND MADE A PART HEREOF**

Together with all and singular the tenements, hereditaments and appurtenances thereunto belonging or in anywise appertaining, and any reversions, remainders, rents, issues or profits thereof.

DATE:

Jennifer Lee Blythe  
**JENNIFER LEE BLYTHE**



STATE OF NEVADA }  
COUNTY OF DOUGLAS } ss.

This instrument was acknowledged before me on 11/11/03  
by JENNIFER LEE BLYTHE

J. Mayo  
Signature \_\_\_\_\_

Notary Public (One inch margin on all sides of document for Recorder's Use Only)

0596836

BK1103PG06821

**EXHIBIT "A"**

**LEGAL DESCRIPTION**

Lot 25, Block 0, as shown on the map of GARDNERVILLE RANCHOS  
UNIT NO. 4, filed in the office of the County Recorder of  
Douglas County, Nevada, on April 10, 1967, as Document No.  
35914.

Assessors Parcel No. 1220-15-410-038

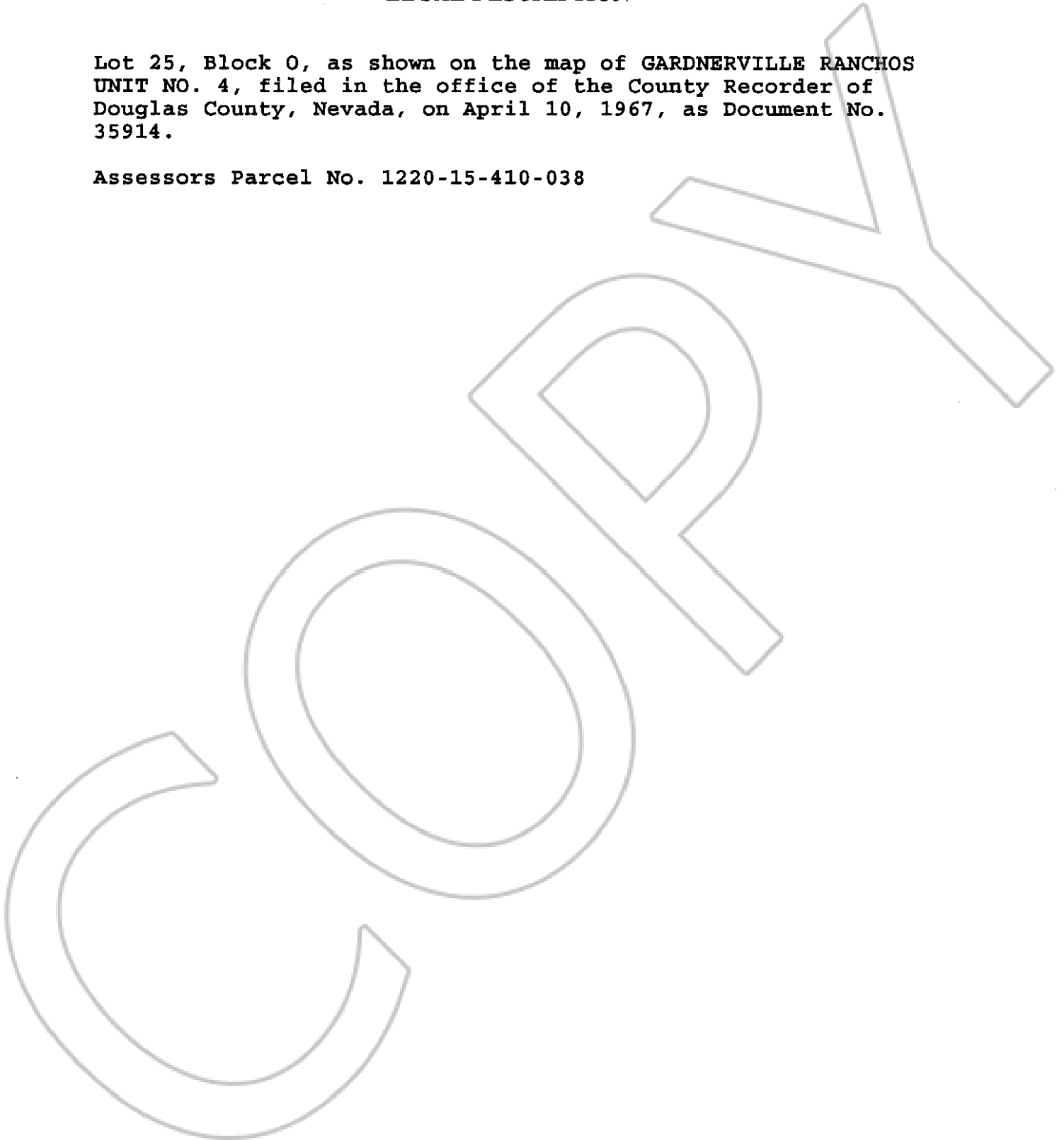

0596836

BK1103PG06822