



**EXHIBIT "A"**

**LEGAL DESCRIPTION**

**ESCROW NO.: 030103654**

**Lot 45, Block L, as shown on the map of GARDNERVILLE  
RANCHOS UNIT NO. 4, filed in the office of the County  
Recorder of Douglas County, Nevada, on April 10, 1967, as  
Document No. 35914.**

**Assessors Parcel No. 1220-15-410-097**

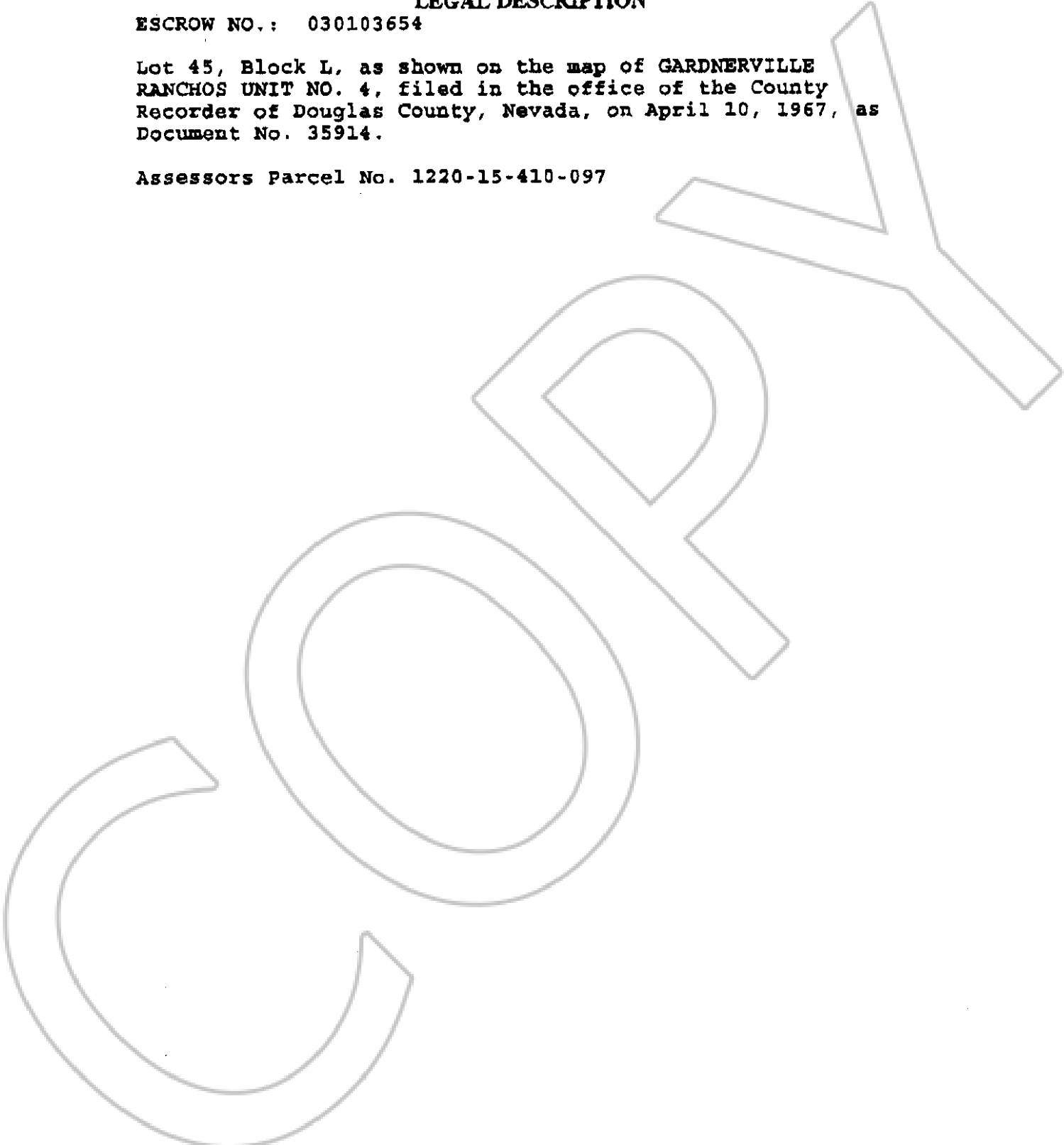

**0596993**

**BK 1103PG07387**