

A.P.N. 1320-14-001-009
Escrow No. 23101281
R.P.T.T. \$721.50
721.50

When recorded Mail To:
(Tax Statement Same)

Bently Family Limited Partnership

REQUESTED BY
MARQUIS TITLE & ESTRO
IN OFFICIAL RECORDS OF
DOUGLAS CO., NEVADA

2003 NOV 20 PM 4:40

WERNER CHRISTEN
RECORDER

\$ 17.00 PAID *A* DEPUTY

GRANT, BARGAIN AND SALE DEED

THIS INDENTURE WITNESSETH: That for a valuable consideration, receipt of which is hereby acknowledged, DONALD STUKEY AND BRENDA STUKEY, husband and wife as to an undivided 50% interest AND JANICE M. FOX, Trustee of the JANICE MARYLYN FOX LIVING TRUST u/t/d October 27, 1997 as to an undivided 50% interest

do(es) hereby **GRANT, BARGAIN, SELL and CONVEY** to **THE BENTLY FAMILY LIMITED PARTNERSHIP**, a Nevada Limited Partnership

all that real property situated in the County of Douglas, State of Nevada, being Assessor's Parcel Number **1320-14-001-009**, specifically described as follows:

SEE EXHIBIT "A" ATTACHED HERETO AND MADE A PART HEREOF FOR LEGAL DESCRIPTION

This Grant Deed has been signed in counterpart TOGETHER with all and singular the tenements, hereditaments and appurtenances, including easements and water rights, if any, thereto belonging or in anywise appertaining, and any reversions, remainders, rents, issues of profits thereof.

WITNESS my hand this 5th day of November, 2003.

JANICE M. FOX, Trustee of the JANICE MARLYN FOX LIVING TRUST u/t/d October 27, 1997

Donald Stucky

DONALD STUKEY

Brenda Stucky

BRENDA STUKEY

JANICE M. FOX, Trustee

STATE OF NEVADA
COUNTY OF
On 11-20-03, 2003, Donald Stucky + Brenda Stucky personally appeared before me, a Notary Public, who acknowledged that he executed the above instrument.

Beverly A. Sterling

Notary Public

 BEVERLY A. STERLING
Notary Public - State of Nevada
Appointment Recorded in Douglas County
No: 01-72047-5 - Expires August 1, 2006

0597346
BK1103PG09407

A.P.N. 1320-14-001-009
Escrow No. 23101281
R.P.T.T. \$721.50

When recorded Mail To:
(Tax Statement Same)

Bently Family Limited Partnership
C/o Brooke Shaw Zumpf
1590 Fourth Street, Suite 100
Minden, Nevada 89423

GRANT, BARGAIN AND SALE DEED

THIS INDENTURE WITNESSETH: That for a valuable consideration, receipt of which is hereby acknowledged, DONALD STUKEY AND BRENDA STUKEY, husband and wife as to an undivided 50% interest AND JANICE M. FOX, Trustee of the JANICE MARYLYN FOX LIVING TRUST u/t/d October 27, 1997 as to an undivided 50% interest

do(es) hereby **GRANT, BARGAIN, SELL and CONVEY** to **THE BENTLY FAMILY LIMITED PARTNERSHIP**, a Nevada Limited Partnership

all that real property situated in the County of Douglas, State of Nevada, being Assessor's Parcel Number **1320-14-001-009**, specifically described as follows:

SEE EXHIBIT "A" ATTACHED HERETO AND MADE A PART HEREOF FOR LEGAL DESCRIPTION

TOGETHER with all and singular the tenements, hereditaments and appurtenances, including easements and water rights, if any, thereto belonging or in anywise appertaining, and any reversions, remainders, rents, issues of profits thereof.

WITNESS my hand this 5th day of November, 2003.

JANICE M. FOX, Trustee of the JANICE MARLYN FOX LIVING TRUST u/t/d October 27, 1997

DONALD STUKEY

BRENDA STUKEY

Janice M. Fox, Trustee

JANICE M. FOX, Trustee

STATE OF NEVADA
COUNTY OF

On 11-20-03, 2003, Janice M. Fox personally appeared before me, a Notary Public, who acknowledged that he executed the above instrument.

Beverly A. Sterling

Notary Public

 BEVERLY A. STERLING
Notary Public - State of Nevada
Appointment Recorded in Douglas County
No. 01-72047-5 - Expires August 1, 2005

0597346
BK1103PG09408

CALIFORNIA ALL-PURPOSE ACKNOWLEDGMENT

State of California }
County of Riverside } ss.

On November 19, 2003 before me, Bethany R. Franz, Notary
Date Name and Title of Officer (e.g., "Jane Doe, Notary Public")

personally appeared Janice M. Fox
Name(s) of Signer(s)

personally known to me
 proved to me on the basis of satisfactory evidence

to be the person(s) whose name(s) is/are subscribed to the within instrument and acknowledged to me that he/she/they executed the same in his/her/their authorized capacity(ies), and that by his/her/their signature(s) on the instrument the person(s), or the entity upon behalf of which the person(s) acted, executed the instrument.

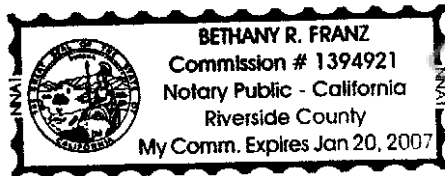

WITNESS my hand and official seal.

Bethany R. Franz
Signature of Notary Public

OPTIONAL

Though the information below is not required by law, it may prove valuable to persons relying on the document and could prevent fraudulent removal and reattachment of this form to another document.

Description of Attached Document

Title or Type of Document: _____

Document Date: _____ Number of Pages: _____

Signer(s) Other Than Named Above: _____

Capacity(ies) Claimed by Signer

Signer's Name: _____

- Individual
- Corporate Officer — Title(s): _____
- Partner — Limited General
- Attorney-in-Fact
- Trustee
- Guardian or Conservator
- Other: _____

Signer Is Representing: _____

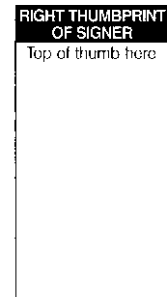

0597346

BK1103PG09409

EXHIBIT "A"

A parcel of land located within a portion of the West 1/2 of Section 14, Township 13 North, Range 20 East, M.D.B.&M., Douglas County, Nevada, being more particularly described as follows:

Parcel 38-D, as shown on the Parcel Map for DONALD A. and JANICE M. FOX and DONALD and BRENDA STUKEY, filed for record on November 16, 1994, in Book 1194, Page 2462, as Document No. 150718, Official Records of Douglas County, Nevada.

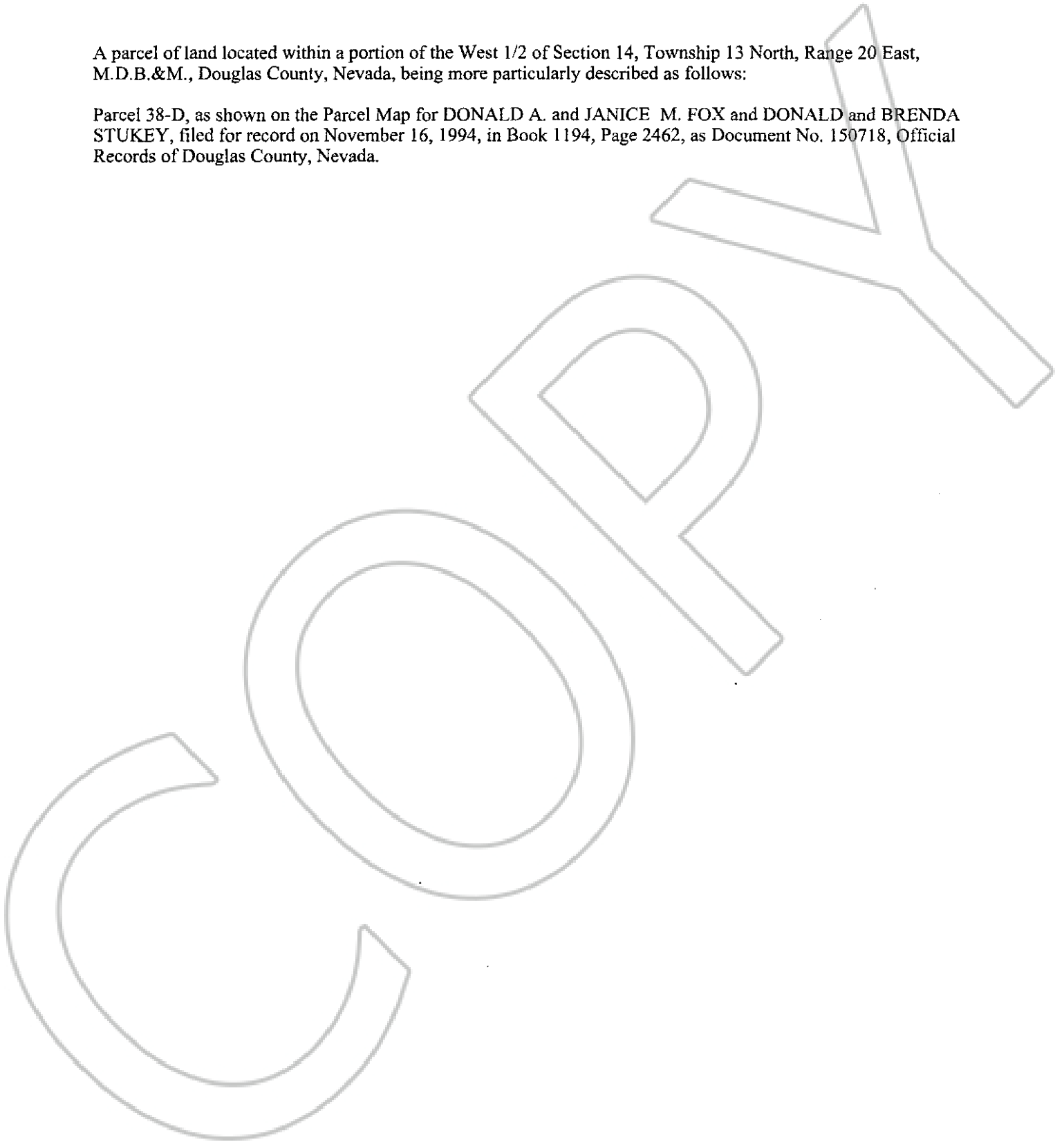

0597346

BK1103PG09410