

A.P.N. 1320-14-001-010
Escrow No. 23101281
R.P.T.T. \$643.50

When recorded Mail To:
(Tax Statement Same)

Bently Family Limited Partnership

REQUESTED BY
MARQUIS TITLE & ESCROW
IN OFFICIAL RECORDS
DOUGLAS CO., NEVADA

2003 NOV 20 PM 4:43

WERNER CHRISTEN
RECORDER

\$1500 PAID *W* DEPUTY

GRANT, BARGAIN AND SALE DEED

THIS INDENTURE WITNESSETH: That for a valuable consideration, receipt of which is hereby acknowledged, DONALD W. STUKEY AND BRENDA M. STUKEY, husband and wife (who acquired title as Donald Stukey and Brenda Stukey being one in the same

do(es) hereby **GRANT, BARGAIN, SELL and CONVEY** to **THE BENTLY FAMILY LIMITED PARTNERSHIP**, a Nevada Limited Partnership

all that real property situated in the County of Douglas, State of Nevada, being Assessor's Parcel Number **1320-14-001-010**, specifically described as follows:

SEE EXHIBIT "A" ATTACHED HERETO AND MADE A PART HEREOF FOR LEGAL DESCRIPTION

TOGETHER with all and singular the tenements, hereditaments and appurtenances, including easements and water rights, if any, thereto belonging or in anywise appertaining, and any reversions, remainders, rents, issues of profits thereof.

WITNESS my hand this 5th day of November, 2003.

Donald W. Stukey

DONALD W. STUKEY

Brenda M. Stukey

BRENDA M. STUKEY

STATE OF NEVADA
COUNTY OF

On 11-20-03, 2003, Donald W. Stukey + Brenda M. Stukey personally appeared before me, a Notary Public, who acknowledged that he executed the above instrument.

Beverly A. Sterling

Notary Public

 BEVERLY A. STERLING
Notary Public - State of Nevada
Appointment Recorded in Douglas County
No: 01-72047-5 - Expires August 1, 2005

0597347

BK1103PG09411

EXHIBIT "A"

A parcel of land located within a portion of the West 1/2 of Section 14, Township 13 North, Range 20 East, M.D.B.&M., Douglas County, Nevada, being more particularly described as follows:

Parcel 38-C, as shown on the Parcel Map for DONALD A. and JANICE M. FOX and DONALD and BRENDA STUKEY, filed for record on November 16, 1994, in Book 1194, Page 2462, as Document No. 150718, Official Records of Douglas County, Nevada.

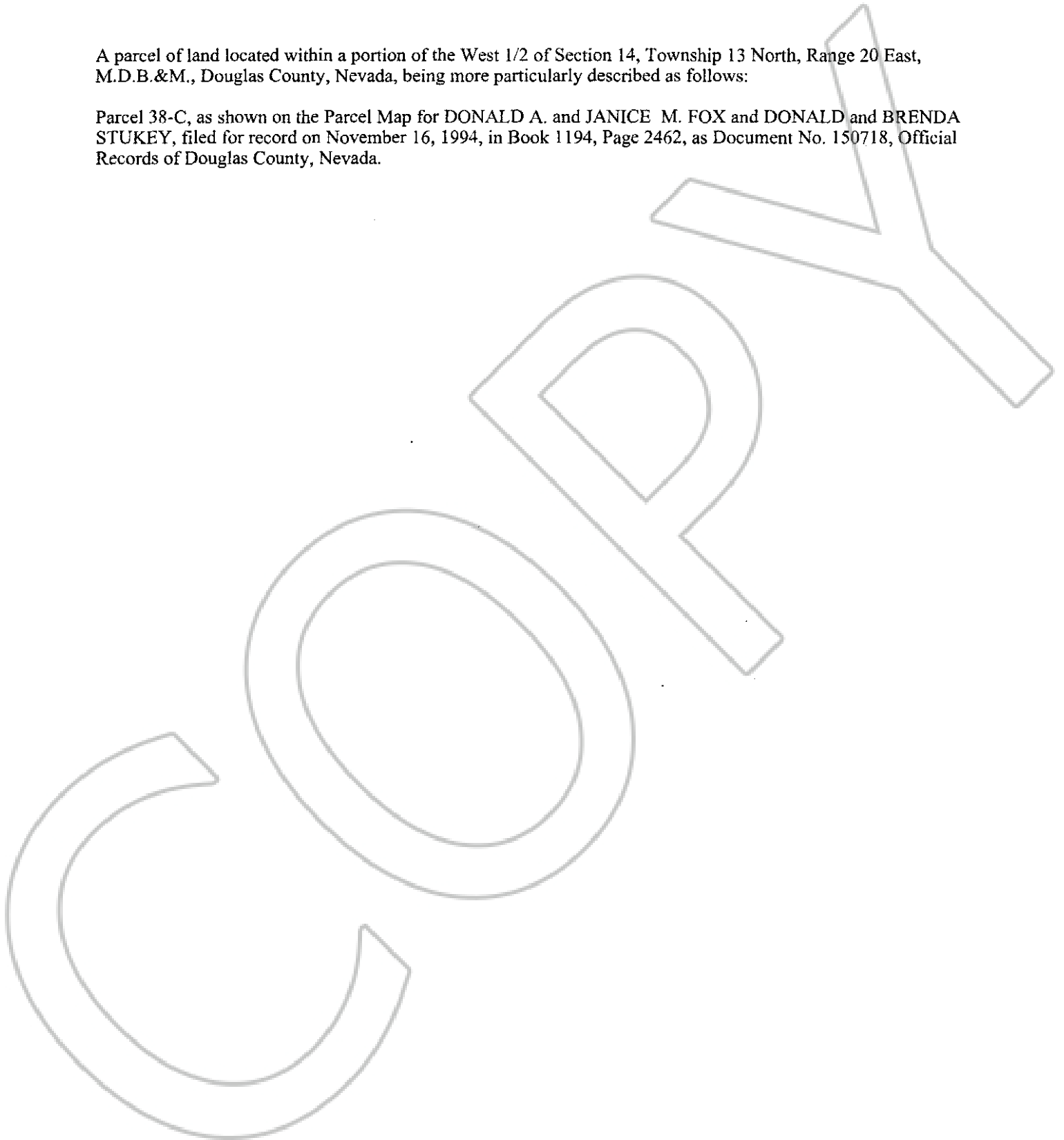

0597347

BK 1103PG09412