

A.P.N. # 1318-10-416-006

R.P.T.T. \$ 1579.50

ESCROW NO. 030203017

RECORDING REQUESTED BY:
STEWART TITLE COMPANY

MAIL TAX STATEMENTS TO:

Mr Bates
27 Castellina Dr
NewPort Coast CA 92657

WHEN RECORDED MAIL TO:

Mr. Bates
27 Castellina Dr
Newport Coast CA 92657

REQUESTED BY
Stewart Title of Douglas County

IN OFFICIAL RECORDS OF
DOUGLAS CO., NEVADA

2003 NOV 21 AM 11:03

WERNER CHRISTEN
RECORDER

\$ 15.00 PAID Bl DEPUTY

(Space Above for Recorder's Use Only)

GRANT, BARGAIN, SALE DEED

THIS INDENTURE WITNESSETH: That J. GEORGE DION & ELIZABETH I. DION, TRUSTEES OF THE DION FAMILY TRUST, CREATED ON FEBRUARY 3, 1990

in consideration of \$10.00, the receipt of which is hereby acknowledged, does hereby Grant, Bargain Sell and Convey to DAVID V. BATES, a married man as his sole and separate property

and to the heirs and assigns of such Grantee forever, all that real property situated in the County of Douglas State of Nevada, bounded and described as:

SEE EXHIBIT "A" ATTACHED HERETO AND MADE A PART HEREOF

Together with all and singular the tenements, hereditaments and appurtenances thereunto belonging or in anywise appertaining, and any reversion, remainders, rents, issues or profits thereof.

DATE: **September 29, 2003** DION FAMILY TRUST,
CREATED ON FEBRUARY 3, 1990

BY: J. George Dion
J. GEORGE DION
TRUSTEE

BY: Elizabeth I. Dion
ELIZABETH I. DION
TRUSTEE

STATE OF Nevada }
 } ss.
COUNTY OF Douglas }

This instrument was acknowledged before me on _____
by J. GEORGE DION and ELIZABETH I.
DION

Signature Peggy A. Elwell
Notary Public

(One Inch Margin on all sides of Document for Recorders Use Only)

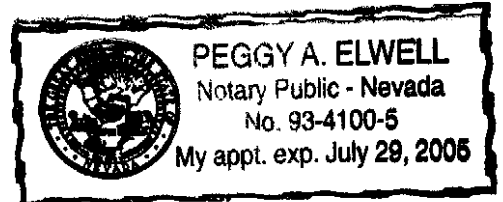

0597416

BK 1103 PG 09592

EXHIBIT "A"

LEGAL DESCRIPTION

ESCROW NO.: 030203017

Lot 5, in Block 5, of plat of Second addition to Zephyr Heights Subdivision No. 2, being a portion of Section 10, Township 13 North, Range 18 East, M.D.B.&M., as filed in the office of the County Recorder of Douglas County, Nevada on July 6, 1948 as Document No. 6530.

Assessors Parcel No. 1318-10-416-006

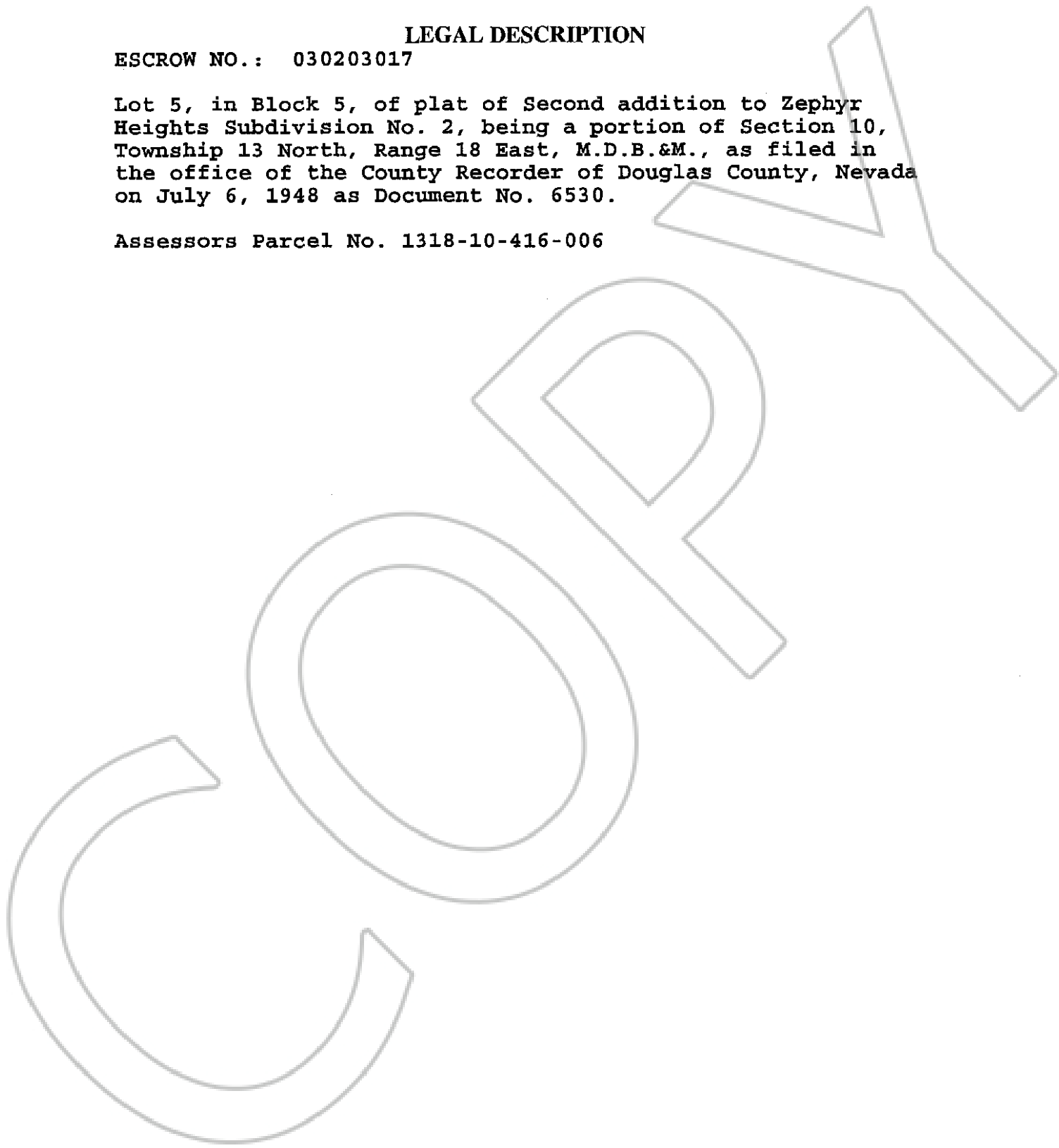

0597416

BK1103PG09593