

REQUESTED BY
WESTERN TITLE COMPANY, INC.
IN OFFICIAL RECORDS OF
DOUGLAS CO., NEVADA

2003 NOV 21 AM 11:32

WERNER CHRISTEN
RECORDER

\$15.00 PAID *OK* DEPUTY

Affix R.P.T.T.S -0- #3
APN 1320-33-713-007

Title Order No. 5114002186
Escrow No. 5114002186-GM

WIEN RECORDED MAIL TO:

Name Sara Maul, et al
Street 16720 Willow Creek Drive
Address Morgan Hill, CA 95037

City & State

MAIL TAX STATEMENTS TO: Grantee at address above

SPACE ABOVE THIS LINE FOR RECORDER'S USE

89184-99

GRANT, BARGAIN AND SALE DEED

FOR A VALUABLE CONSIDERATION, receipt of which is hereby acknowledged,
Richard Maul and Sara Maul, husband and wife

hereby GRANT(S), BARGAIN(S), SELL(S) and CONVEY(S) to
Sara Maul and Richard Maul, wife and husband, as Joint Tenants

that property in Douglas
described as:

County, Nevada,

Property described on Exhibit A attached hereto and made a part hereof.

Dated November 10, 2003

STATE OF NEVADA CA
COUNTY OF Santa Clara

Richard Maul
Richard Maul

Sara Maul
Sara Maul

On 11-13-03 before me,
the undersigned, a Notary Public in and for said State,
personally appeared Richard Maul
+ Sara Maul

personally known to me (or proved to me on the basis of
satisfactory evidence) to be the person(s) whose name(s)
is/are subscribed to the within instrument and
acknowledged to me that he/she/they executed the same
in his/her/their authorized capacity(ies), and that by
his/her/their signature(s) on the instrument the
person(s), or the entity upon behalf of which the
person(s) acted, executed the instrument.

WITNESS my hand and official seal.

Signature *J. Thomson*
Name J. Thomson

ORIC-410 4/2003

(typed or printed)

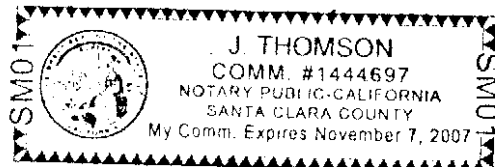

(This area for official notarial seal)

0597427

BK 1103 PG 09657

Legal Description

Lot 7 of Block A of FINAL SUBDIVISION MAP #1006-5 for CHICHESTER ESTATES, PHASE 5, according to the map thereof, filed in office of the County Recorder of Douglas County, State of Nevada, on April 9, 1999, Book 499, Page 1900, as Document No. 465394.

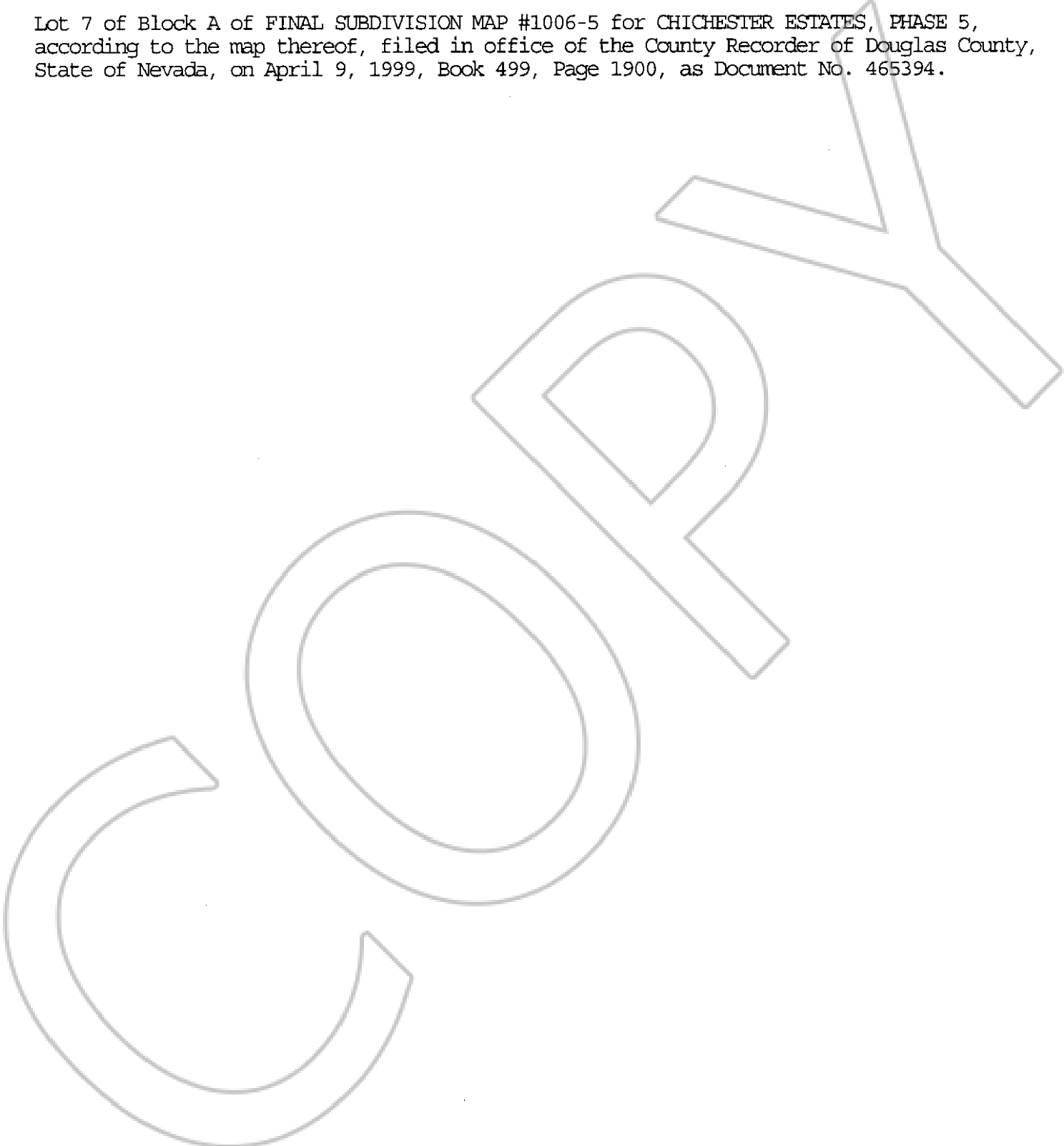

0597427

BK1103PG09658