

16- property address:
1353 CHICHESTER DR
A.P.N. # 1320-33-816-069 NV 89410

R.P.T.T. \$ #5
ESCROW NO. 030303259
RECORDING REQUESTED BY:
STEWART TITLE COMPANY
MAIL TAX STATEMENTS TO:
SAME AS BELOW

REQUESTED BY
Catherine Cheng-Orban
IN OFFICIAL RECORDS OF
DOUGLAS CO., NEVADA

2003 NOV 25 PM 12:12

WERNER CHRISTEN
RECORDER

PAID Bl DEPUTY

WHEN RECORDED MAIL TO:
CATHERINE CHENG-ORBAN PO Box
P.O. BOX 2010 1210
BRISBANE, CA 94005
GARDNERVILLE, NV. 89410

(Space Above for Recorder's Use Only)

GRANT, BARGAIN, SALE DEED

THIS INDENTURE WITNESSETH: That KURT ORBAN, a married man and spouse of Grantee herein

in consideration of \$10.00, the receipt of which is hereby acknowledged, does hereby Grant, Bargain Sell and Convey to CATHERINE CHENG-ORBAN, a married woman as her sole and separate property TRUSTEE OF THE CATHERINE K. CHENG TRUST, UAD APRIL 4, 1991 and to the heirs and assigns of such Grantee forever, all that real property situated in the County of DOUGLAS State of Nevada, bounded and described as:

SEE EXHIBIT "A" ATTACHED HERETO AND MADE A PART HEREOF

IT IS THE EXPRESS INTENT OF THE GRANTOR, BEING THE SPOUSE OF THE GRANTEE, TO CONVEY ALL RIGHT, TITLE AND INTEREST OF THE GRANTOR, COMMUNITY OR OTHERWISE, IN AND TO THE HEREIN DESCRIBED PROPERTY TO THE GRANTEE AS GRANTEE'S SOLE AND SEPARATE PROPERTY.

Together with all and singular the tenements, hereditaments and appurtenances thereunto belonging or in anywise appertaining, and any reversions, remainders, rents, issues or profits thereof.

DATE: September 30, 2003

[Signature]
KURT ORBAN

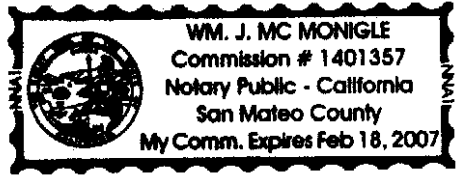

STATE OF CALIFORNIA }
COUNTY OF SAN MATEO } ss.

10-6-03
[Signature]

This instrument was acknowledged before me on 10-6-03 by, KURT ORBAN

Signature *[Signature]*
Notary Public (One Inch Margin on all sides of Document for Recorder's Use Only)

0597894

BK1103PG11317

EXHIBIT "A"

LEGAL DESCRIPTION

ESCROW NO.: 030303259

Lot 14, Block B, as set forth on FINAL SUBDIVISION MAP No. 1006-11 for CHICHESTER ESTATES, PHASE 11, filed in the office of the County Recorder of Douglas County, Nevada and recorded December 27, 2002 in Book 1202, Page 12732, as Document No. 562225, and by Certificate of Amendment recorded March 27, 2003 in Book 0303, Page 13037, as Document No. 0571430, Official Records of Douglas County, Nevada.

Assessors Parcel Number 1320-33-816-069

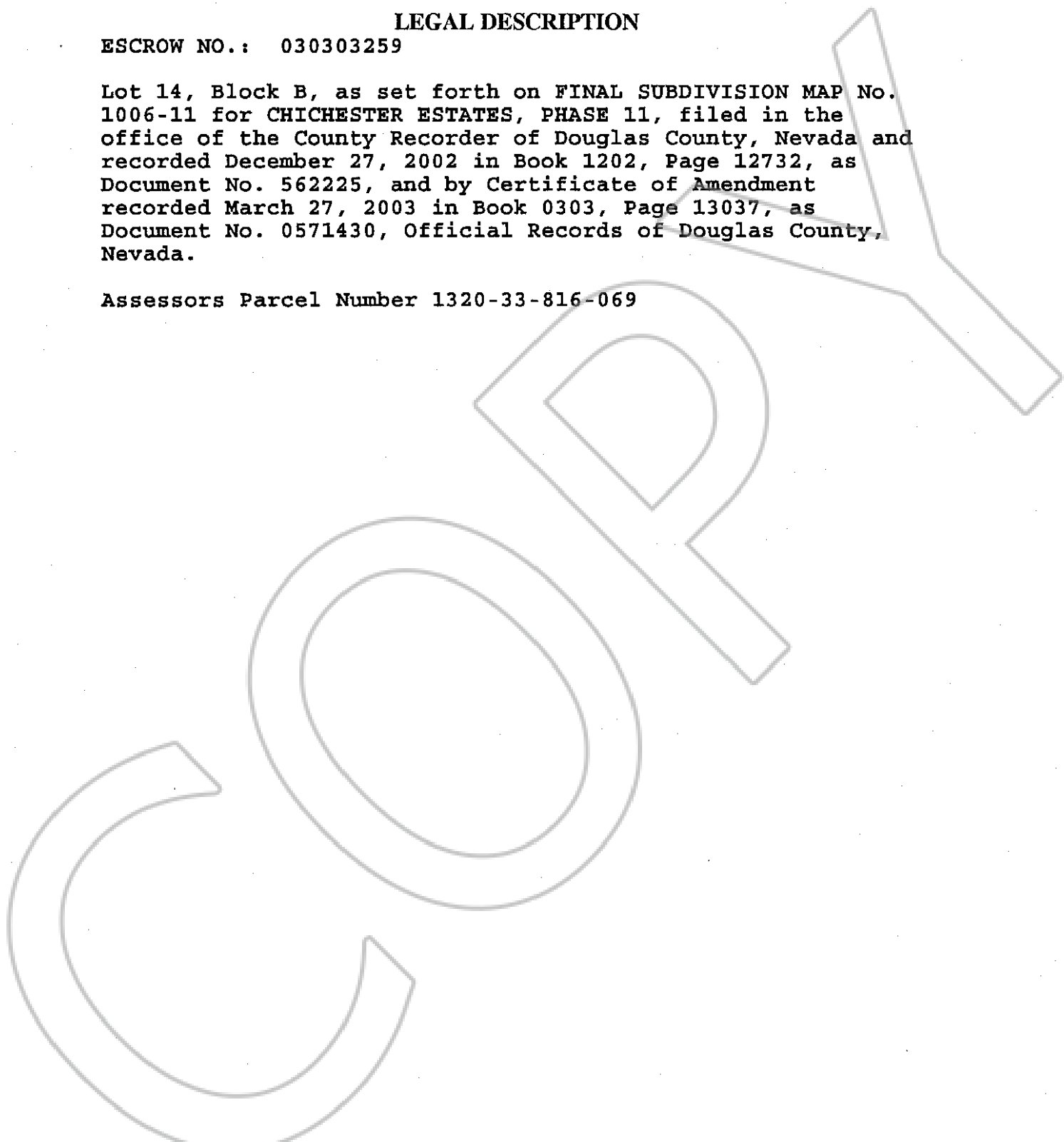

0597894

BK 1103 PG 11319