

REQUESTED BY
WESTERN TITLE COMPANY, INC.
IN OFFICIAL RECORDS OF
DOUGLAS CO., NEVADA

APN: 1420-07-610-040
RPTT \$778.05 Full Value Full Value less liens

2003 NOV 25 PM 3:19

WERNER CHRISTEN
RECORDER

16 PAID 18 DEPUTY

WHEN RECORDED MAIL TO:

Name PAUL B. GIBBS
Street P.O. BOX 204
Address
City,State BELLEVUE, ID 83313
Zip

MAIL TAX STATEMENTS TO:

Name PAUL B. GIBBS
Street P.O. BOX 204
Address
City,State BELLEVUE, ID 83313
Zip
Order 00089194-201- KLS
No.

(SPACE ABOVE THIS LINE FOR RECORDERS USE)

GRANT, BARGAIN AND SALE DEED

THIS INDENTURE WITNESSETH: That

FOR A VALUABLE CONSIDERATION, receipt of which is hereby acknowledged, J. ALAN WHITE and CARALEE WHITE, HUSBAND AND WIFE AS JOINT TENANTS do(es) hereby GRANT(s) BARGAIN SELL and CONVEY to PAUL B. GIBBS and L. EARLENE GIBBS, husband and wife as joint tenants.,

and to the heirs and assigns of such Grantee forever, all the following real property situated in the County of ~~Carson City~~ State of Nevada bounded and described as follows:
DOUGLAS

See Exhibit A attached hereto and made a part hereof.

TOGETHER with all tenements, hereditaments and appurtenances, if any, thereto belonging or appertaining, and any reversions, remainders, rents, issues or profits thereof.

Dated: November 14, 2003

0597916

BK1103PG11495

J. Alan White
J. ALAN WHITE

Caralee White
CARALEE WHITE

STATE OF NEVADA

COUNTY OF Douglas } ss

This instrument was acknowledged before me on
November 17, 2003

by J. Alan White & Caralee White

Kathy Swain
Notary Public



0597916

BK1103PG11496

Exhibit A

All that real property situate in the County of Douglas, State of Nevada, described as follows:

Lot 23, in Block B, of the final map of SUNRIDGE HEIGHTS PHASE 1, a Planned Unit Development, filed for record in the office of the County Recorder of Douglas County, State of Nevada, on June 11, 1993, as Document No. 309550.

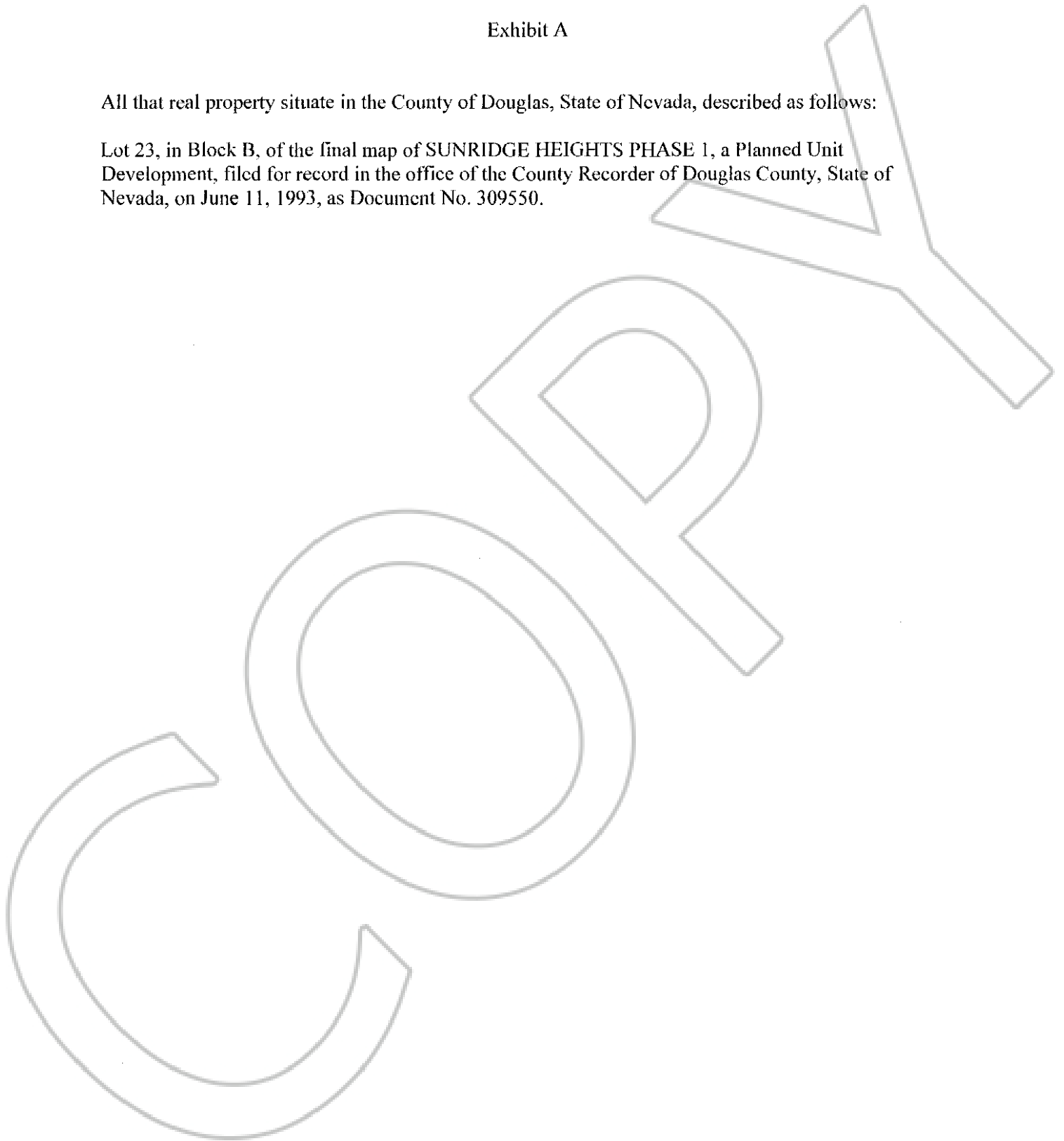

0597916

BK1103PG11497