

A.P.N. # 1420-28-811-037

R.P.T.T.S. 858.00

ESCROW NO. 03093222

RECORDING REQUESTED BY:
STEWART TITLE COMPANY

MAIL TAX STATEMENTS TO:
KIM VAN PELT
1771 VENICE DRIVE
SO. LAKE TAHOE, CA 96150

WHEN RECORDED MAIL TO:
KIM VAN PELT
1771 VENICE DRIVE
SO. LAKE TAHOE, CA 96150

030504224

REQUESTED BY
Stewart Title of Douglas County
IN OFFICIAL RECORDS OF
DOUGLAS CO., NEVADA

2003 DEC -4 AM 11:06

WERNER CHRISTEN
RECORDER

\$16⁰⁰ PAID BC DEPUTY

(Space Above for Recorder's Use Only)

GRANT, BARGAIN, SALE DEED

THIS INDENTURE WITNESSETH: That **LORRE M. ST. GERMAINE, AN UNMARRIED WOMAN**

in consideration of \$10.00, the receipt of which is hereby acknowledged, does hereby Grant, Bargain Sell and Convey to **KIM VAN PELT AND DOROTHY GRACE VAN PELT, HUSBAND AND WIFE AS JOINT TENANTS**

and to the heirs and assigns of such Grantee forever, all that real property situated in the **unincorporated area** County of **DOUGLAS** State of Nevada, bounded and described as:

SEE EXHIBIT "A" ATTACHED HERETO AND MADE A PART HEREOF

Together with all and singular the tenements, hereditaments and appurtenances thereunto belonging or in anywise appertaining, and any reversions, remainders, rents, issues or profits thereof.

DATE: **November 23, 2003**



LORRE M. ST. GERMAINE

STATE OF _____ }
 } ss.
COUNTY OF _____ }

This instrument was acknowledged before me on _____,
by **LORRE M. ST. GERMAINE**

Signature _____

Notary Public (One inch margin on all sides of document for Recorder's Use Only)

SEE ATTACHED
CALIFORNIA ALL PURPOSE
ACKNOWLEDGEMENT

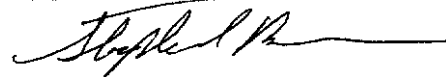

0598640

BK1203PG01798

**EXHIBIT "A"
LEGAL DESCRIPTION**

Order No.: 030504204

The land referred to herein is situated in the State of Nevada,
County of Douglas, described as follows:

Lot 9, as shown on the map of SARATOGA HEIGHTS UNIT NO. 1,
filed in the Office of the County Recorder of Douglas
County, Nevada, on May 15, 1961, as Document No. 17827.

Assessor's Parcel No. 1420-28-811-037

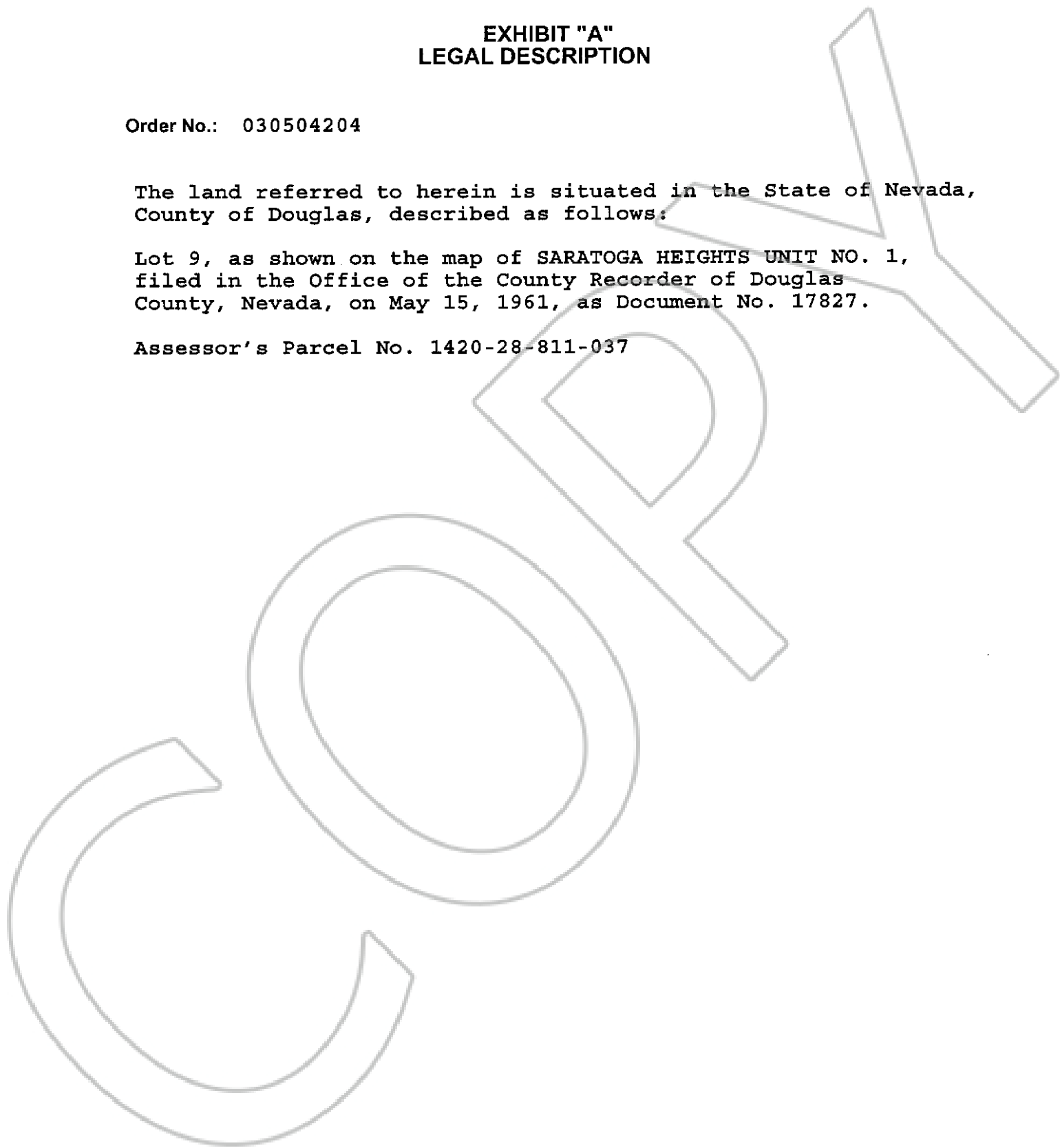

0598640
BK1203PG01799

CALIFORNIA ALL-PURPOSE ACKNOWLEDGMENT

State of California }
County of SAN DIEGO } ss.

On NOV 26 2003 before me, Stephen I. Bierman, Notary Public
Date Name and Title of Officer (e.g., "Jane Doe, Notary Public")
personally appeared LORRIE M. ST. GERMAIN
Name(s) of Signer(s)

personally known to me
 proved to me on the basis of satisfactory evidence



to be the person(s) whose name(s) is/are subscribed to the within instrument and acknowledged to me that he/she/they executed the same in his/her/their authorized capacity(ies), and that by his/her/their signature(s) on the instrument the person(s), or the entity upon behalf of which the person(s) acted, executed the instrument.

WITNESS my hand and official seal.

Stephen I. Bierman
Signature of Notary Public

OPTIONAL

Though the information below is not required by law, it may prove valuable to persons relying on the document and could prevent fraudulent removal and reattachment of this form to another document.

Description of Attached Document

Title or Type of Document: GRANT BARGAIN, SALE DEED
Document Date: NOV 26, 2003 Number of Pages: 1
Signer(s) Other Than Named Above: _____

Capacity(ies) Claimed by Signer

Signer's Name: LORRIE M. ST. GERMAIN

- Individual
- Corporate Officer — Title(s): _____
- Partner — Limited General
- Attorney-in-Fact
- Trustee
- Guardian or Conservator
- Other: _____

Signer Is Representing: SELF

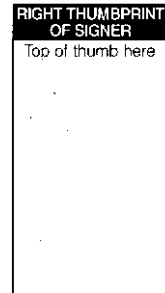

0598640

BK1203PG01800