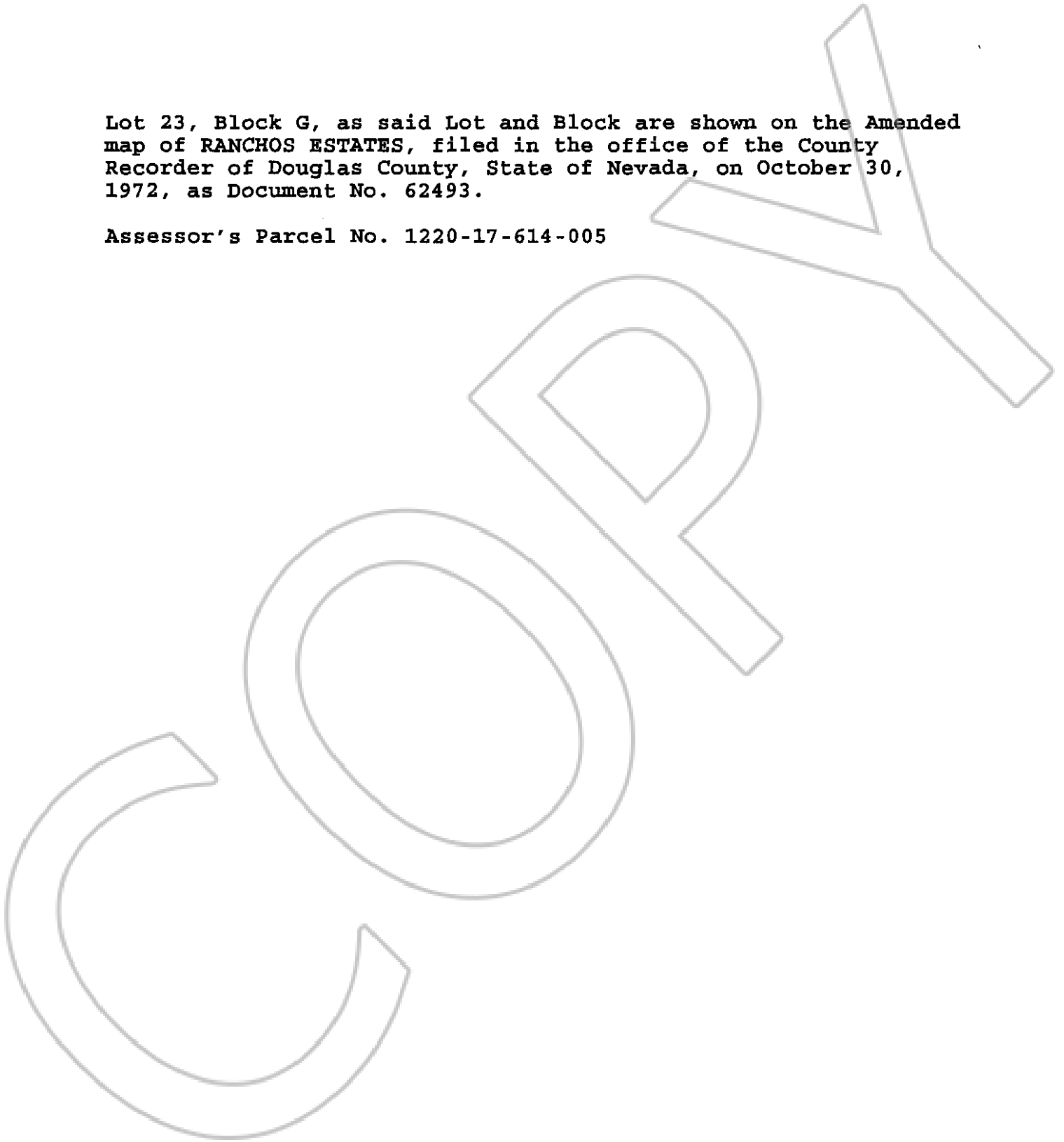

EXHIBIT "A"

Lot 23, Block G, as said Lot and Block are shown on the Amended map of RANCHOS ESTATES, filed in the office of the County Recorder of Douglas County, State of Nevada, on October 30, 1972, as Document No. 62493.

Assessor's Parcel No. 1220-17-614-005



0599051

BK1203PG03805