

15-

A.P.N. # 1219-23-001-013

R.P.T.T. \$ #6

ESCROW NO. 030803935

RECORDING REQUESTED BY:
STEWART TITLE COMPANY

MAIL TAX STATEMENTS TO:
GRANTEE
419 DINO COURT
GARDNERVILLE, NV 89460

WHEN RECORDED MAIL TO:
GRANTEE
419 DINO COURT
GARDNERVILLE, NV 89460

REQUESTED BY
Virginia L Goldberg
IN OFFICIAL RECORDS OF
DOUGLAS CO., NEVADA

2003 DEC 11 AM 11:42

WERNER CHRISTEN
RECORDER

\$ 15.00 PAID KJ DEPUTY

(Space Above for Recorder's Use Only)

GRANT, BARGAIN, SALE DEED

THIS INDENTURE WITNESSETH: That **VIRGINIA L. GOLDBERG, A WIDOW**

in consideration of \$10.00, the receipt of which is hereby acknowledged, does hereby Grant, Bargain Sell and Convey to **VIRGINIA L. GOLDBERG, VIRGINIA L. GOLDBERG, TRUSTEE OF THE VIRGINIA L. GOLDBERG TRUST DATED OCTOBER 17, 2001**

and to the heirs and assigns of such Grantee forever, all that real property situated in the **City of GARDNERVILLE** County of **DOUGLAS** State of Nevada, bounded and described as:
SEE EXHIBIT "A" ATTACHED HERETO AND MADE A PART HEREOF

Together with all and singular the tenements, hereditaments and appurtenances thereunto belonging or in anywise appertaining, and any reversions, remainders, rents, issues or profits thereof.

DATE: **November 17, 2003**

Virginia L Goldberg
VIRGINIA L. GOLDBERG

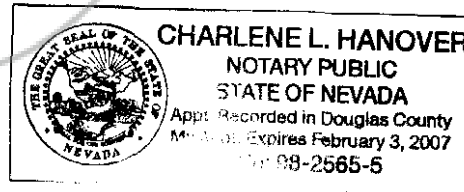

STATE OF NEVADA }
COUNTY OF DOUGLAS } SS.

This instrument was acknowledged before me on 11/21/2003,
by VIRGINIA L. GOLDBERG

Signature *Charlene L Hanover*

Notary Public (One inch margin on all sides of document for Recorder's Use Only)

0599265

BK1203PG04852

EXHIBIT "A"

LEGAL DESCRIPTION

ESCROW NO.: 030803935

**Being a Portion of the Northwest 1/4 of Section 23,
Township 12 North, Range 19 East, M.D.B. & M., further
described as:**

**Parcel 4-B of Parcel Map No. 2 for Dino Natali, filed for
Record in the Office of the County Recorder of Douglas
County, State of Nevada on December 19, 1986, in Book 1286,
Page 2677, as Document No. 147128.**

ASSESSOR'S PARCEL NO. 1219-23-001-013

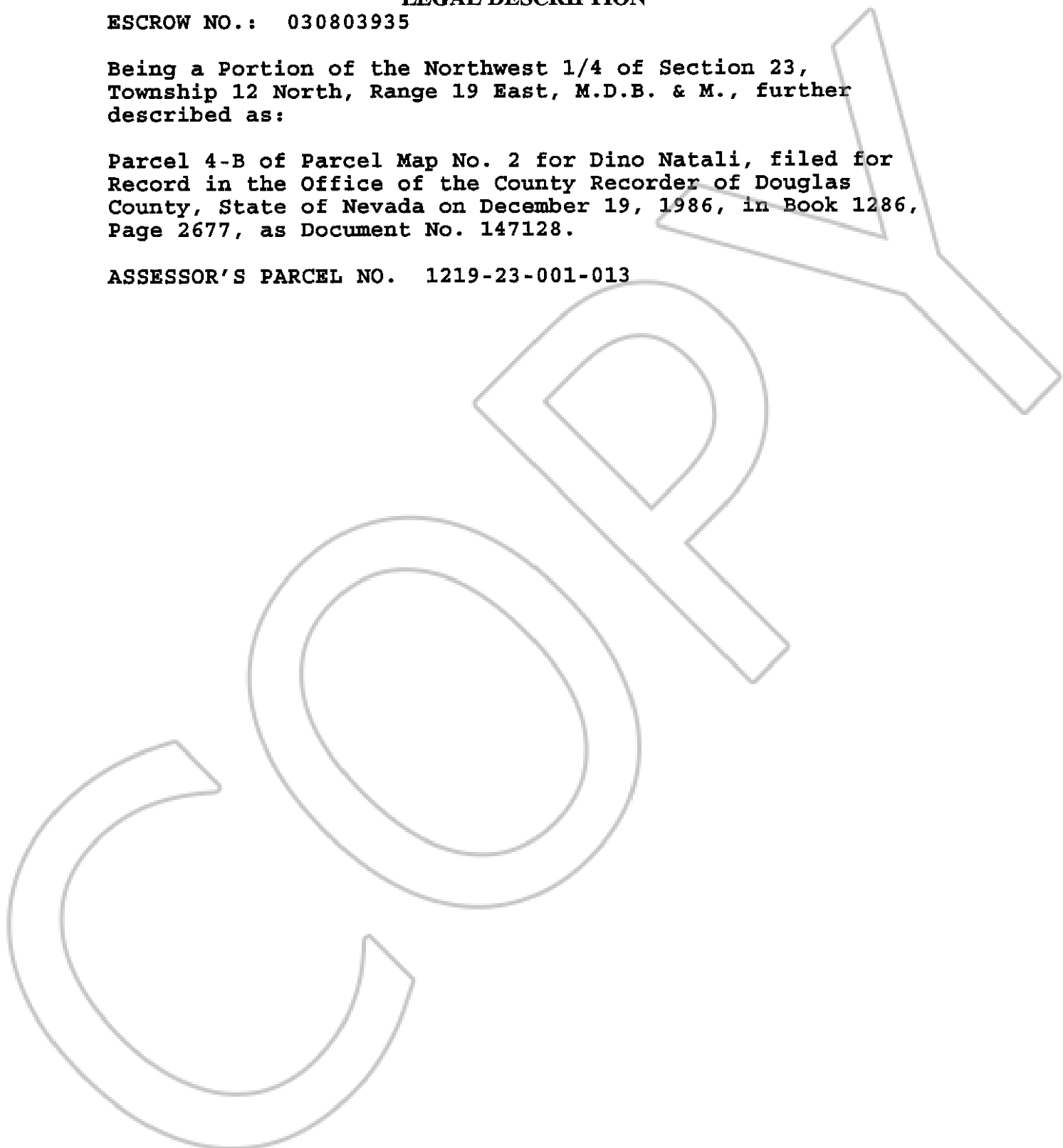

0599265

BK 1203 PG 04853