

A.P.N. # 1320.33 816.057

ESCROW NO. 030301724  
RECORDING REQUESTED BY:  
STEWART TITLE COMPANY

WHEN RECORDED MAIL TO:  
WEST RIDGE HOMES, INC.  
1528 HWY 395, #215  
GARDNERVILLE, NV 89410

REQUESTED BY  
**Stewart Title of Douglas County**  
IN OFFICIAL RECORDS OF  
DOUGLAS CO., NEVADA

2003 DEC 12 PM 4:20

WERNER CHRISTEN  
RECORDER

\$15.00 PAID kg DEPUTY

(Space Above for Recorder's Use Only)

### NOTICE OF COMPLETION

Must be filed within 15 days after completion NRS 108.228  
Individual or Corporation

**NOTICE IS HEREBY GIVEN:**

1. That the interest or estate stated in paragraph 3 below in the real property hereinafter described is owned by the following:

NAME	STREET AND NO.	CITY	STATE
WEST RIDGE HOMES, INC.	//1528 HWY 395, #215//	GARDNERVILLE, NV	89410,

(If more than one owner of the interest stated, the name and address of each must be inserted.)

- That the full name and address of the owner of said interest or estate, if there is only one owner, and the full names and addresses of all the co-owners who own said interest or estate as joint tenants, as tenants in common or otherwise, if there is more than one owner, are set forth in the preceding paragraph.
- That the nature of the title of said owner, or if more than one, then of said owner and co-owners is: In Fee.

(If other than fee, strike out "In Fee" and insert for example "purchase under contract of purchase" or "lessee.")

4. That on the 9 day of DEC. 2003 a work of improvement on the real property hereinafter described was completed.

5. That the name of the original contractor, if any, for such work of improvement was WEST RIDGE HOMES, INC.

(If no contractor for work of improvement as a whole, insert "No Contractor.")

That the real property herein referred to is situated in the City of \_\_\_\_\_  
County of DOUGLAS, State of Nevada and is described as follows:

See Exhibit "A" attached hereto and by reference made a part hereof for complete legal description.  
Commonly known as: 1421 CHITERN CT.  
GARDNERVILLE

Read this note before signing. If more than one owner, only one need sign, personally or by an agent. The owner or agent who signs the notice itself must also sign the verification below.

WEST RIDGE HOMES, INC.  
BY [Signature]  
PETER M. BEEKHOF, JR.

### VERIFICATION

The undersigned being duly sworn, says: That he/she/they read the foregoing notice and knows the contents thereof and the same is true of his/her/their own knowledge.

STATE OF NEVADA }  
  } ss.  
COUNTY OF DOUGLAS }

BY [Signature]  
PETER M. BEEKHOF, JR.

This instrument was acknowledged before me on 12.12.03  
by, PETER M. BEEKHOF, JR.

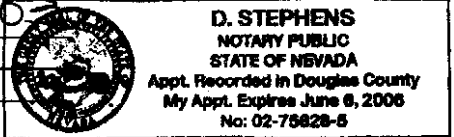

Signature [Signature]  
Notary Public (One inch Margin on all sides of document for Recorder's Use ONLY)

0599487

BK1203PG06159

**EXHIBIT "A"**

**LEGAL DESCRIPTION**

**ESCROW NO.: 030301726**

Lot 26, Block B, as set forth on FINAL SUBDIVISION MAP No. 1006-11 for CHICHESTER ESTATES, PHASE 11, filed in the office of the County Recorder of Douglas County, Nevada and recorded December 27, 2002 in Book 1202, Page 12732, as Document No. 562225, and by Certificate of Amendment recorded March 27, 2003 in Book 0303, Page 13037, as Document No. 0571430.

**ASSESSOR'S PARCEL NO. 1320-33-816-057**

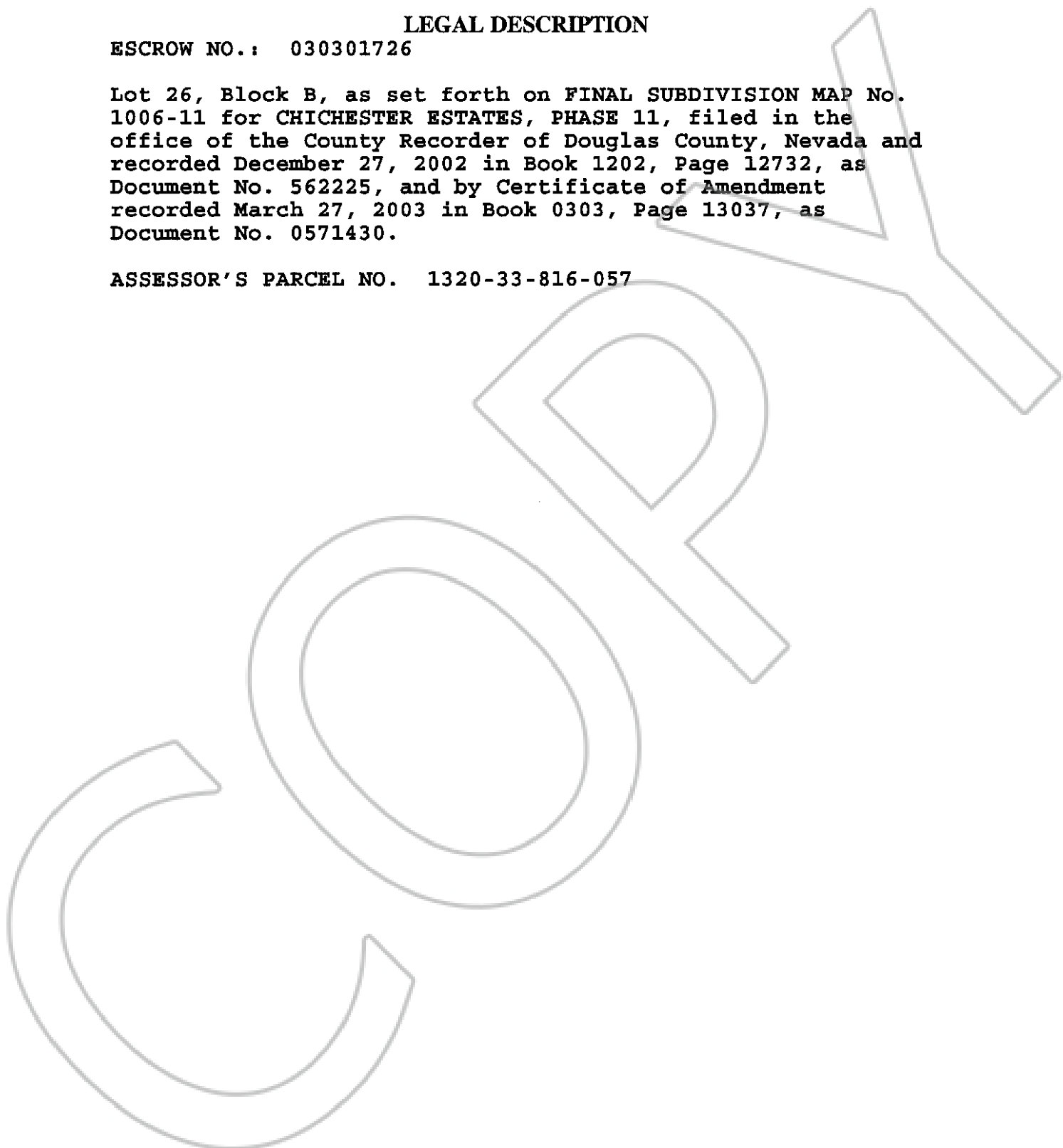

0599487

BK1203PG06160