

A.P.N. # 1320-33-816-057

R.P.T.T. \$ 924.30

ESCROW NO. 030301726

RECORDING REQUESTED BY:
STEWART TITLE COMPANY
MAIL TAX STATEMENTS TO:
SAME AS BELOW

WHEN RECORDED MAIL TO:
MR. & MRS. FRIENDSHUH
1421 CHILTERN COURT
GARDNERVILLE, NV 89410

REQUESTED BY
Stewart Title of Douglas County
IN OFFICIAL RECORDS OF
DOUGLAS CO., NEVADA

2003 DEC 12 PM 4:21

WERNER CHRISTEN
RECORDER

\$ 15.00 PAID KJ DEPUTY

(Space above for Recorder's Use Only)

CORPORATION
GRANT, BARGAIN, SALE DEED

THIS INDENTURE WITNESSETH: That
WEST RIDGE HOMES, INC., A NEVADA CORPORATION

in consideration of \$10.00, the receipt of which is hereby acknowledged, does hereby Grant, Bargain Sell and Convey to
DOUGLAS B. FRIENDSHUH and CYNTHIA L. FRIENDSHUH, husband and wife as joint tenants
and to the heirs and assigns of such Grantee forever, all that real property situated in the
County of **DOUGLAS** State of Nevada,
bounded and described as follows:

SEE EXHIBIT "A" ATTACHED HERETO AND MADE A PART HEREOF

Together with all and singular the tenements, hereditaments and appurtenances thereunto belonging or in anywise appertaining, and any reversions, remainders, rents, issues or profits thereof.

DATE: **December 05, 2003**

WEST RIDGE HOMES, INC.
A NEVADA CORPORATION

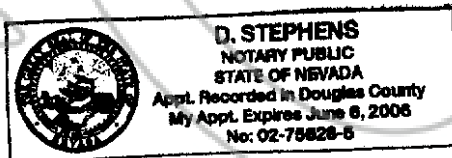

BY: *Peter M. Beekhof, Jr.*
PETER M. BEEKHOF, JR.
PRESIDENT

BY: _____

STATE OF ~~36709~~ NEVADA }

COUNTY OF DOUGLAS } ss.

This instrument was acknowledged before me on 12-12-03,
by PETER M. BEEKHOF, JR.

Signature *D. Stephens*
Notary Public (One Inch Margin on all sides of Document for Recorder's Use Only)

0599488

BK1203PG06161

EXHIBIT "A"

LEGAL DESCRIPTION

ESCROW NO.: 030301726

Lot 26, Block B, as set forth on FINAL SUBDIVISION MAP No. 1006-11 for CHICHESTER ESTATES, PHASE 11, filed in the office of the County Recorder of Douglas County, Nevada and recorded December 27, 2002 in Book 1202, Page 12732, as Document No. 562225, and by Certificate of Amendment recorded March 27, 2003 in Book 0303, Page 13037, as Document No. 0571430.

ASSESSOR'S PARCEL NO. 1320-33-816-057

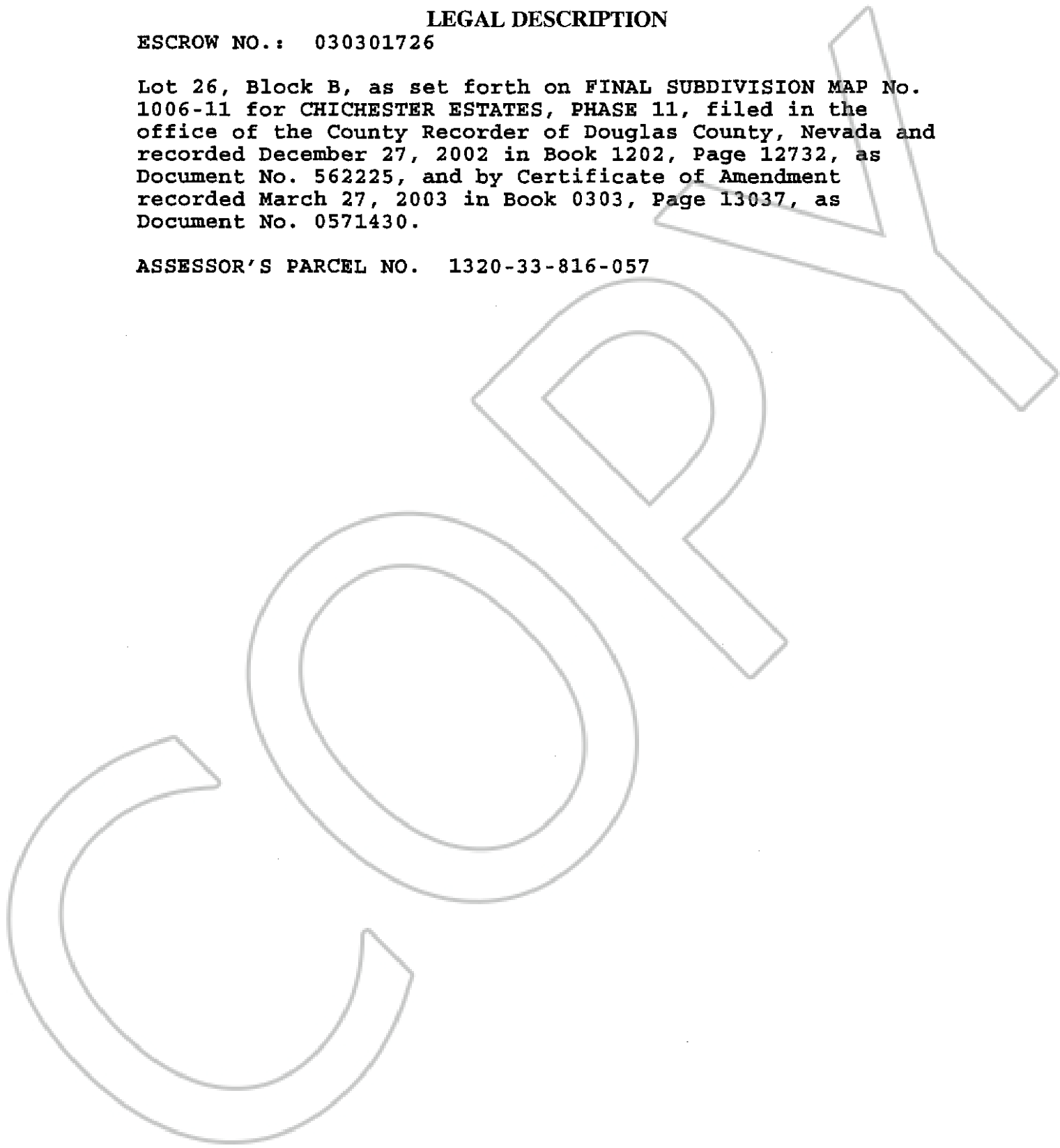

0599488

BK1203PG06162