



**EXHIBIT "A"**

**LEGAL DESCRIPTION**

ESCROW NO.: 030704153

Lot 2, in Block A, as set forth on the certain map of HERITAGE SQUARE TOWNHOUSES, filed for record in the office of the County Recorder of Douglas County, Nevada, on April 8, 1986, in Book 486 at Page 793, as Document No. 133158.

Assessors Parcel No. 1320-33-411-002

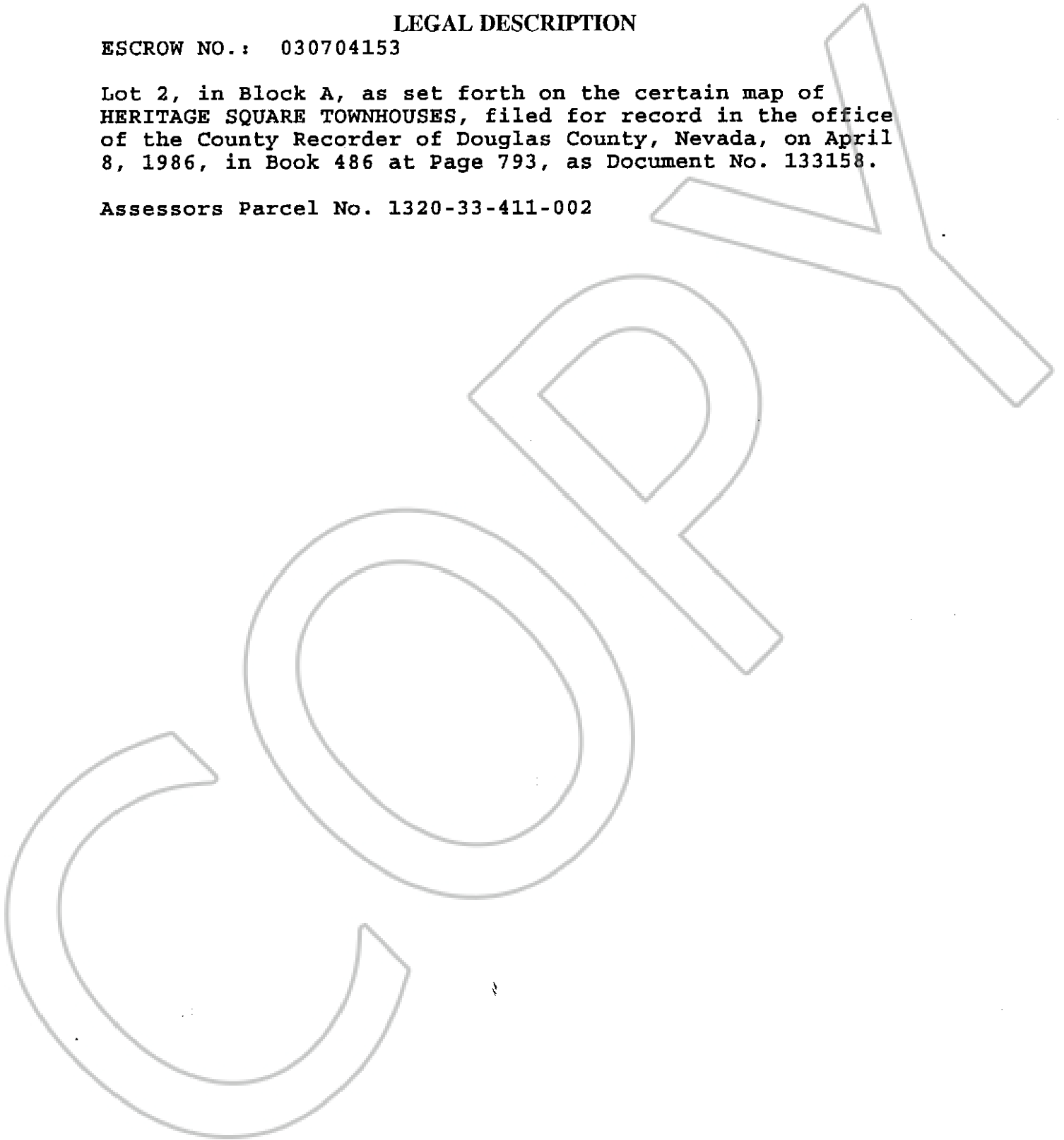

0599599

BK 1203 PG 06678