

EXHIBIT "A"

LEGAL DESCRIPTION

ESCROW NO.: 030303564

Lot 21, in Block C, as shown on the Final Map of Valley Vista Estates 1, Phase 1B filed for record in the office of the Douglas County Recorder on June 2, 1995 in Book 695, Page 389 as Document No. 363386, Official Records.

Assessors Parcel No. 1420-07-113-012

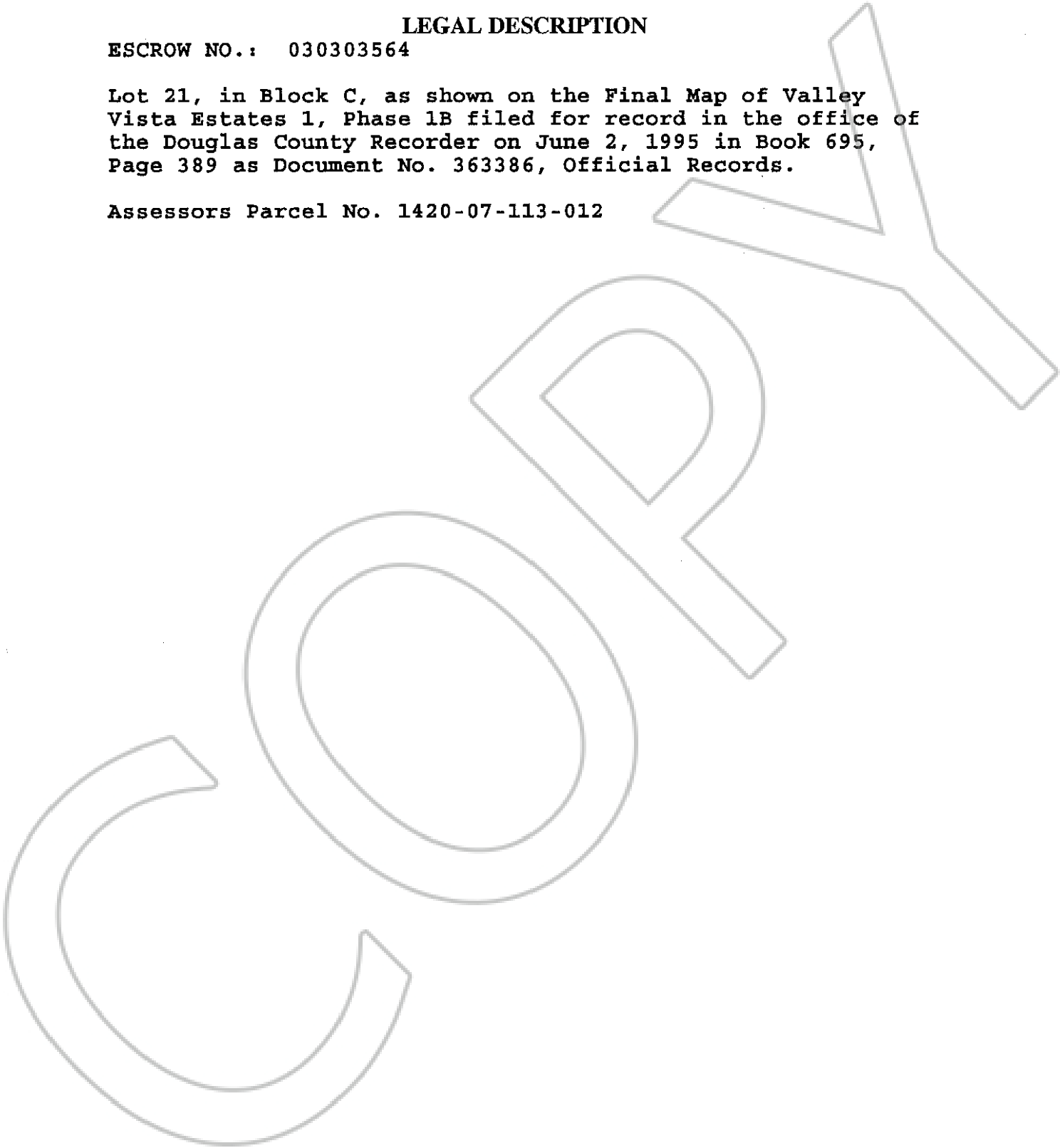

0599789

BK 1203 PG 07736