

15  
A.P.N. # 1420-07-112-037 &  
1420-07-112-037  
R.P.T.T. \$ 0 #6  
ESCROW NO. \_\_\_\_\_  
RECORDING REQUESTED BY: \_\_\_\_\_

MAIL TAX STATEMENTS TO:  
**GRANTEE**  
876 VALLEY CREST DR.  
CARSON CITY, NV. 89705

✓ WHEN RECORDED MAIL TO:  
**GRANTEE**  
876 VALLEY CREST DR.  
CARSON CITY, NV. 89705

REQUESTED BY  
Shigeo Sumida  
IN OFFICIAL RECORDS OF  
DOUGLAS CO. NEVADA

2003 DEC 18 AM 10:42

WERNER CHRISTEN  
RECORDER  
\$15.00 PAID K2 DEPUTY

(Space Above for Recorder's Use Only)

### GRANT, BARGAIN, SALE DEED

THIS INDENTURE WITNESSETH: That **SHIGEO SUMIDA**, a married man as his sole and separate property

in consideration of \$10.00, the receipt of which is hereby acknowledged, does hereby Grant, Bargain Sell and Convey to **SHIGEO SUMIDA, TRUSTEE AND ANNE SUMIDA, TRUSTEE OF THE SHIGEO SUMIDA AND ANNE SUMIDA LIVING TRUST DATED JULY 8, 1998**

and to the heirs and assigns of such Grantee forever, all that real property situated in the **unincorporated area** County of **DOUGLAS** State of Nevada, bounded and described as:

**SEE EXHIBIT "A" ATTACHED HERETO AND MADE A PART HEREOF**

Together with all and singular the tenements, hereditaments and appurtenances thereunto belonging or in anywise appertaining, and any reversions, remainders, rents, issues or profits thereof.

DATE: **December 18, 2003**

*Shigeo Sumida*  
**SHIGEO SUMIDA**

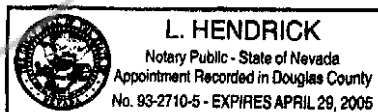

STATE OF NEVADA )  
  ) ss.  
COUNTY OF DOUGLAS )

This instrument was acknowledged before me on 12-18-03  
by SHIGEO SUMIDA

Signature *L. Hendrick*  
Notary Public (One inch margin on all sides of document for Recorder's Use Only)

0599843

BK1203PG08065

**EXHIBIT "A"**

**LEGAL DESCRIPTION**

Lot B6, in Block B, as shown on the Final Map #1007-3 of VALLEY VISTA ESTATES, PHASE 2, recorded in the office of the Douglas County Recorder, State of Nevada, on August 29, 1997, in Book 897, at Page 6072, as Document No. 420670, Official Records.

Assessor's Parcel No. 1420-07-112-037

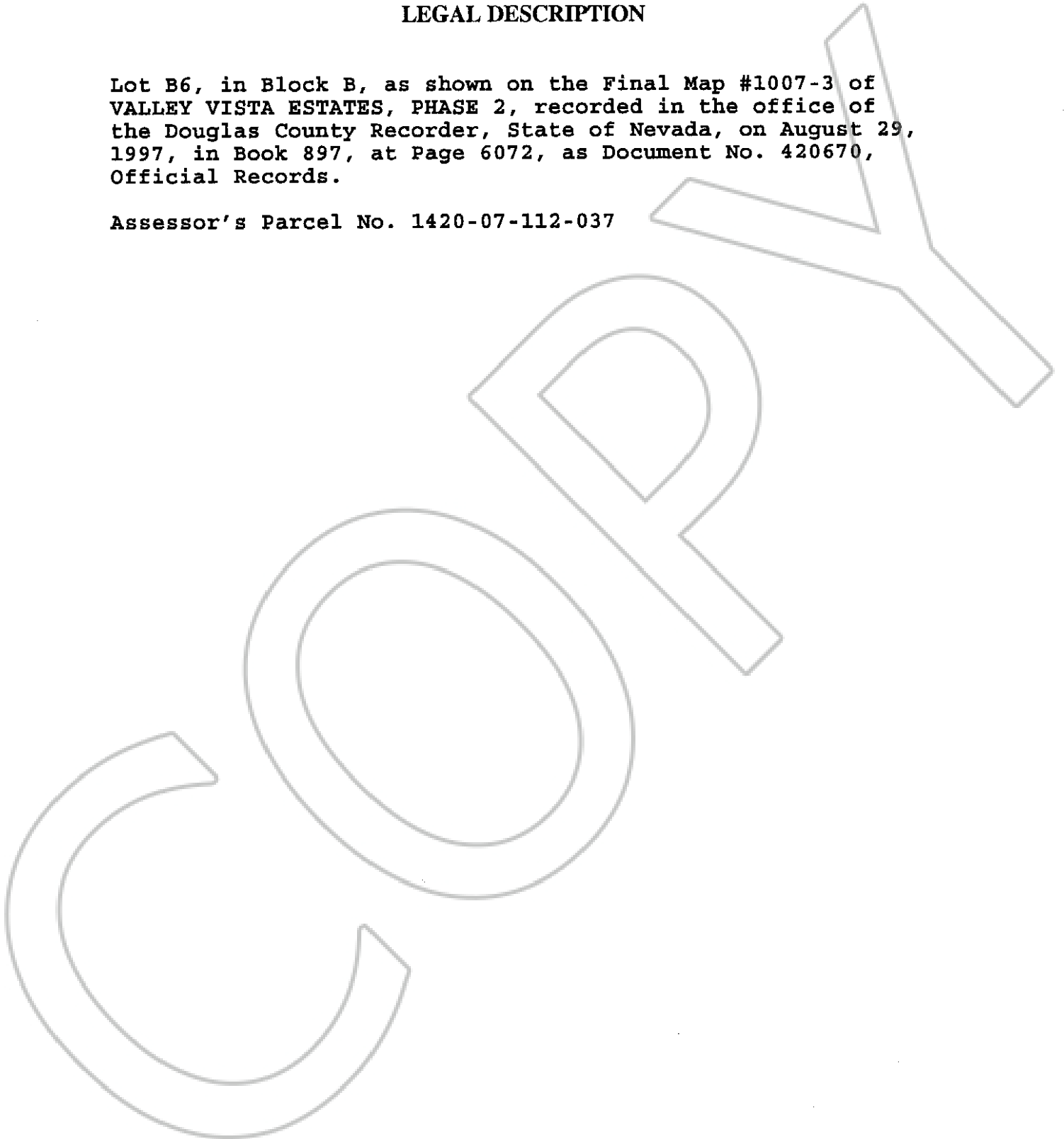

0599843

BK1203PG08066