



**EXHIBIT "A"**

**LEGAL DESCRIPTION**

ESCROW NO.: 030104130

Lot 207, as shown on the Final Map of WILDHORSE UNIT 6, A PLANNED UNIT DEVELOPMENT, filed for record in the office of the County Recorder of Douglas County, State of Nevada, on March 15, 1994 in Book 394, Page 2741, as Document No. 332336.

Assessors Parcel No. 1420-33-312-024

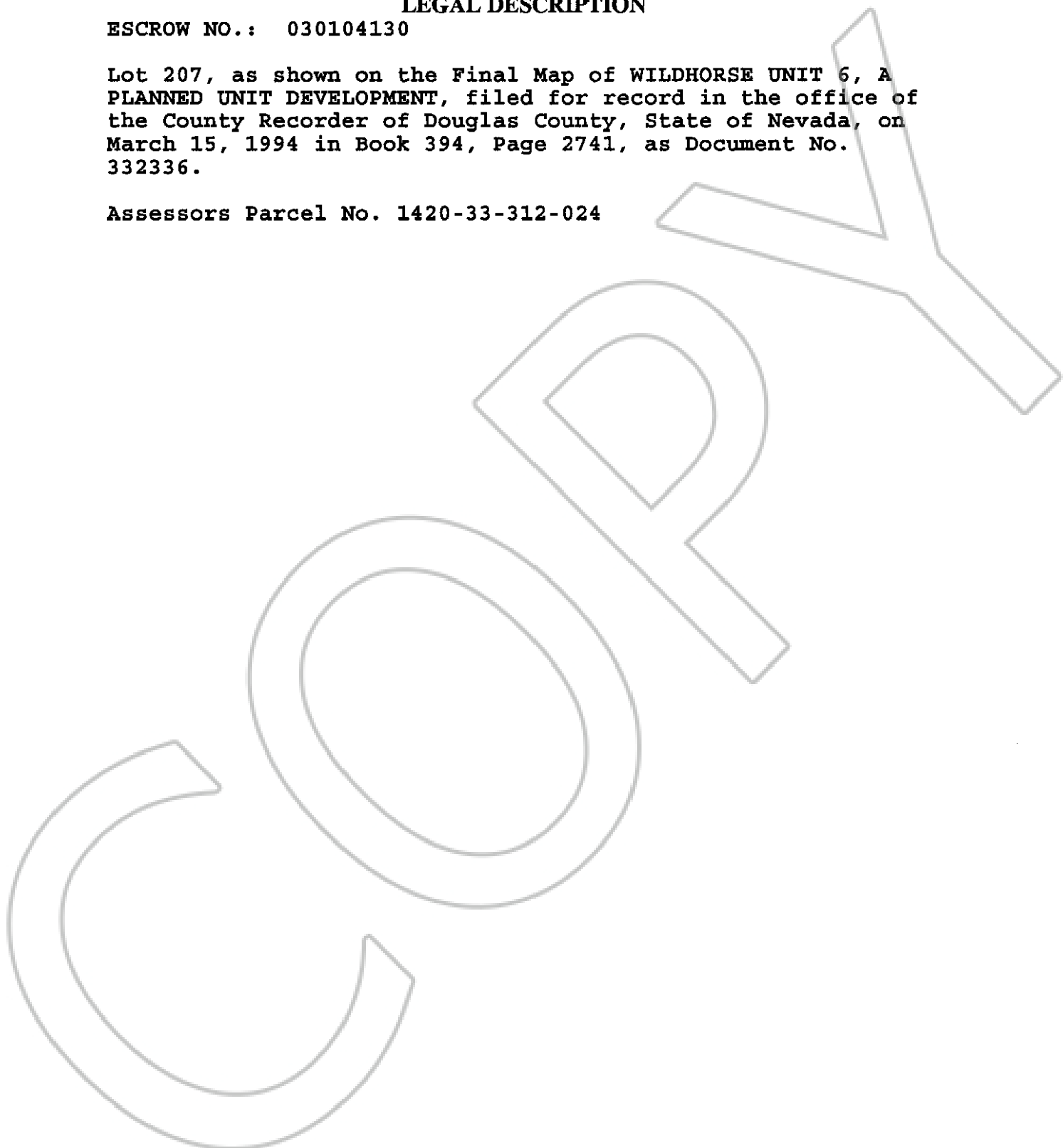

0600086

BK1203PG09213