

REQUESTED BY  
**Stewart Title of Douglas County**

IN OFFICIAL RECORDS OF  
DOUGLAS CO., NEVADA

2003 DEC 19 PM 2: 26

WERNER CHRISTEN  
RECORDER

\$16<sup>00</sup> PAID *KJ* DEPUTY

APN: 1320-33-816-048

ESCROW NO.: 030303372

RECORDING REQUESTED BY:  
STEWART TITLE COMPANY

WHEN RECORDED, MAIL TO:

SYNCON HOMES  
2221 MERIDIAN BLVD., STE. A  
MINDEN, NV 89423

### NOTICE OF COMPLETION

Must be filed within 15 days after completion NRS 108.228  
Individual or Corporation

**NOTICE IS HEREBY GIVEN:**

1. That the interest or estate stated in paragraph 3 below in the real property hereinafter described is owned by the following:

NAME	STREET AND NO.	CITY	STATE
<u>SYNCON HOMES</u>	<u>2221 MERIDIAN BL., #A</u>	<u>MINDEN</u>	<u>NV 89423</u>

2. That the full name and address of the owner of said interest or estate, if there is only one owner, and the full names and addresses of all the co-owners who own said interest or estate as joint tenants, as tenants in common or otherwise, if there is more than one owner, are set forth in the preceding paragraph.

3. That the nature of the title of said owner, or if more than one, then of said owner and co-owners is: In Fee.

4. That on the 12 day of December 2003, a work of improvement on the real property herein after described was completed.

5. That the name of the original contractor, if any, for such work of improvements was: \_\_\_\_\_

SYNCON HOMES

That the real property herein referred to is situated in the unincorporated area, County of DOUGLAS State of Nevada and is described as follows:

**SEE EXHIBIT "A" ATTACHED HERETO AND BY REFERENCE MADE A PART HEREOF  
FOR COMPLETE LEGAL DESCRIPTION.**

COMMONLY KNOWN AS: 1423 CHEDDINGTON CIRCLE, GARDNERVILLE, NV

SYNCON HOMES

BY: Andrew W Mitchell Pres  
ANDREW W. MITCHELL  
PRESIDENT

(CONTINUED ON NEXT PAGE)

(ONE INCH BORDER AROUND DOCUMENT FOR RECORDER'S USE ONLY)

0600090

BK1203PG09248

VERIFICATION

The undersigned being duly sworn, says: That he/she/they read the foregoing notice and knows the contents thereof and the same is true of his/her /their own knowledge:

STATE OF NEVADA )  
 )SS.  
COUNTY OF DOUGLAS )

SYNCON HOMES

BY: Andrew W. Mitchell Pres  
ANDREW W. MITCHELL  
PRESIDENT

This instrument was acknowledged before me on 12-17-03  
by ANDREW W. MITCHELL.

Signature: [Signature]  
Notary Public

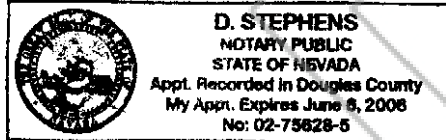

COPIES

0600090

BK1203PG09249

**EXHIBIT "A"**

**LEGAL DESCRIPTION**

**ESCROW NO.: 030303372**

Lot 35, Block B, as set forth on FINAL SUBDIVISION MAP No. 1006-11 for CHICHESTER ESTATES, PHASE 11, filed in the office of the County Recorder of Douglas County, Nevada and recorded December 27, 2002 in Book 1202, Page 12732, as Document No. 562225, and by Certificate of Amendment recorded March 27, 2003 in Book 0303, Page 13037, as Document No. 0571430, Official Records of Douglas County, Nevada.

Assessors Parcel Number 1320-33-816-048,

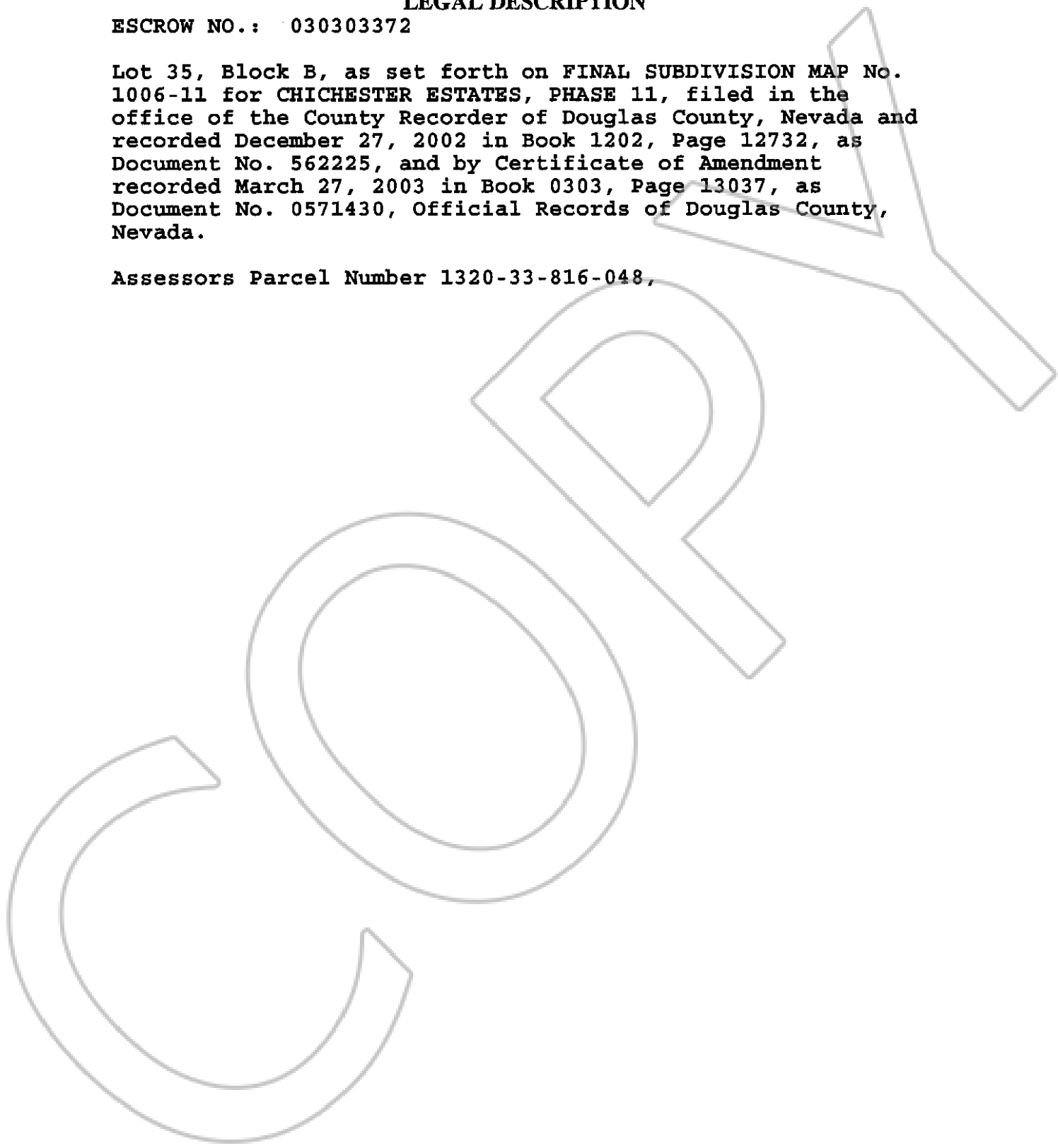

0600090  
BK1203PG09250