

A.P.N. # 1320-33-816-048

R.P.T.T. \$ 957.45

ESCROW NO. 030303372

RECORDING REQUESTED BY:
STEWART TITLE COMPANY
MAIL TAX STATEMENTS TO:
SAME AS BELOW

WHEN RECORDED MAIL TO:
BARBARA A. REYNOLDS
1066 KEITH AVE.

BERKELEY, CA 94708

REQUESTED BY
Stewart Title of Douglas County
IN OFFICIAL RECORDS OF
DOUGLAS CO., NEVADA

2003 DEC 19 PM 2:26

WERNER CHRISTEN
RECORDER

\$15⁰⁰ PAID *Kj* DEPUTY

(Space above for Recorder's Use Only)

**CORPORATION
GRANT, BARGAIN, SALE DEED**

THIS INDENTURE WITNESSETH: That
SYNCON HOMES, a Nevada Corporation

in consideration of \$10.00, the receipt of which is hereby acknowledged, does hereby Grant, Bargain Sell
and Convey to
BARBARA A. REYNOLDS, AN UNMARRIED WOMAN

and to the heirs and assigns of such Grantee forever, all that real property situated in the
County of **DOUGLAS** State of Nevada,

bounded and described as follows:

SEE EXHIBIT "A" ATTACHED HERETO AND MADE A PART HEREOF

Together with all and singular the tenements, hereditaments and appurtenances thereunto belonging or in
anywise appertaining, and any reversions, remainders, rents, issues or profits thereof.

DATE: **December 11, 2003**

**SYNCON HOMES
A NEVADA CORPORATION**



J.M. COOLEY
NOTARY PUBLIC
STATE OF NEVADA
Appt. Recorded in Carson City
My Appt. Expires February 15, 2005
No: 97-0092-3

BY: *Andrew W. Mitchell Pres.*
ANDREW W. MITCHELL
PRESIDENT

BY: _____

STATE OF Nevada }
COUNTY OF DOUGLAS } ss.

This instrument was acknowledged before me on 12-15-03
by ANDREW W. MITCHELL

Signature *J.M. Cooley*
Notary Public (One Inch Margin on all sides of Document for Recorder's Use Only)

0600091

BK1203PG09251

EXHIBIT "A"

LEGAL DESCRIPTION

ESCROW NO.: 030303372

Lot 35, Block B, as set forth on FINAL SUBDIVISION MAP No. 1006-11 for CHICHESTER ESTATES, PHASE 11, filed in the office of the County Recorder of Douglas County, Nevada and recorded December 27, 2002 in Book 1202, Page 12732, as Document No. 562225, and by Certificate of Amendment recorded March 27, 2003 in Book 0303, Page 13037, as Document No. 0571430, Official Records of Douglas County, Nevada.

Assessors Parcel Number 1320-33-816-048,

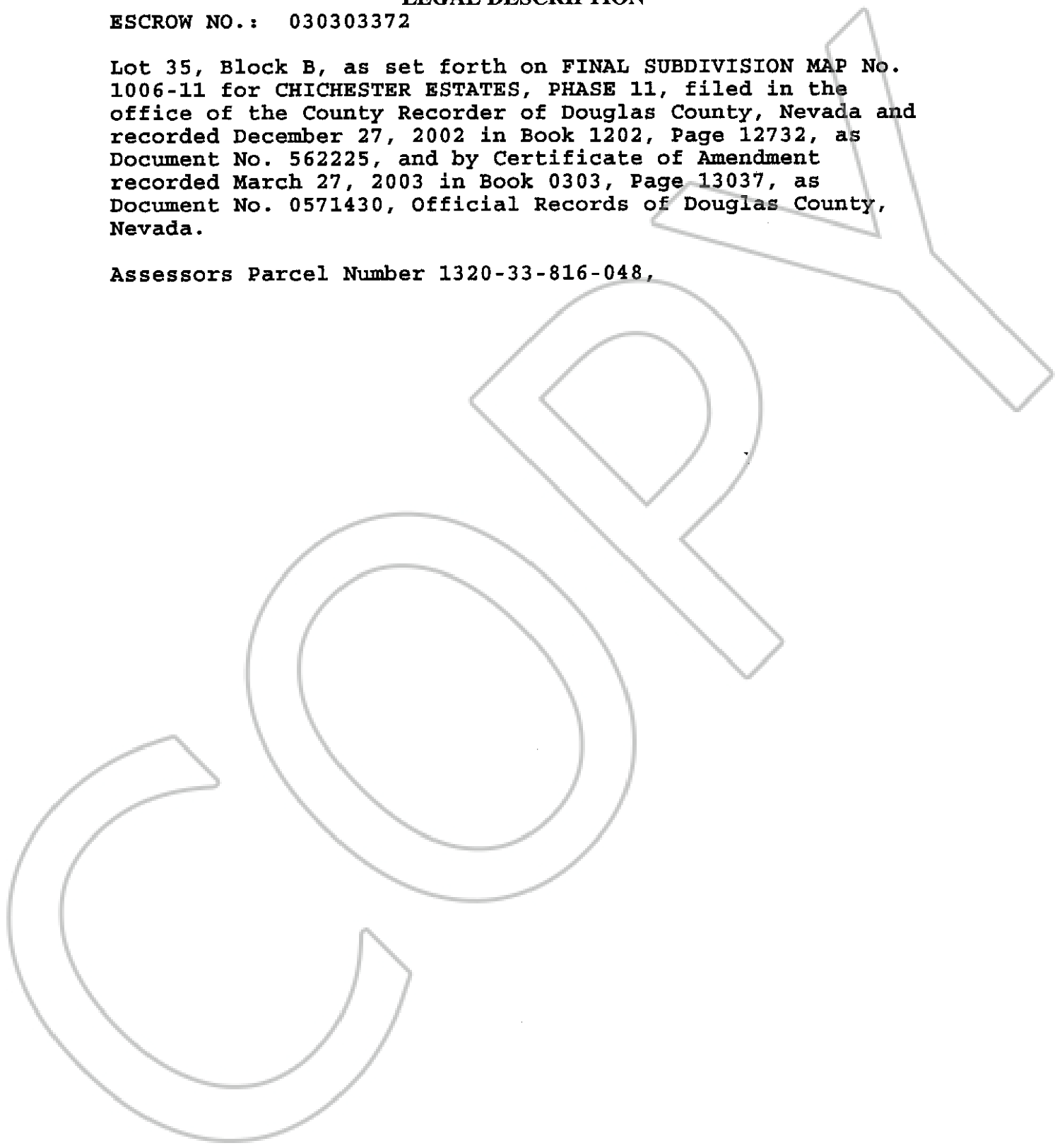

0600091

BK1203PG09252