

**EXHIBIT "A"
LEGAL DESCRIPTION**

Order No.: 030203731

The land referred to herein is situated in the State of Nevada,
County of Douglas, described as follows:

Lot 8, Block B, as shown on the Map of Belarra Subdivision
Unit 2-B, recorded January 11, 1978, as Document No. 16600,
Official Records of Douglas County, State of Nevada.

ASSESSOR'S PARCEL NO. 1320-30-818-001

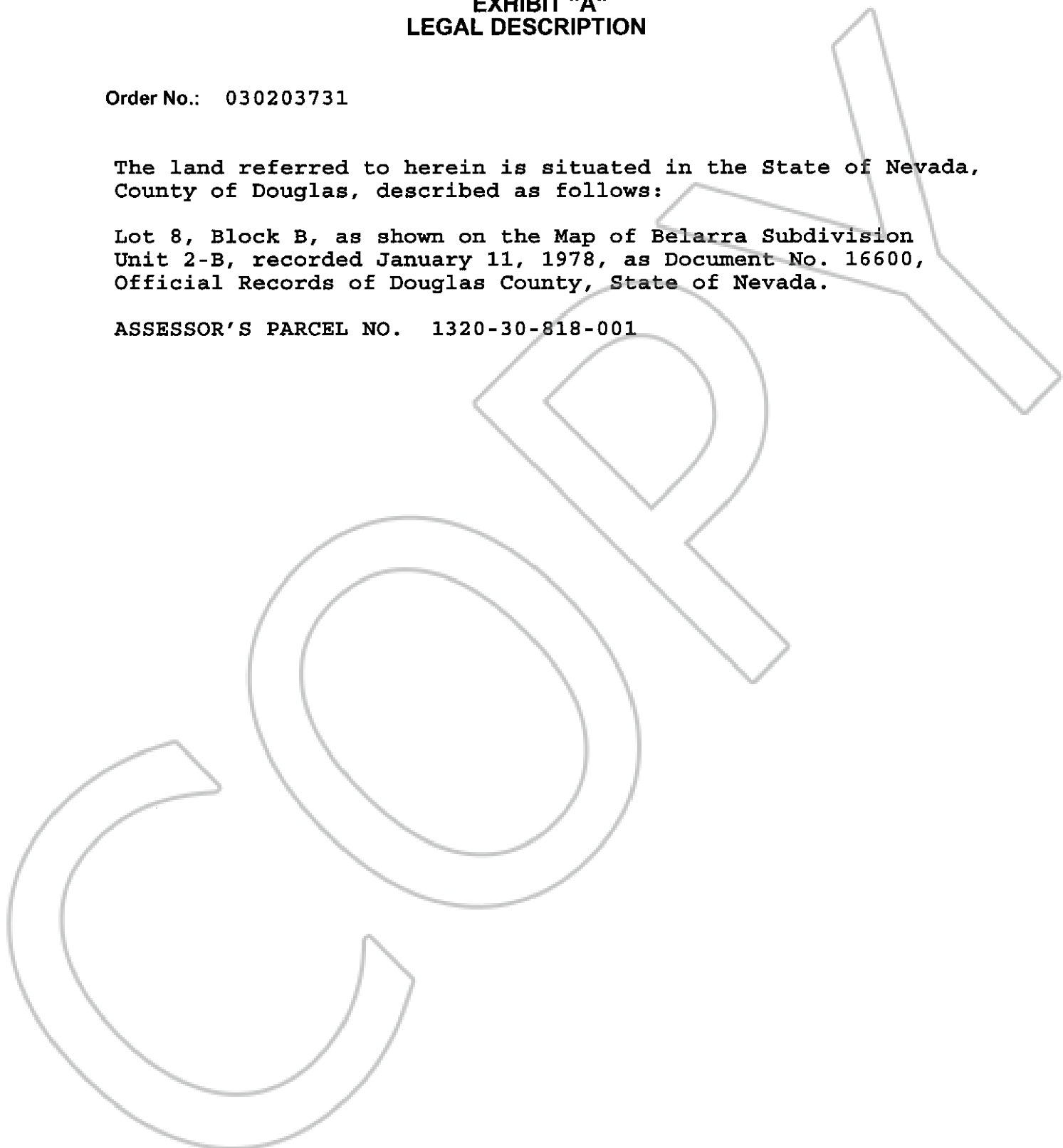

0600097

BK1203PG09303