

A.P.N. # 1320-33-816-053

R.P.T.T. \$ 867.75

ESCROW NO. 030303267

RECORDING REQUESTED BY:  
**STEWART TITLE COMPANY**  
MAIL TAX STATEMENTS TO:  
**SAME AS BELOW**

WHEN RECORDED MAIL TO:  
**MR. & MRS. THEW**  
**1422 CHILTERN COURT**  
**GARDNERVILLE, NV 89410**

REQUESTED BY  
**Stewart Title of Douglas County**

IN OFFICIAL RECORDS OF  
DOUGLAS CO., NEVADA

2003 DEC 24 PM 1:33

WERNER CHRISTEN  
RECORDER

\$15<sup>00</sup> PAID *Kj* DEPUTY

(Space above for Recorder's Use Only)

**CORPORATION**  
**GRANT, BARGAIN, SALE DEED**

THIS INDENTURE WITNESSETH: That  
**WEST RIDGE HOMES, INC.,** a Nevada corporation

in consideration of \$10.00, the receipt of which is hereby acknowledged, docs hereby Grant, Bargain Sell and Convey to  
**CARL H. THEW and MARJORIE A. THEW, husband and wife as joint tenants**

and to the heirs and assigns of such Grantee forever, all that real property situated in the  
County of **DOUGLAS** State of Nevada,

bounded and described as follows:

**SEE EXHIBIT "A" ATTACHED HERETO AND MADE A PART HEREOF**

Together with all and singular the tenements, hereditaments and appurtenances thereunto belonging or in anywise appertaining, and any reversions, remainders, rents, issues or profits thereof.

DATE: **December 19, 2003**

**WEST RIDGE HOMES, INC.**  
**A NEVADA CORPORATION**

BY: *PMB*  
**PETER M. BEEKHOF, JR.**  
**PRESIDENT**

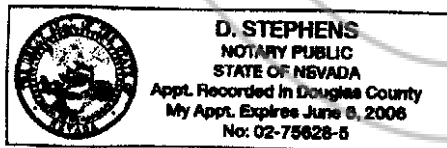

BY: \_\_\_\_\_

STATE OF Nevada }  
COUNTY OF DOUGLAS } ss.

This instrument was acknowledged before me on 12.24.03,  
by PETER M. BEEKHOF, JR.

Signature *[Signature]*  
Notary Public (One Inch Margin on all sides of Document for Recorder's Use Only)

0600569

BK1203PG11625

**EXHIBIT "A"**

**LEGAL DESCRIPTION**

**ESCROW NO.: 030303267**

Lot 30, Block B, as set forth on FINAL SUBDIVISION MAP No. 1006-11 for CHICHESTER ESTATES, PHASE 11, filed in the office of the County Recorder of Douglas County, Nevada and recorded December 27, 2002 in Book 1202, Page 12732, as Document No. 562225, and by Certificate of Amendment recorded March 27, 2003 in Book 0303, Page 13037, as Document No. 0571430.

**Assessors Parcel Number 1320-33-816-053**

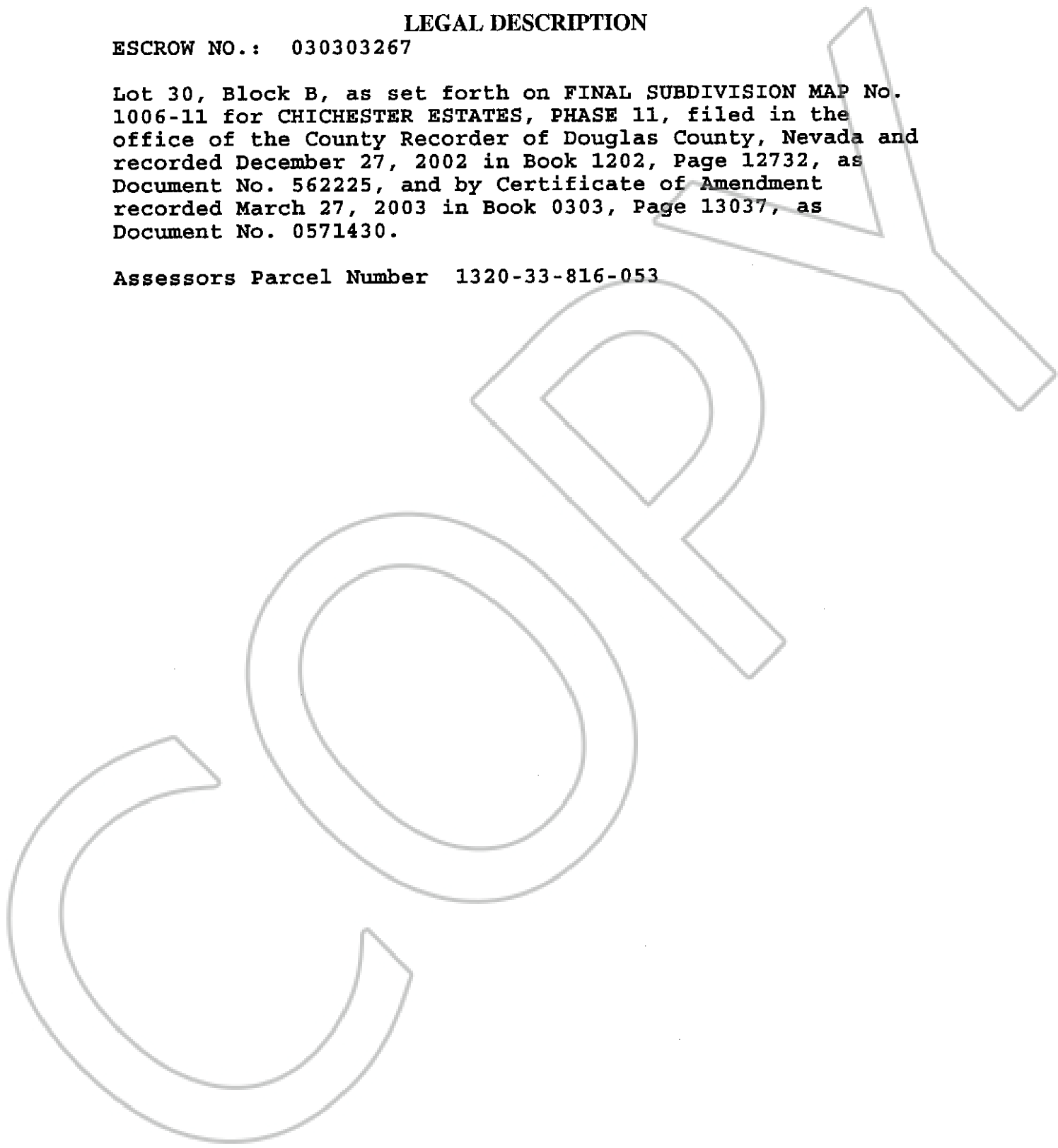

0600569

BK1203PG11626