

A.P.N. # 1220-22-210-073

R.P.T.T. \$ 0 ~~89~~

ESCROW NO. ~~8/8~~

RECORDING REQUESTED BY:
STEWART TITLE COMPANY

MAIL TAX STATEMENTS TO:
MARY KELSH
729 LASSEN WAY
GARDNERVILLE, NV 89460

WHEN RECORDED MAIL TO:
MARY KELSH
729 LASSEN WAY
GARDNERVILLE, NV 89460

REQUESTED BY

Stewart Title of Douglas County
IN OFFICIAL RECORDS OF
DOUGLAS CO., NEVADA

2003 DEC 29 PM 3:44

WERNER CHRISTEN
RECORDER

\$15.00 PAID *KJ* DEPUTY

(Space Above for Recorder's Use Only)

GRANT, BARGAIN, SALE DEED

THIS INDENTURE WITNESSETH: That **MARY H. KELSH, AN UNMARRIED WOMAN**

in consideration of \$10.00, the receipt of which is hereby acknowledged, does hereby Grant, Bargain Sell and Convey to **MARY H. KELSH, AN UNMARRIED WOMAN AND MARGARET HELWIG, A WIDOW AS JOINT TENANTS**

and to the heirs and assigns of such Grantee forever, all that real property situated in the **unincorporated area** County of **DOUGLAS** State of Nevada, bounded and described as:

SEE EXHIBIT "A" ATTACHED HERETO AND MADE A PART HEREOF

Together with all and singular the tenements, hereditaments and appurtenances thereunto belonging or in anywise appertaining, and any reversions, remainders, rents issues or profits thereof.

DATE: **December 23, 2003**

Mary H. Kelsh
MARY H. KELSH



STATE OF Nevada,
COUNTY OF Douglas, ss.

This instrument was acknowledged before me on 12/23/03
by **MARY H. KELSH**

Signature *Lori Mae Silva*
Notary Public (One inch margin on all sides of document for Recorder's Use Only)

0600738

BK 1203 PG 12575

EXHIBIT "A"

LEGAL DESCRIPTION

ESCROW NO.: 030201749

Lot 686, as shown on the official map of GARDNERVILLE RANCHOS
UNIT NO. 6, filed for record on May 29, 1973, in the office of
the County Recorder of Douglas County, Nevada as Document No.
66512.

Assessors Parcel No. 1220-22-210-073

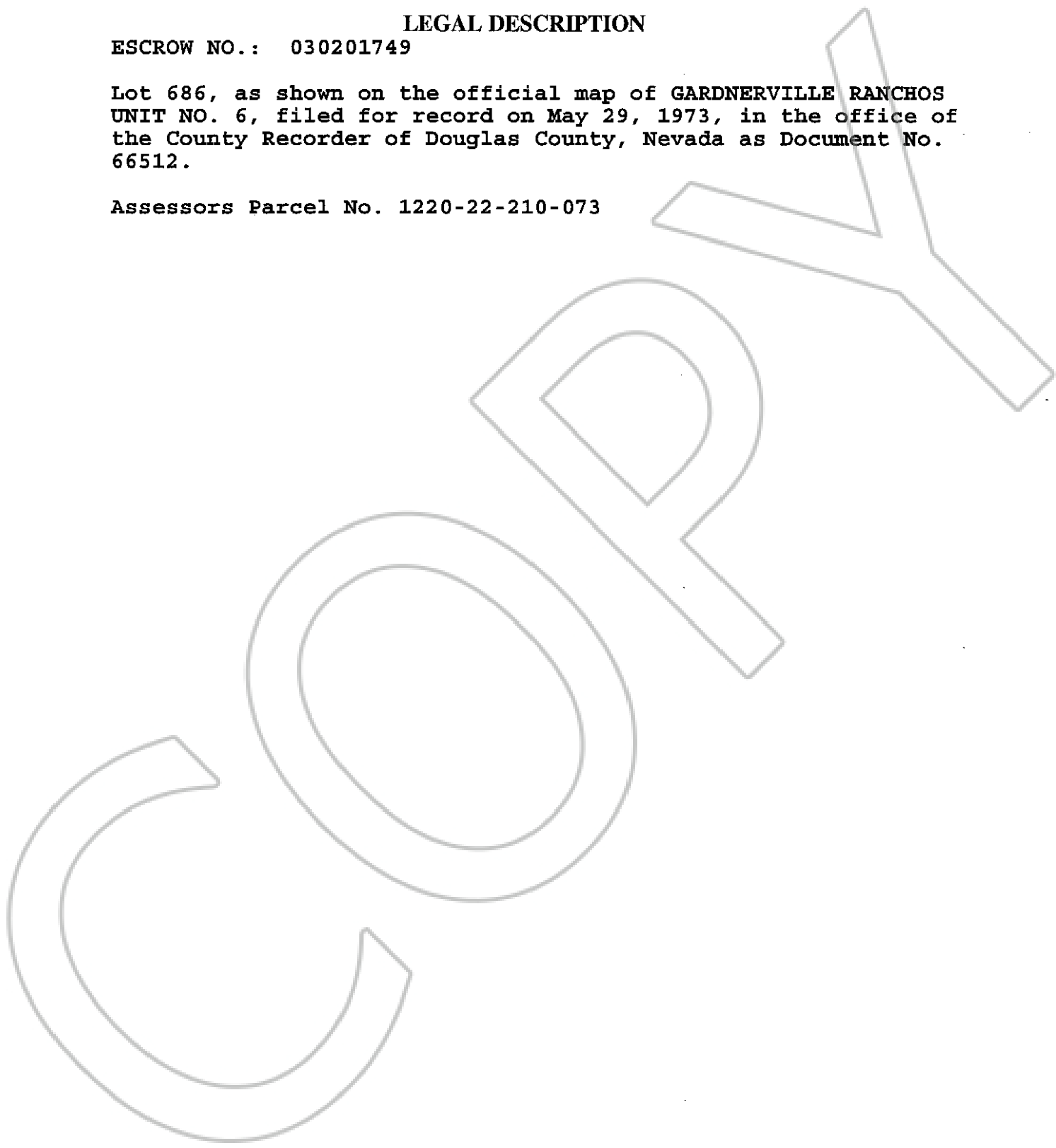

0600738

BK1203PG12576