

A.P.N. # 1420-34-410-005

R.P.T.T. \$ 0.15
ESCROW NO. 030803931

RECORDING REQUESTED BY:
STEWART TITLE COMPANY
MAIL TAX STATEMENTS TO:
SAME AS BELOW

WHEN RECORDED MAIL TO:
GRANTEE
2627 CLAPHAM LANE
MINDEN, NV 89423

REQUESTED BY
Stewart Title of Douglas County
IN OFFICIAL RECORDS OF
DOUGLAS CO., NEVADA

2003 DEC 31 PM 2:08

WERNER CHRISTEN
RECORDER

\$ 15.00 PAID K. J. DEPUTY

(Space Above for Recorder's Use Only)

GRANT, BARGAIN, SALE DEED

THIS INDENTURE WITNESSETH: That **GLENN A. NICHOLSON, HUSBAND OF THE GRANTEE HEREIN**

in consideration of \$10.00, the receipt of which is hereby acknowledged, does hereby Grant, Bargain Sell and Convey to **JULIE A. NICHOLSON, A MARRIED WOMAN AS HER SOLE AND SEPARATE PROPERTY**

and to the heirs and assigns of such Grantee forever, all that real property situated in the County of **Douglas** State of Nevada, bounded and described as :

SEE EXHIBIT "A" ATTACHED HERETO AND MADE A PART HEREOF

IT IS THE EXPRESS INTENT OF THE GRANTOR, BEING THE SPOUSE OF THE GRANTEE, TO CONVEY ALL RIGHT, TITLE AND INTEREST OF THE GRANTOR, COMMUNITY OR OTHERWISE, IN AND TO THE HEREIN DESCRIBED PROPERTY TO THE GRANTEE AS GRANTEE'S SOLE AND SEPARATE PROPERTY.

Together with all and singular the tenements, hereditaments and appurtenances thereunto belonging or in anyway appertaining, and any reversions, remainders, rents, issues or profits thereof.

DATE: **November 19, 2003**

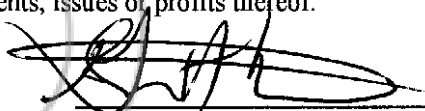

GLENN A. NICHOLSON

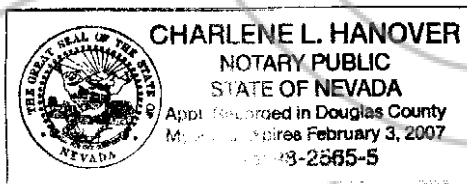

STATE OF NEVADA }
 } ss.
COUNTY OF DOUGLAS }

This instrument was acknowledged before me on 11/25/2003,
by, GLENN A. NICHOLSON

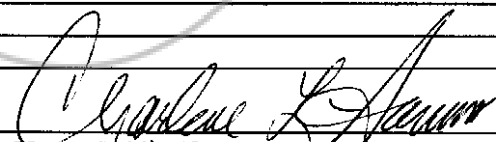
Signature 
Notary Public (One Inch Margin on all sides of Document for Recorder's Use Only)

0601001
BK 1203 PG 13998

EXHIBIT "A"

LEGAL DESCRIPTION

ESCROW NO.: 030803931

**Lot 17, Block 1, as shown on the Map of the ARTEMISIA
RE-SUBDIVISION, filed in the office of the County Recorder
April 23, 1962, as Document No. 19909, Official Records of
Douglas County, State of Nevada.**

Assessor's Parcel No. 1420-34-410-005.

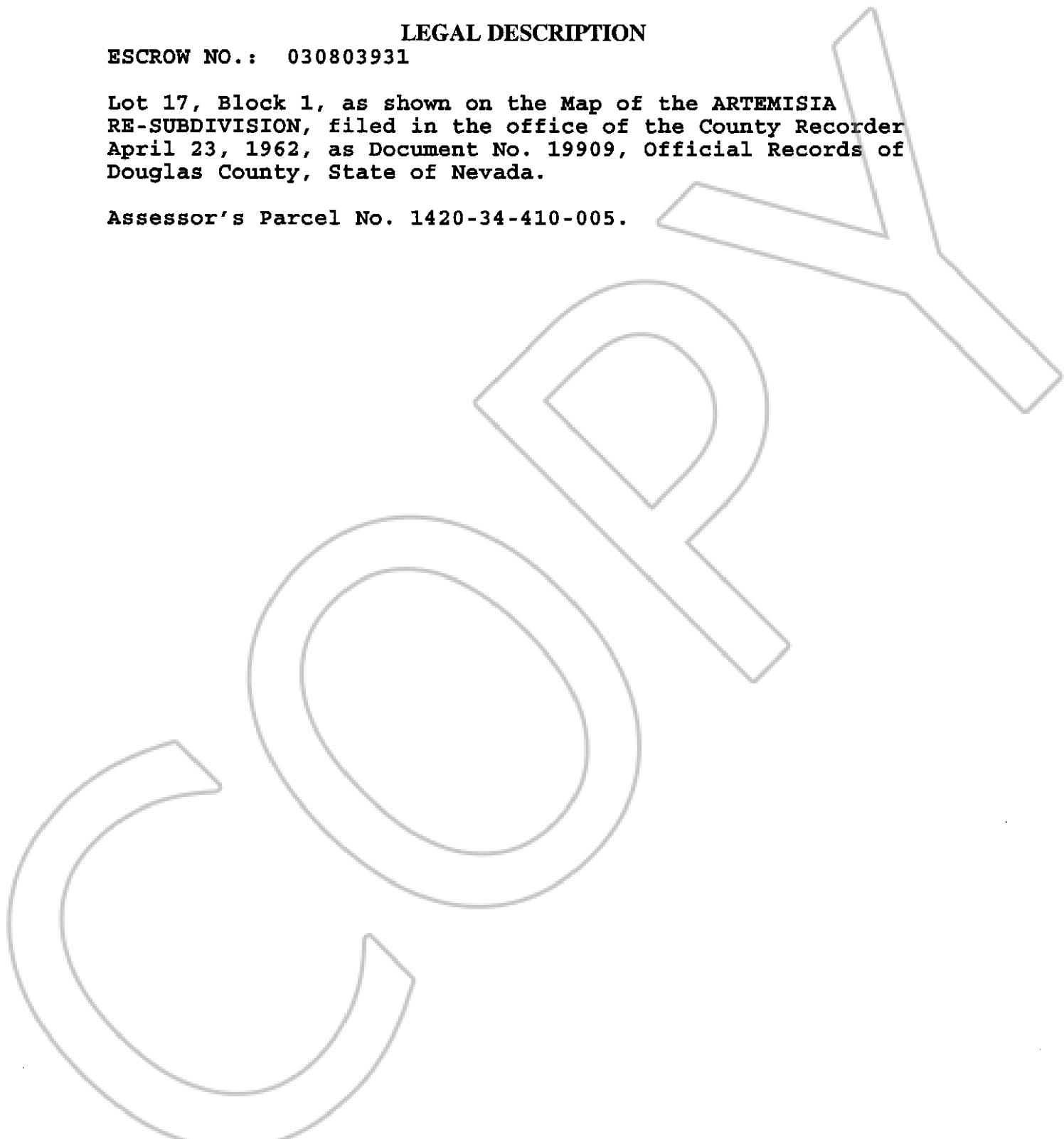

0601001

BK1203PG13999