

RECORDING REQUESTED BY
Santa Barbara Bank & Trust
Attn: Loan Support
P O Box 60734
Santa Barbara, Ca 93160-0734

AND WHEN RECORDED MAIL TO:
SYNCON HOMES
A NEVADA CORPORATION
2221 MERIDIAN BLVD, STE A
MINDEN NV 89423

REQUESTED BY
Stewart Title of Douglas County
IN OFFICIAL RECORDS OF
DOUGLAS CO., NEVADA

2004 JAN 14 PM 3:26

WERNER CHRISTEN
RECORDER

s/16⁵⁰ PAID. *KJ* DEPUTY

SPACE ABOVE THIS LINE FOR RECORDER'S USE

PARTIAL RECONVEYANCE

Recon #03-1103-07

PACIFIC CAPITAL COMMERCIAL MORTGAGE, INC, a California corporation, trustee under Deed of Trust executed by Syncon Homes Inc., a Nevada Corporation, Trustor, dated June 13, 2002 and recorded as Instrument No. 545000, on June 18, 2002 in Book 602, Page 5683-5692 and modified July 27, 2002, recorded as instrument No. 0548907, Book 0802, Pages 1882-1884 on August 7, 2002 having been requested in writing, by the holder of the obligation secured by said Deed of Trust, to reconvey the estate granted to Trustee under said Deed of Trust, in and to herein described property, and said Deed of Trust and note or notes secured thereby having been presented for endorsement, hereby reconveys, without warranty, to the person or persons legally entitled thereof, all estate now held by it thereunder in and to that property situated in Douglas County, State of Nevada described as follows:

See legal description attached hereto and made part hereof marked Exhibit "A"

November 25, 2003

PCB SERVICE CORPORATION,
a California corporation
(formerly Pacific Capital Commercial Mortgage, Inc.)

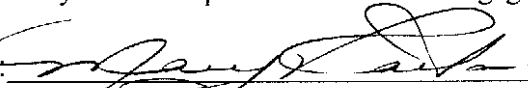
By: 
Mary Patton

By: 
Robin Whatley

Title/Escrow Company: Stewart Title of Douglas Co., Attn: Jeanne Cooley, 1650 N. Lucerne, Minden, NV 89423
Order No.: unknown Lot 38 Block H #030303232
Loan No.: 24621-28649 & 24621-28926

0602030

BK0104PG04198

CALIFORNIA ALL-PURPOSE ACKNOWLEDGMENT

State of California
 County of Santa Barbara

On Dec. 10th, 2003 before me, Gary Geise Notary Public,
DATE NAME, TITLE OF OFFICER-E.G., "JANE DOE, NOTARY PUBLIC"

personally appeared Mary Patton and Robin Whatley
NAME(S) OF SIGNER(S)

personally known to me **-OR-** proved to me on the basis of satisfactory evidence to be the person(s) whose name(s) is/are subscribed to the within instrument and acknowledged to me that he/she/they executed the same in his/her/their authorized capacity(ies), and that by his/her/their signatures on the instrument the persons(s), or the entity upon behalf of which the person(s) acted, executed the instrument.



WITNESS my hand and official seal.
[Signature]
SIGNATURE OF NOTARY

OPTIONAL

Though the data below is not required by law, it may prove valuable to persons relying on the document and could prevent fraudulent reattachment of this form.

CAPACITY CLAIMED BY SIGNER

- INDIVIDUAL
- CORPORATE OFFICER

TITLE(S)
- PARTNERS LIMITED
 GENERAL
- ATTORNEY-IN-FACT
- TRUSTEE(S)
- GUARDIAN/CONSERVATOR
- OTHER: _____

DESCRIPTION OF ATTACHED DOCUMENT

PARTIAL RECONVEYANCE
TITLE OR TYPE OF DOCUMENT

3
NUMBER OF PAGES

November 25, 2003
DATE OF DOCUMENT

Syncon Arbor
REFERENCE

SIGNER IS REPRESENTING:
NAME OF PERSON(S) OR ENTITY(IES)

PCB SERVICE CORPORATION,
a California corporation

0602030

BK0104PG04199

Attached to Partial Reconveyance
Syncon Homes, Arbor Gardens
Loan No. 24621-28649 & 24621-28926

EXHIBIT 'A'

Being a portion of the Northwest $\frac{1}{4}$ of the Southwest $\frac{1}{4}$ of Section 3, Township 12 North, Range 20 East further described as follows:

Lot 38, Block H, as set forth on Final Subdivision Map LDA 01-047, Planned Unit Development for Arbor Gardens, Phase 1, filed for record in the office of the County Recorder of Douglas County, State of Nevada on October 18, 2002, Book 1002, Page 8115, as Document No. 555262, and by Certificate of Amendment recorded February 20, 2003, in Book 0203, at Page 7818, as Document No. 567590.

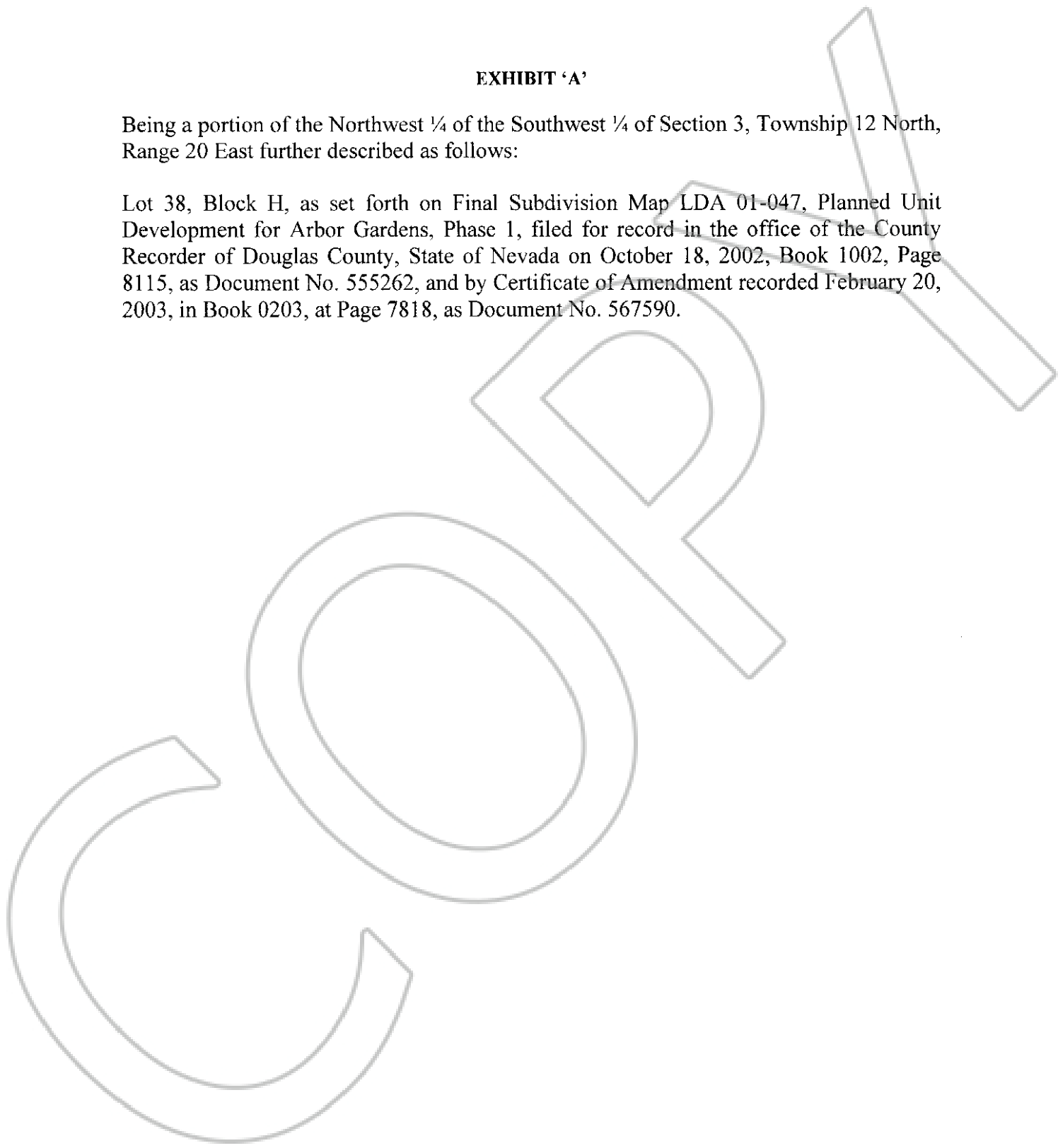

0602030

BK 0104 PG 04200