

A.P.N. # 1220-12-710-046

R.P.T.T. \$ 1209.00

ESCROW NO. 030704503

RECORDING REQUESTED BY:  
**STEWART TITLE COMPANY**

MAIL TAX STATEMENTS TO:  
**SAME AS BELOW**

WHEN RECORDED MAIL TO:  
**GRANTEE**  
**1968 PINENUT ROAD**  
**GARDNERVILLE, NV 89410**

REQUESTED BY  
**Stewart Title of Douglas County**  
IN OFFICIAL RECORDS OF  
DOUGLAS CO., NEVADA

2004 JAN 15 PM 3:57

WERNER CHRISTEN  
RECORDER

\$15<sup>00</sup> PAID Oh DEPUTY

(Space Above for Recorder's Use Only)

**GRANT, BARGAIN, SALE DEED**

THIS INDENTURE WITNESSETH: That **FRANK H. BOGART and MARY E. BOGART**, as Trustor(s) and Trustee(s) of the **BOGART FAMILY TRUST DATED SEPTEMBER 4, 1996**

in consideration of \$10.00, the receipt of which is hereby acknowledged, does hereby Grant, Bargain Sell and Convey to **JANET KEIRSEY, AN UNMARRIED WOMAN** S.

and to the heirs and assigns of such Grantee forever, all that real property situated in the County of **Douglas** State of Nevada, bounded and described as:

**SEE EXHIBIT "A" ATTACHED HERETO AND MADE A PART HEREOF**

Together with all and singular the tenements, hereditaments and appurtenances thereunto belonging or in anywise appertaining, and any reversions, remainders, rents, issues or profits thereof.

DATE: **January 09, 2004** **BOGART FAMILY TRUST**  
**DATED SEPTEMBER 4, 1996**

BY: Mary E. Bogart Trustee  
**MARY E. BOGART**  
**TRUSTOR AND TRUSTEE**

BY: \_\_\_\_\_

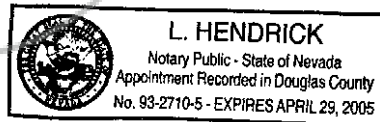

STATE OF Nevada }  
COUNTY OF Douglas } ss.

This instrument was acknowledged before me on 1-14-04  
by, **MARY E. BOGART**

Signature L. Hendrick  
Notary Public (One Inch Margin on all sides of Document for Recorders Use Only)

0602136

BK 0104 PG 04762

**EXHIBIT "A"**

**LEGAL DESCRIPTION**

**ESCROW NO.: 030704503**

**Lot 25, in Block B, of Phase 2, as set forth on the Plat of  
PINENUT MANOR NO. 1 AND 2, filed for record in the office  
of the County Recorder of Douglas County, Nevada, on June  
16, 1980, in Book 680, Page 1361, as Document No. 45348.**

**Assessor's Parcel No. 1220-12-710-046**

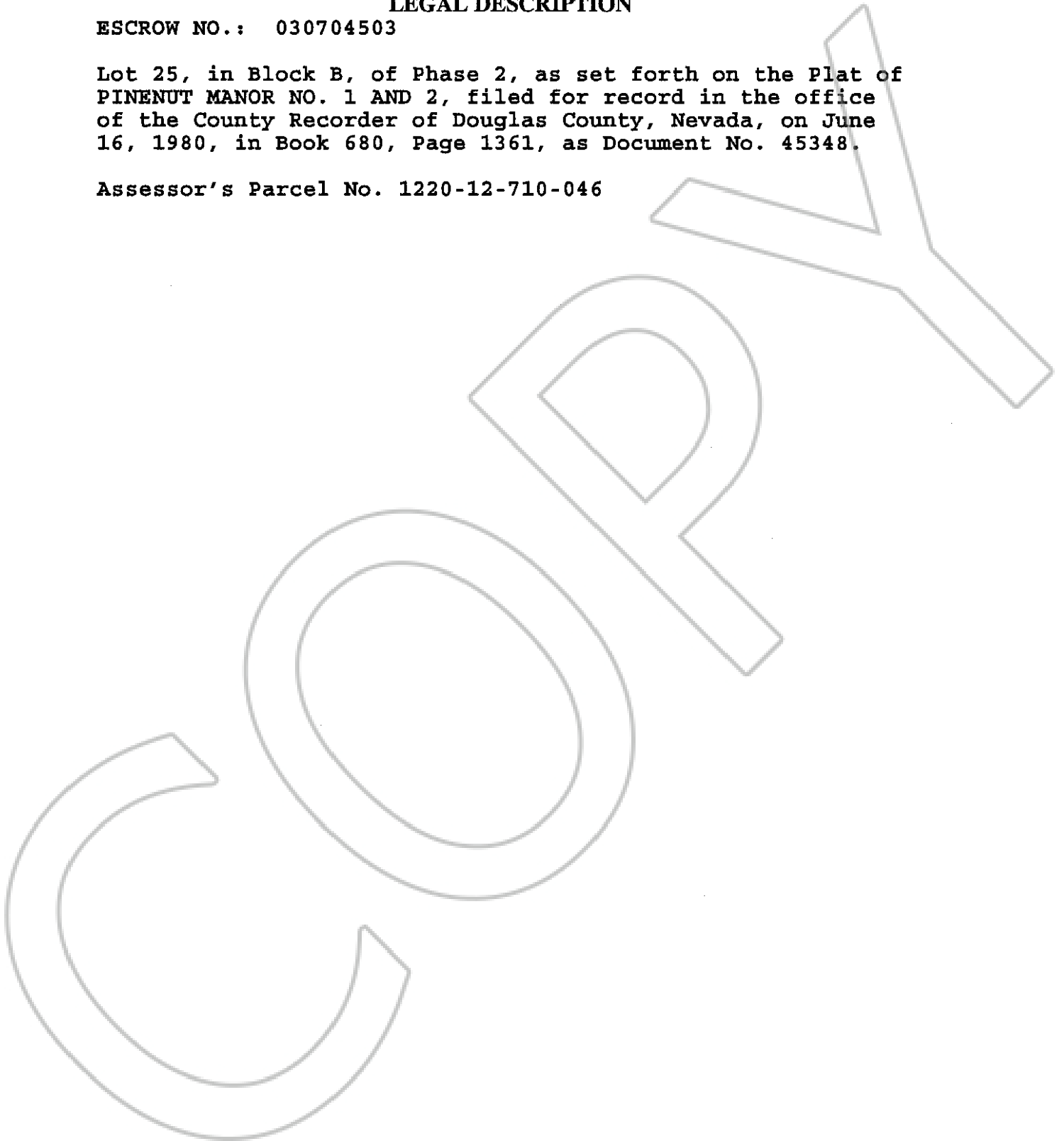

**0602136**

**BK0104PG04763**