

REQUESTED BY  
FIRST AMERICAN TITLE CO.

IN OFFICIAL RECORDS OF  
DOUGLAS CO., NEVADA

2004 JAN 16 PM 12:43

WERNER CHRISTEN  
RECORDER

\$ 16.00 PAID KJ DEPUTY

APN: 1420-33-111-002

ABOVE SPACE FOR RECORDER'S USE ONLY

### Assignment of Deed of Trust

For Value Received, the undersigned hereby grants, assigns and transfers to  
Mortgage Network, Inc.  
 all beneficial interest under that certain Deed of Trust dated January 12, 04 executed by  
Andrea L. Miller and Mary Kay Kraeling,  
 Trustor, to  
FCC Mortgage Corp.  
 Trustee, and recorded in Book 2104 <sup>PAGE 5310</sup> as Instrument No.: 60267 on  
1/16/2004, of Official Records in the County Recorder's office of Douglas  
 County, Nevada, describing land therein as:

SEE ATTACHED EXHIBIT "A"

Together with the note or notes therein described or referred to, the money due and to become due thereon with interest, and all rights accrued or to accrue under said Deed of Trust.

Dated: January 14, 2004

Cheryl A. Salemme

Assignor Cheryl A. Salemme,  
President  
FCC Mortgage Corp.

\_\_\_\_\_  
Assignor

SEE PAGE 2 FOR NOTARY ACKNOWLEDGEMENT

0602268

BK0104 PG05329

ASIGNDTB

**NOTARY ACKNOWLEDGEMENT FOR ASSIGNMENT OF DEED OF TRUST**

STATE OF NEVADA } SS:  
COUNTY OF Clark

This instrument was acknowledged before me on 1/14/04

by Cheryl A. Salomme

Chassare  
NOTARY PUBLIC

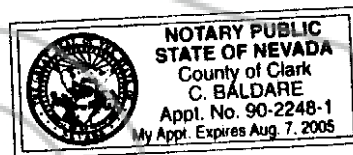

WHEN RECORDED MAIL TO:  
2340 Paseo Del Prado Ste: D-207  
Las Vegas, NV 89102

MAIL TAX STATEMENT TO:

0602268

BK 0104 PG 05330

DESCRIPTION

All that real property situated in the County of Douglas , State of Nevada, bounded and described as follows:

LOT 68, BLOCK A, AS SHOWN ON THE FINAL MAP OF WILDHORSE UNIT 3, A PLANNED UNIT DEVELOPMENT, FILED FOR RECORDS IN THE OFFICE OF THE COUNTY RECORDER OF DOUGLAS COUNTY, STATE OF NEVADA, ON JULY 2, 1990, IN BOOK 790, PAGE 026, AS DOCUMENT NO. 229406.

\* \* \* \* \*

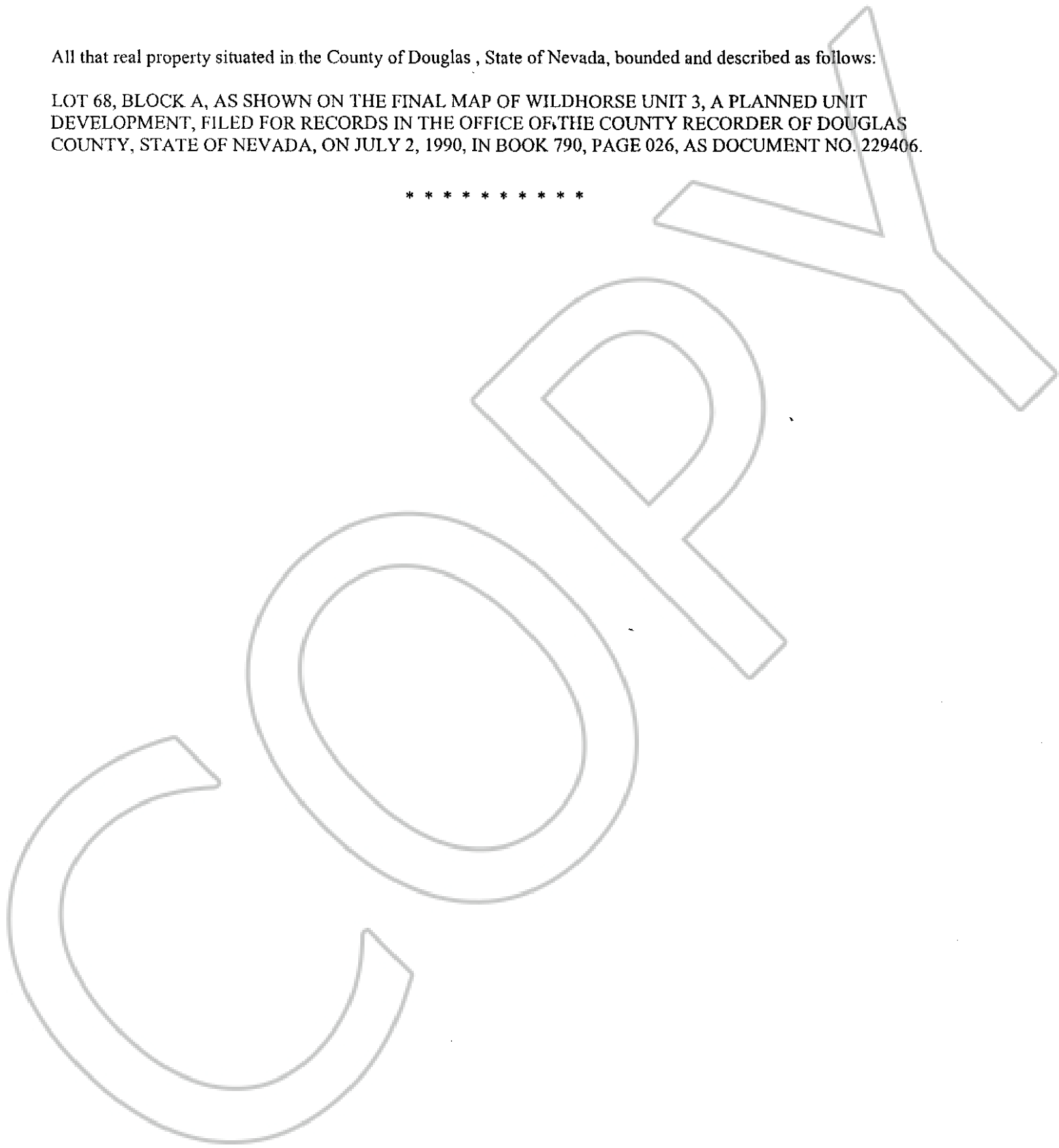

0602268

BK0104PG05331