

A.P.N. # 1318-24-710-017

R.P.T.T. \$ 828.75

ESCROW NO. 030704171

RECORDING REQUESTED BY:  
**STEWART TITLE COMPANY**  
MAIL TAX STATEMENTS TO:  
**SAME AS BELOW**

WHEN RECORDED MAIL TO:  
**GRANTEE**

**4497 W. MADISON AVENUE  
FRESNO, CA 93706**

REQUESTED BY  
**Stewart Title of Douglas County**

IN OFFICIAL RECORDS OF  
DOUGLAS CO., NEVADA

2004 JAN 16 PM 3:24

WERNER CHRISTEN  
RECORDER

\$15.00 PAID KJ DEPUTY

(Space Above for Recorder's Use Only)

### GRANT, BARGAIN, SALE DEED

THIS INDENTURE WITNESSETH: That **F. GENE DRAKE, Trustee of the GENE DRAKE 2000 REVOCABLE TRUST, dated September 5, 2000**

in consideration of \$10.00, the receipt of which is hereby acknowledged, docs hereby Grant, Bargain Sell and Convey to **RICHARD P. AMBROSINI and CINDY A. AMBROSINI, husband and wife, as Joint Tenants**

and to the heirs and assigns of such Grantee forever, all that real property situated in the County of **Douglas** State of Nevada, bounded and described as:

**SEE EXHIBIT "A" ATTACHED HERETO AND MADE A PART HEREOF**

Together with all and singular the tenements, hereditaments and appurtenances thereunto belonging or in anywise appertaining, and any reversions, remainders, rents, issues or profits thereof.

DATE: **December 22, 2003 GENE DRAKE 2000 REVOCABLE TRUST, dated September 5, 2000**

BY: F. Gene Drake Trustee  
**F. GENE DRAKE  
TRUSTEE**

BY: \_\_\_\_\_

STATE OF NEVADA }  
                                          } ss.  
COUNTY OF Humboldt }

This instrument was acknowledged before me on 1-7-04,  
by, **F. GENE DRAKE**

Signature Barbara Lockard

Notary Public (One Inch Margin on all sides of Document for Recorders Use Only)

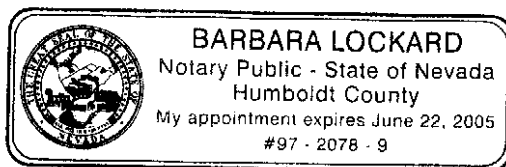

0602294

BK0104PG05403

**EXHIBIT "A"**

**LEGAL DESCRIPTION**

ESCROW NO.: 030704171

Lot 31, as shown on the map of KINGSBURY HIGHLANDS NO. 2,  
filed in the Office of the County Recorder of Douglas  
County, Nevada, on December 26, 1961, as Document No. 19280.

Assessors Parcel No. 1318-24-710-017

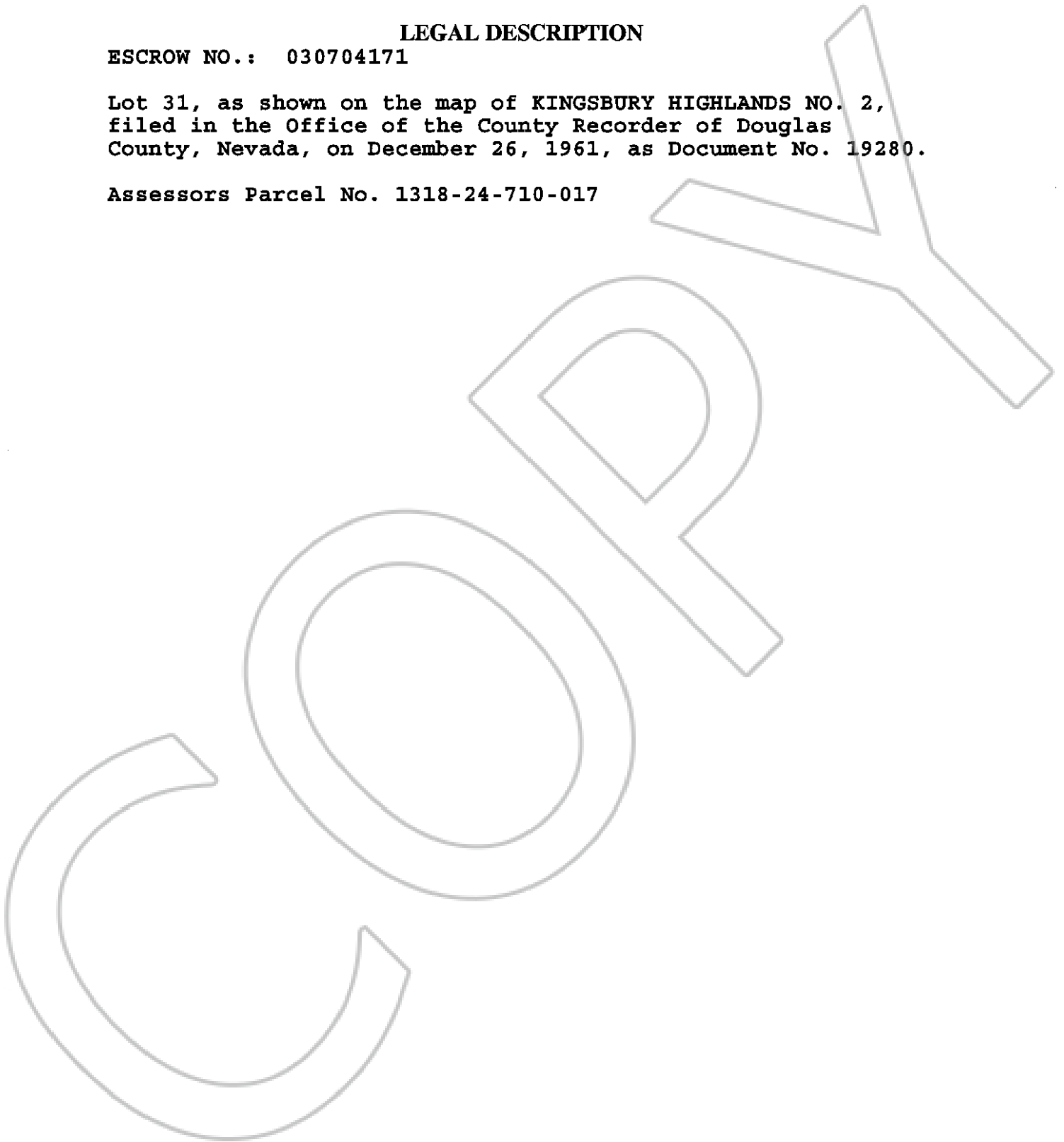

0602294  
BK0104PG05404