

15-

A.P.N. # 1220-09-412-014

R.P.T.T. \$ 0 (#6) —

MAIL TAX STATEMENTS TO:
✓ MR. & MRS. RICHARD E. LAURSEN
1025 RANCH ROAD
GARDNERVILLE, NV 89460

WHEN RECORDED MAIL TO:
✓ MR. AND MRS. RICHARD E. LAURSEN
1025 RANCH RD
GARDNERVILLE, NV 89460

REQUESTED BY
Mary E Laursen
IN OFFICIAL RECORDS OF
DOUGLAS CO., NEVADA

2004 JAN 27 PM 3:11

WERNER CHRISTEN
RECORDER

\$ 15.00 PAID Bc DEPUTY

(Space Above for Recorder's Use Only)

GRANT, BARGAIN, SALE DEED

THIS INDENTURE WITNESSETH: That **RICHARD E. LAURSEN and MARY E. LAURSEN, husband and wife**

in consideration of \$10.00, the receipt of which is hereby acknowledged, does hereby Grant, Bargain Sell and Convey to **RICHARD E. LAURSEN and MARY E. LAURSEN, Trustees of the RICHARD E. AND MARY E. LAURSEN TRUST** dated November 17, 1987

and to the heirs and assigns of such Grantee forever, all that real property situated in the **unincorporated area** County of **DOUGLAS** State of Nevada, bounded and described as:

SEE EXHIBIT "A" ATTACHED HERETO AND MADE A PART HEREOF

Together with all and singular the tenements, hereditaments and appurtenances thereunto belonging or in anywise appertaining, and any reversions, remainders, rents, issues or profits thereof.

DATE: January 27, 2004

Richard E. Laursen
RICHARD E. LAURSEN

Mary E. Laursen
MARY E. LAURSEN

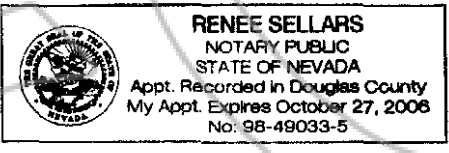

STATE OF NEVADA }
COUNTY OF DOUGLAS } ss.

This instrument was acknowledged before me on 1-27-04
by **RICHARD E. LAURSEN and MARY E. LAURSEN**

Signature _____

Notary Public (One inch margin on all sides of document for Recorder's Use Only)

BK 0104 PG 08878
0602958

EXHIBIT "A"

LEGAL DESCRIPTION

All that real property situate in the County of Douglas, State of Nevada, described as follows:

Lot 14, in Block C, as shown on the Final Map No. 97-008, of SILVERANCH UNIT 1-B, filed in the office of the County Recorder of Douglas County, State of Nevada, on August 14, 1997, in Book 897, Page 2529, as Document No. 419430.

Assessor's Parcel No. 1220-09-412-014

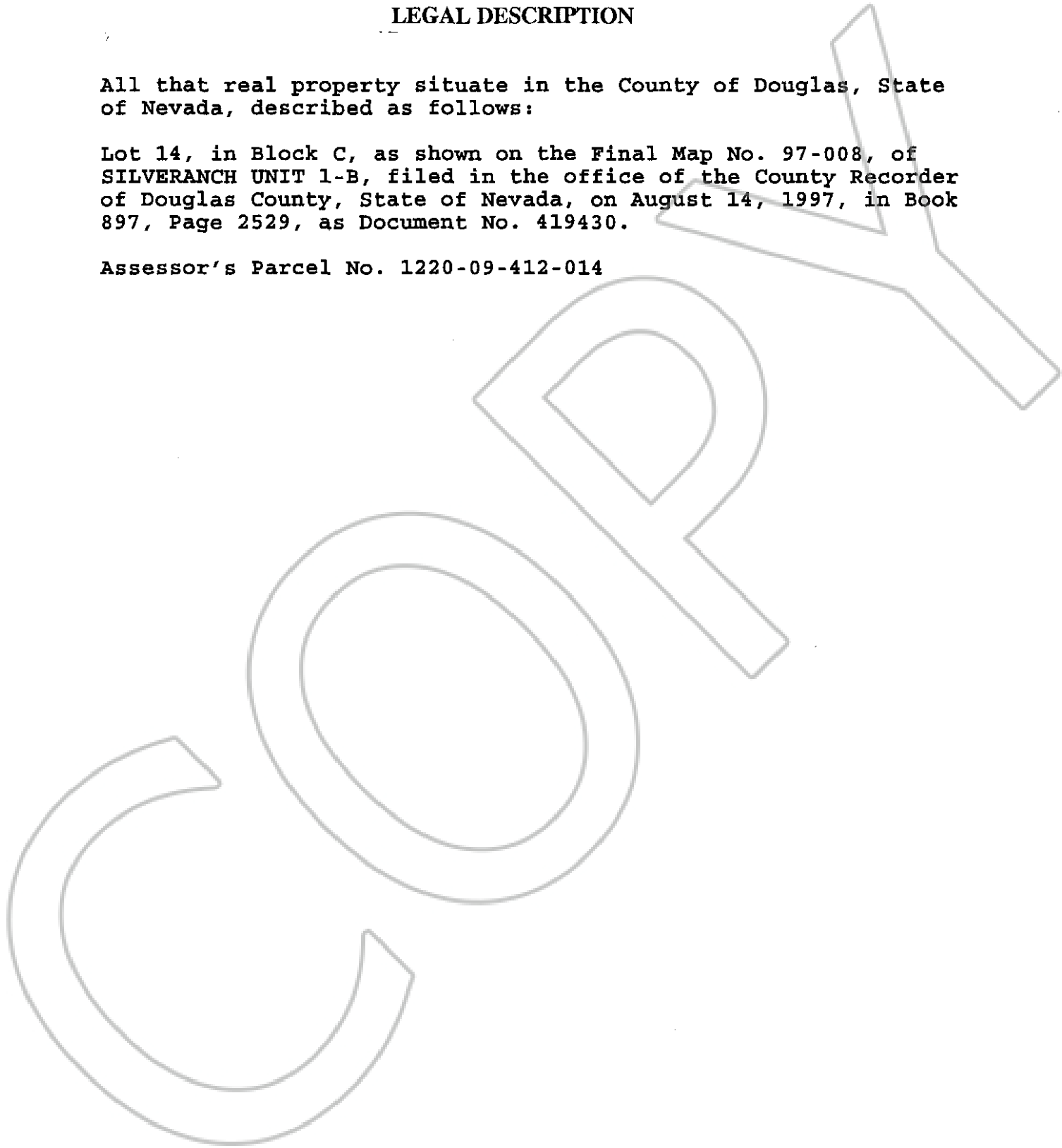

0602958

BK0104PG08879