

REQUESTED BY
WESTERN TITLE COMPANY, INC.
IN OFFICIAL RECORDS OF
DOUGLAS CO., NEVADA

APN: 1320-30-410-005

RPTT \$ #4

2004 JAN 30 PM 2:37

WERNER CHRISTEN
RECORDER

\$16 PAID KJ DEPUTY

WHEN RECORDED MAIL TO:
Name ALICE A. HUNT
Street 878 LONG LEAF PLACE
Address
City,State MINDEN, NV 89423
Zip

MAIL TAX STATEMENTS TO:
Name ALICE A. HUNT
Street 878 LONG LEAF PLACE
Address
City,State MINDEN, NV 89423
Zip
Order 00089461-201- KLS
No.

(SPACE ABOVE THIS LINE FOR RECORDERS USE)

GRANT, BARGAIN AND SALE DEED

THIS INDENTURE WITNESSETH: That ROBERT A. SOHLMAN, a married man, in consideration of \$10.00, the receipt of which is hereby acknowledged, does hereby Grant, Bargain, Sell and Convey to ALICE A. HUNT, a married woman as her sole and separate property all that real property situated in the County of Douglas, State of Nevada described as follows:

See Exhibit A attached hereto and made a part hereof.

TOGETHER with all and singular the tenements, hereditaments and appurtenances, if any, thereto belonging or appertaining, and any reversions, remainders, rents, issues or profits thereof.

Grantor and Grantee are husband and wife. It is the intention of Grantor that Grantee shall henceforth have and hold said real property as her sole and separate property. By this conveyance, Grantor releases any community interest that he might now have or be presumed to hereafter acquire in the above described property.

Dated: January 23, 2004

0603422

BK0104PG10965



ROBERT A. SOHLMAN

STATE OF NEVADA

COUNTY OF DOUGLAS

} ss

This instrument was acknowledged before me on

January 23, 2004

by Robert A. Sohlman

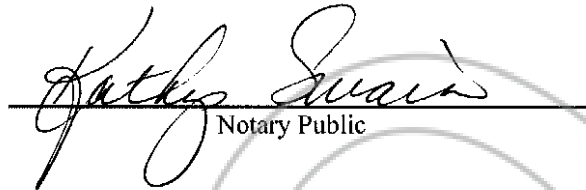

Notary Public

0603422

BK0104PG10966

Exhibit A

All that real property situate in the County of Douglas, State of Nevada, described as follows:

Lot 4, Block A of the FINAL MAP #1010-4B OF WESTWOOD VILLAGE UNIT 4B, according to the map thereof, filed in the office of the County Recorder of Douglas County, State of Nevada on December 13, 1995 in Book 1295, Page 1906, as Document No. 376827.

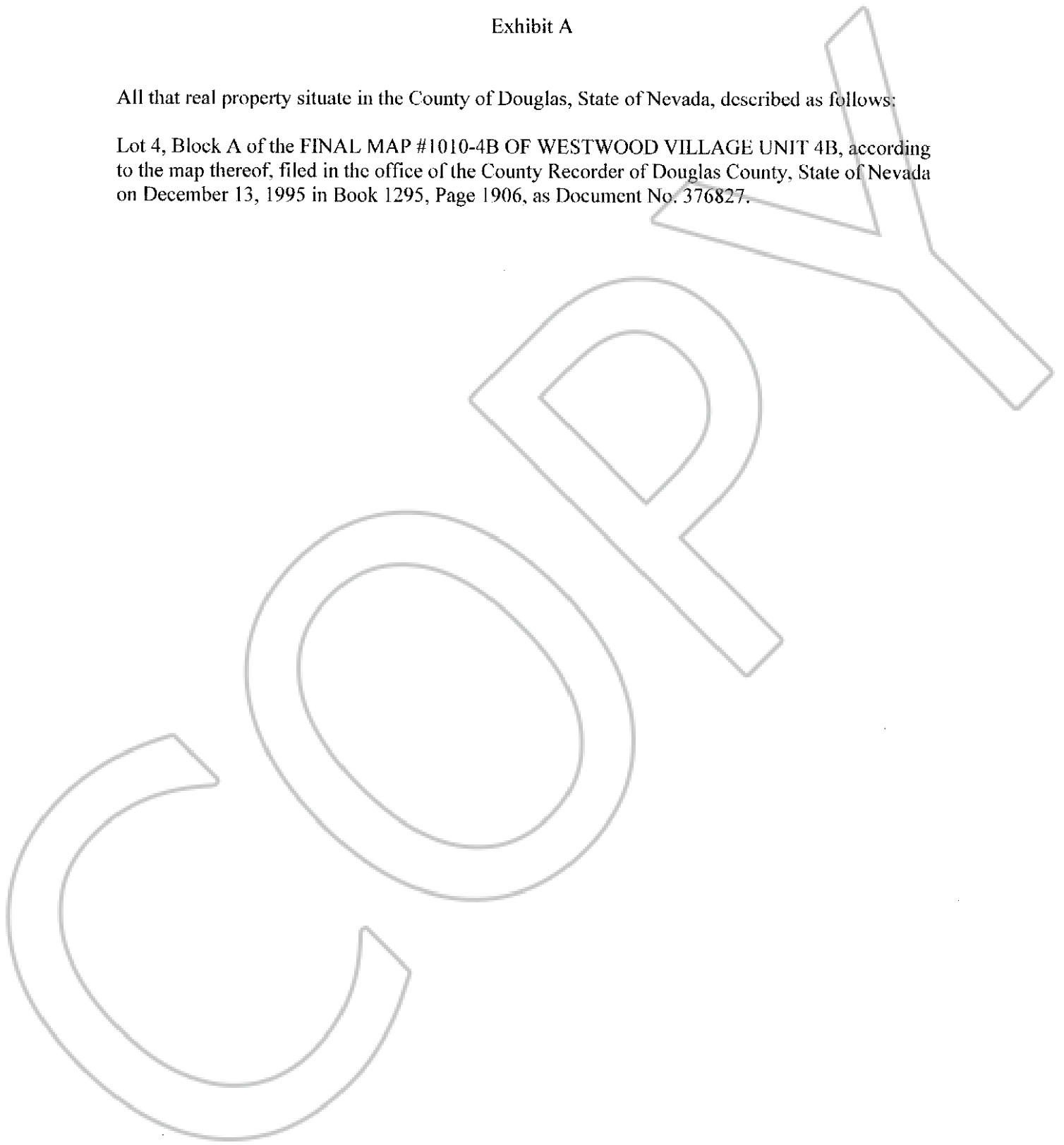

0603422
BK0104PG10967