

RECORDING REQUESTED BY  
Santa Barbara Bank & Trust  
Attn: Loan Support  
P O Box 60734  
Santa Barbara, Ca 93160-0734

AND WHEN RECORDED MAIL TO:  
SYNCON HOMES A NEVADA CORP  
2221 MERIDIAN BLVD  
MINDEN NV 89423

REQUESTED BY  
**Stewart Title of Douglas County**  
IN OFFICIAL RECORDS OF  
DOUGLAS CO., NEVADA

2004 FEB -3 AM 10:43

WERNER CHRISTEN  
RECORDER

\$ 16<sup>00</sup> PAID KJ DEPUTY

SPACE ABOVE THIS LINE FOR RECORDER'S USE

## PARTIAL RECONVEYANCE

Recon #04-0101-24

PCB SERVICE CORPORATION, a California corporation, trustee under Deed of Trust executed by Syncon Homes, a Nevada Corporation, Trustor, dated July 1, 2003 and recorded as Instrument No. 589991, on September 15, 2003 in Book 903, Page 7595-7605 having been requested in writing, by the holder of the obligation secured by said Deed of Trust, to reconvey the estate granted to Trustee under said Deed of Trust, in and to herein described property, and said Deed of Trust and note or notes secured thereby having been presented for endorsement, hereby reconveys, without warranty, to the person or persons legally entitled thereof, all estate now held by it thereunder in and to that property situated in Douglas County, State of Nevada described as follows:

See legal description attached hereto and made part hereof marked Exhibit "A"

January 6, 2004

PCB SERVICE CORPORATION,  
a California corporation

By:

  
Stephanie Millender

By:

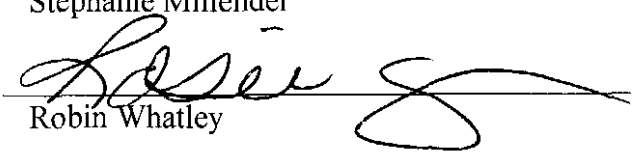
  
Robin Whatley

Title/Escrow Company: Stewart Title of Douglas Co., Attn: Jeanne Cooley, 1650 N. Lucerne, Minden, NV 89423  
Order No.: 30303574 Lot 33 Blk B, 1419 Cheddington  
Loan No.: 24621-26176

0603651

BK0204PG00673

**CALIFORNIA ALL-PURPOSE ACKNOWLEDGMENT**

State of California  
County of Santa Barbara

On 1-12-4 before me, Susie Norberg, Notary Public,  
DATE NAME, TITLE OF OFFICER-E.G., "JANE DOE, NOTARY PUBLIC"

personally appeared Stephanie Millender and Robin Whatley  
NAME(S) OF SIGNER(S)

personally known to me -OR-  proved to me on the basis of satisfactory evidence to be the person(s) whose name(s) is/are subscribed to the within instrument and acknowledged to me that he/she/they executed the same in his/her/their authorized capacity(ies), and that by his/her/their signatures on the instrument the persons(s), or the entity upon behalf of which the person(s) acted, executed the instrument.

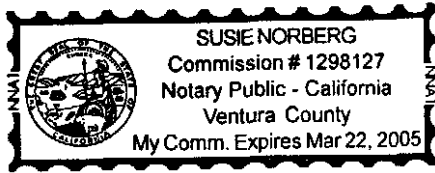

WITNESS my hand and official seal.

Susie Norberg  
SIGNATURE OF NOTARY

**OPTIONAL**

Though the data below is not required by law, it may prove valuable to persons relying on the document and could prevent fraudulent reattachment of this form.

**CAPACITY CLAIMED BY SIGNER**

**DESCRIPTION OF ATTACHED DOCUMENT**

INDIVIDUAL  
 CORPORATE OFFICER  
\_\_\_\_\_  
TITLE(S)

PARTIAL RECONVEYANCE  
TITLE OR TYPE OF DOCUMENT

PARTNERS       LIMITED  
 GENERAL

3  
NUMBER OF PAGES

ATTORNEY-IN-FACT  
 TRUSTEE(S)  
 GUARDIAN/CONSERVATOR  
 OTHER: \_\_\_\_\_

January 6, 2004  
DATE OF DOCUMENT

**SIGNER IS REPRESENTING:**  
NAME OF PERSON(S) OR ENTITY(IES)

Syncon Chichester  
REFERENCE

PCB SERVICE CORPORATION,  
a California corporation

0603651

BK0204PG00674

ATTACHED TO PARTIAL RECONVEYANCE  
Syncon Homes of California Loan No. 24621-26176

**EXHIBIT "A"**

Lot 33, Block B, as set forth on FINAL SUBDIVISION MAP NO. 1006-11 for CHICHESTER ESTATES, PHASE 11, filed in the Office of the County Recorder of Douglas County, Nevada and recorded December 27, 2002, in Book 1202, Page 12732, as Document No. 562225, and by Certificate of Amendment recorded March 27, 2003 in Book 0303, Page 13037, as Document No. 0571430, Official Records of Douglas County, Nevada..

Assessors Parcel Number 1320-33-816-050

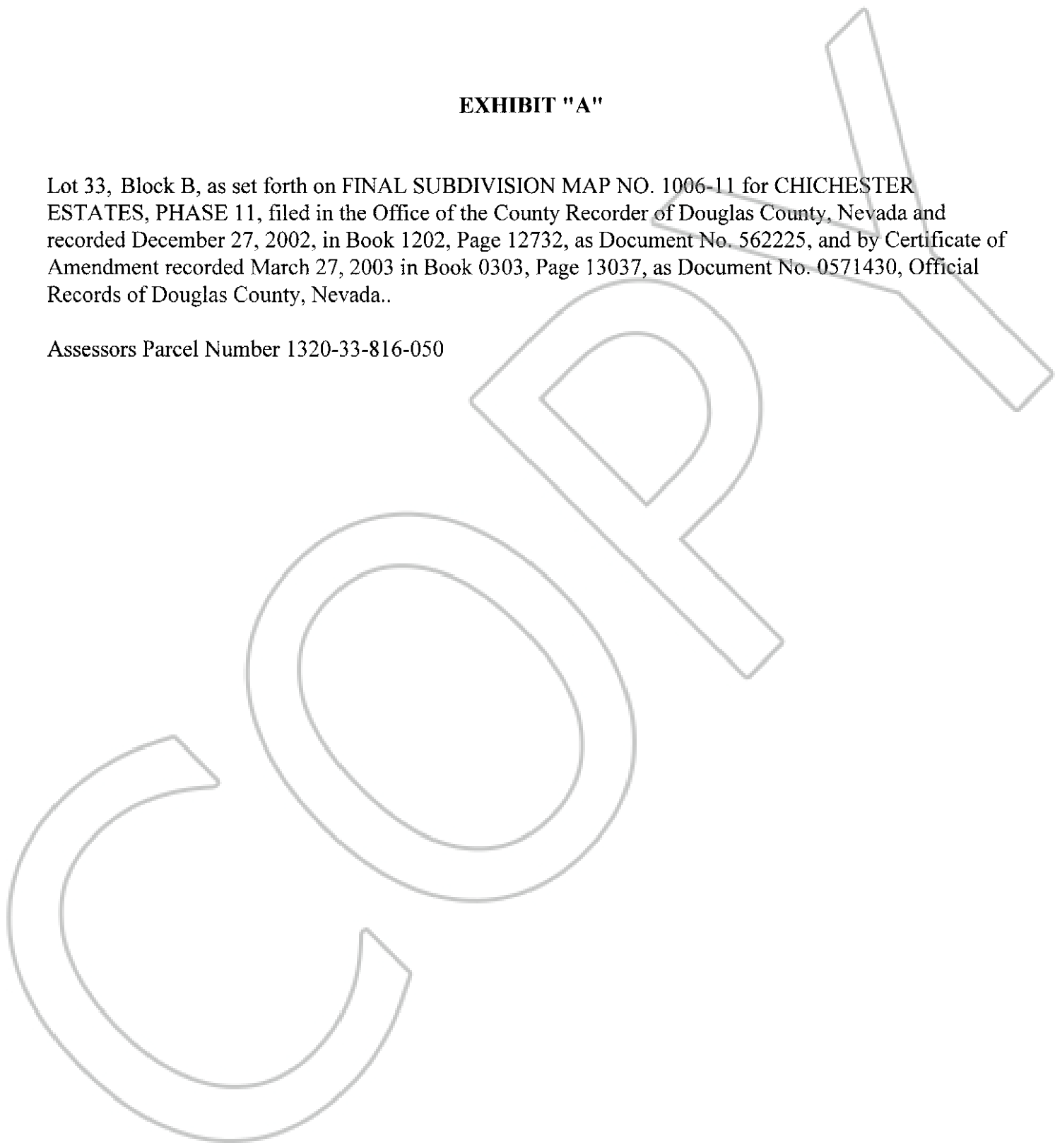

0603651

BK0204PG00675