

RECORDING REQUESTED BY
Santa Barbara Bank & Trust
Attn: Loan Support
P O Box 60734
Santa Barbara, Ca 93160-0734

AND WHEN RECORDED MAIL TO:
SYNCON HOMES A NEVADA CORP
2221 MERIDIAN BLVD
MINDEN NV 89423

REQUESTED BY
~~Stewart Title of Douglas County~~
IN OFFICIAL RECORDS OF
DOUGLAS CO., NEVADA

2004 FEB -3 AM 10:46

WERNER CHRISTEN
RECORDER

\$16⁰⁰ PAID ~~16~~ DEPUTY

SPACE ABOVE THIS LINE FOR RECORDER'S USE

PARTIAL RECONVEYANCE

Recon #04-0101-22

PCB SERVICE CORPORATION, a California corporation, trustee under Deed of Trust executed by Syncon Homes, a Nevada Corporation, Trustor, dated July 1, 2003 and recorded as Instrument No. 589991, on September 15, 2003 in Book 903, Page 7595-7605 having been requested in writing, by the holder of the obligation secured by said Deed of Trust, to reconvey the estate granted to Trustee under said Deed of Trust, in and to herein described property, and said Deed of Trust and note or notes secured thereby having been presented for endorsement, hereby reconveys, without warranty, to the person or persons legally entitled thereof, all estate now held by it thereunder in and to that property situated in Douglas County, State of Nevada described as follows:

See legal description attached hereto and made part hereof marked Exhibit "A"

January 6, 2004

PCB SERVICE CORPORATION,
a California corporation

By: Stephanie Millender
Stephanie Millender

By: Robin Whatley
Robin Whatley

Title/Escrow Company: Stewart Title of Douglas Co., Attn: Jeanne Cooley, 1650 N. Lucerne, Minden, NV 89423
Order No.: 30303372 Lot 35 Blk B, 1423 Cheddington
Loan No.: 24621-26176

0603652

BK0204PG00676

CALIFORNIA ALL-PURPOSE ACKNOWLEDGMENT

State of California
 County of Santa Barbara

On 1-12-4 before me, Susie Norberg, Notary Public,
DATE NAME, TITLE OF OFFICER-E.G., "JANE DOE, NOTARY PUBLIC"

personally appeared Stephanie Millender and Robin Whatley
NAME(S) OF SIGNER(S)

personally known to me **-OR-** proved to me on the basis of satisfactory evidence to be the person(s) whose name(s) is/are subscribed to the within instrument and acknowledged to me that he/she/they executed the same in his/her/their authorized capacity(ies), and that by his/her/their signatures on the instrument the persons(s), or the entity upon behalf of which the person(s) acted, executed the instrument.

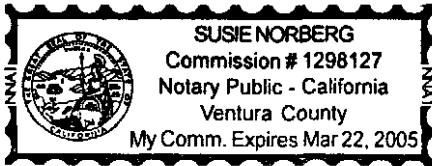

WITNESS my hand and official seal.

Susie Norberg
SIGNATURE OF NOTARY

OPTIONAL

Though the data below is not required by law, it may prove valuable to persons relying on the document and could prevent fraudulent reattachment of this form.

CAPACITY CLAIMED BY SIGNER

INDIVIDUAL
 CORPORATE OFFICER

TITLE(S)

PARTNERS LIMITED
 GENERAL

ATTORNEY-IN-FACT
 TRUSTEE(S)
 GUARDIAN/CONSERVATOR
 OTHER: _____

DESCRIPTION OF ATTACHED DOCUMENT

PARTIAL RECONVEYANCE
TITLE OR TYPE OF DOCUMENT

3
NUMBER OF PAGES

January 6, 2004
DATE OF DOCUMENT

SIGNER IS REPRESENTING:
NAME OF PERSON(S) OR ENTITY(IES)

Syncon Chichester
REFERENCE

PCB SERVICE CORPORATION,
a California corporation

0603652

BK0204PG00677

ATTACHED TO PARTIAL RECONVEYANCE
Syncon Homes of California Loan No. 24621-26176

EXHIBIT "A"

Lot 35, Block B, as set forth on FINAL SUBDIVISION MAP NO. 1006-11 for CHICHESTER ESTATES, PHASE 11, filed in the Office of the County Recorder of Douglas County, Nevada and recorded December 27, 2002, in Book 1202, Page 12732, as Document No. 562225, and by Certificate of Amendment recorded March 27, 2003 in Book 0303, Page 13037, as Document No. 0571430, Official Records of Douglas County, Nevada..

Assessors Parcel Number 1320-33-816-048

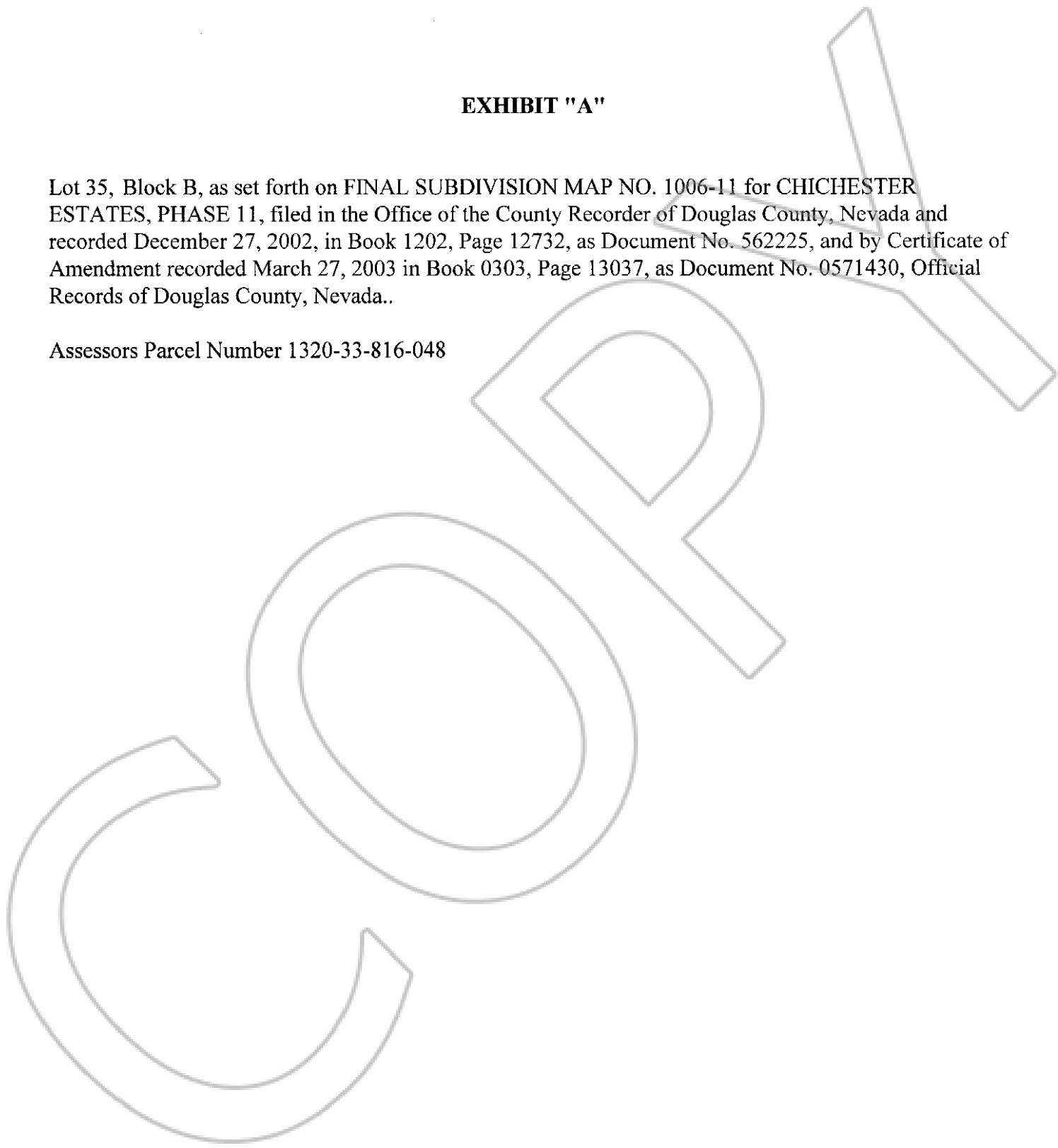

0603652

BK0204PG00678