

A.P.N. # 1420-07-618-001

R.P.T.T. \$ 0.00 #6
ESCROW NO. 030302710

RECORDING REQUESTED BY:
STEWART TITLE COMPANY
MAIL TAX STATEMENTS TO:
SAME AS BELOW

WHEN RECORDED MAIL TO:
ARMSTRONG
450 CENTERVILLE LANE
GARDNERVILLE, NV 89410

REQUESTED BY
Stewart Title of Douglas County
IN OFFICIAL RECORDS OF
DOUGLAS CO., NEVADA

2004 FEB -6 PM 4: 17

WERNER CHRISTEN
RECORDER

\$ 15.00 PAID Kj DEPUTY

(Space Above for Recorder's Use Only)

GRANT, BARGAIN, SALE DEED

THIS INDENTURE WITNESSETH: That **DALE ARMSTRONG and SUZANNE ARMSTRONG, aka SUZANNE MAY ARMSTRONG, Trustees of ARMSTRONG FAMILY TRUST, dated June 25, 2003, as to their undivided 1/2 interest**

in consideration of \$10.00, the receipt of which is hereby acknowledged, does hereby Grant, Bargain Sell and Convey to **DALE ARMSTRONG and SUZANNE ARMSTRONG, husband and wife as joint tenants**

and to the heirs and assigns of such Grantee forever, all that real property situated in the County of **DOUGLAS** State of Nevada, bounded and described as:

SEE EXHIBIT "A" ATTACHED HERETO AND MADE A PART HEREOF

Together with all and singular the tenements, hereditaments and appurtenances thereunto belonging or in anywise appertaining, and any reversions, remainders, rents, issues or profits thereof.

DATE: **December 03, 2003**

Dale Armstrong Trustee
DALE ARMSTRONG, TRUSTEE
Suzanne Armstrong Trustee
SUZANNE ARMSTRONG, TRUSTEE

 **J.M. COOLEY**
NOTARY PUBLIC
STATE OF NEVADA
Appt. Recorded in Carson City
My Appt. Expires February 15, 2005
No: 97-0092-3

STATE OF NEVADA }
COUNTY OF DOUGLAS } ss.

This instrument was acknowledged before me on 2-3-04
by DALE ARMSTRONG, TRUSTEE and SUZANNE ARMSTRONG, TRUSTEE

Signature J.M. Cooley
Notary Public (One inch margin on all sides of document for Recorder's Use Only)

0604038
BK0204 PG02968

EXHIBIT "A"

LEGAL DESCRIPTION

ESCROW NO.: 030302710

**Lot No. 1, Block A, as said Lot is shown on the plat of
HIGHLAND ESTATES UNIT 4, recorded on May 2, 1978, File No.
20214, Official Records of Douglas County, State of Nevada.**

ASSESSOR'S PARCEL NO. 1420-07-618-001

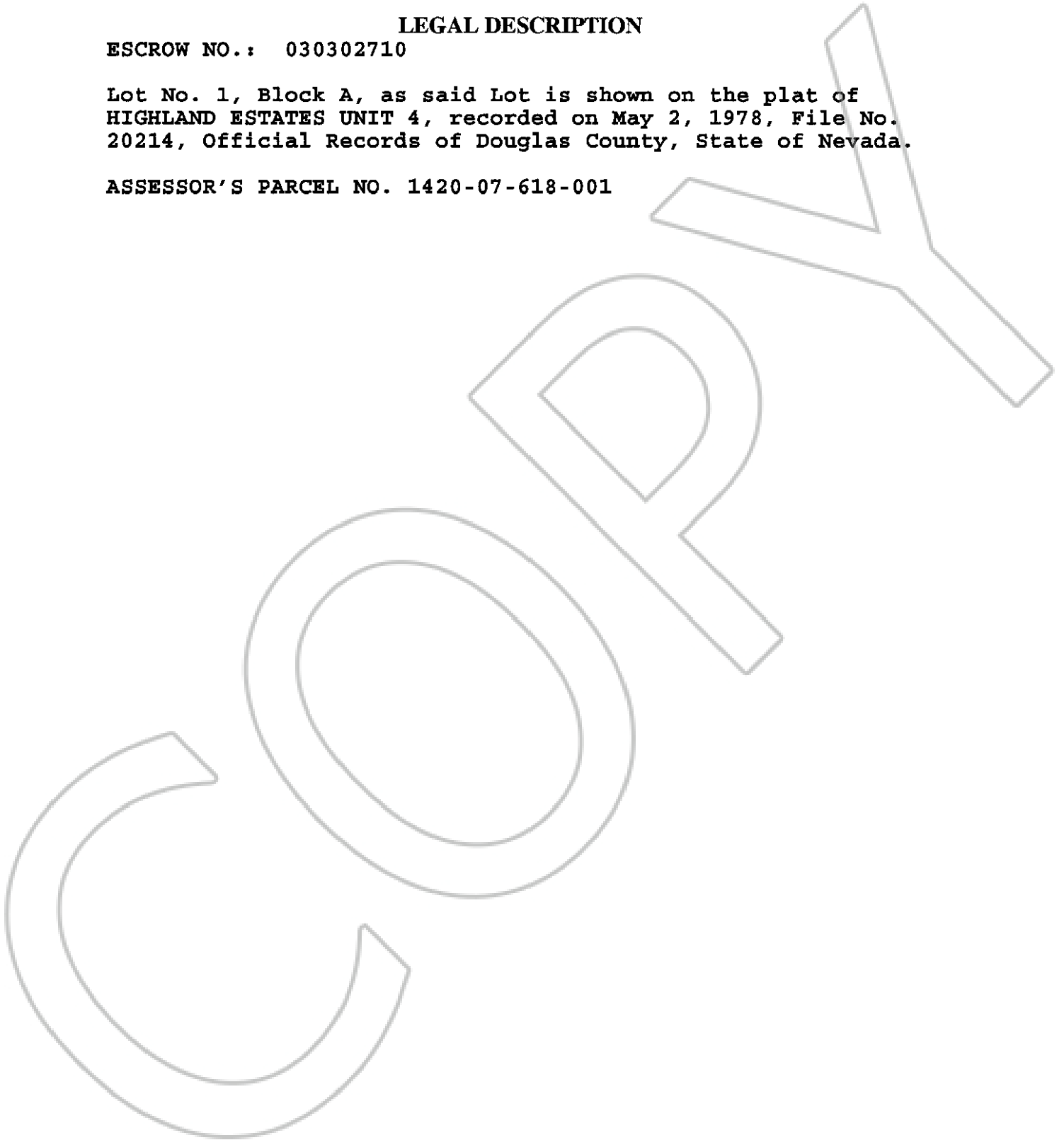

0604038

BK0204PG02969