

16-

REQUESTED BY  
*Peelle mgmt Corp*  
IN OFFICIAL RECORDS OF  
DOUGLAS CO., NEVADA

2004 FEB -9 AM 8:31

WERNER CHRISTEN  
RECORDER

*\$16.00 PAID KJ* DEPUTY

When Recorded, Return to:  
PEELLE ASSIGNMENT DIVISION  
P.O. BOX 1710  
CAMPBELL, CA 95009-1710  
(408) 866-6868

Loan Number: 041-801095-5

APN Number: APN #1: 1418-34-111-033

*prepared by Savorn Sok*

This form was prepared by: HOMECOMINGS FINANCIAL NETWORK, INC.  
address: ONE MERIDIAN CROSSING, SUITE 100, MINNEAPOLIS, MN 55423

## ASSIGNMENT OF DEED OF TRUST *27-085*

For Value Received, the undersigned holder of a Deed of Trust (herein "Assignor") whose address is ONE MERIDIAN CROSSING, SUITE 100, MINNEAPOLIS, MN 55423

, does hereby grant, sell, assign, transfer and convey, unto the GMAC MORTGAGE CORPORATION

, a corporation organized and existing under the laws of PENNSYLVANIA (herein "Assignee"), whose address is 100 WITMER ROAD, HORSHAM, PA 19044

, made and all beneficial interest under a certain Deed of Trust dated OCTOBER 1, 2003 executed by KEVIN BRUN AND JEANNETTE BRUN, HUSBAND AND WIFE, AS JOINT TENANTS

to WESTERN TITLE COMPANY

*Recorded on 10-8-2003*  
to secure payment of ONE HUNDRED SEVENTY FOUR THOUSAND AND NO/100

Trustee, and given

(\$ 174,000.00 )

(Include the Original Principal Amount)

which Deed of Trust is of record in Book, Volume, or Liber No. , at page

(or as No. *0592742* of the *Public* Records of DOUGLAS County, State of Nevada, together with the note(s) and obligations therein described, the money due and to become due thereon with interest, and all rights accrued or to accrue under such Deed of Trust.

TO HAVE AND TO HOLD, the same unto Assignee, its successor and assigns, forever, subject only to the terms and conditions of the above-described Deed of Trust.

IN WITNESS WHEREOF, the undersigned Assignor has executed this Assignment of Deed of Trust on OCTOBER 13, 2003

*Savorn Sok*  
Witness

HOMECOMINGS FINANCIAL NETWORK, INC.

(Assignor)

Witness

By: *Nasrin Chowdhury*  
NASRIN CHOWDHURY, ASSISTANT SECRETARY

0604061

BK0204PG03034

Attest

Seal:

**SEAL**

**Mail Tax Statements To:** GMAC Mortgage Corporation  
P.O. Box 780, Waterloo, IA 50704-0780

State of MN

County of HENNEPIN

On October 13, 2003 before me, MELISSA A. ALSHOUSE  
personally appeared NASRIN CHOWDHURY, ASSISTANT SECRETARY  
of HOMEcomings FINANCIAL NETWORK, INC.  
personally known to me (or proved to me on the basis of satisfactory  
evidence) to be the person(s) whose name(s) is/are subscribed to the  
within instrument and acknowledged to me that he/she/they executed  
the same in his/her/their authorized capacity(ies), and that by his/  
her/their signature(s) on the instrument the person(s) or the entity  
upon behalf of which the person(s) acted, executed the instrument.

WITNESS my hand and official seal.

Signature

Melissa A. Alshouse  
Notary Public

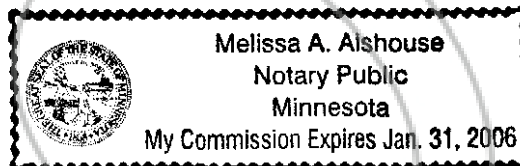
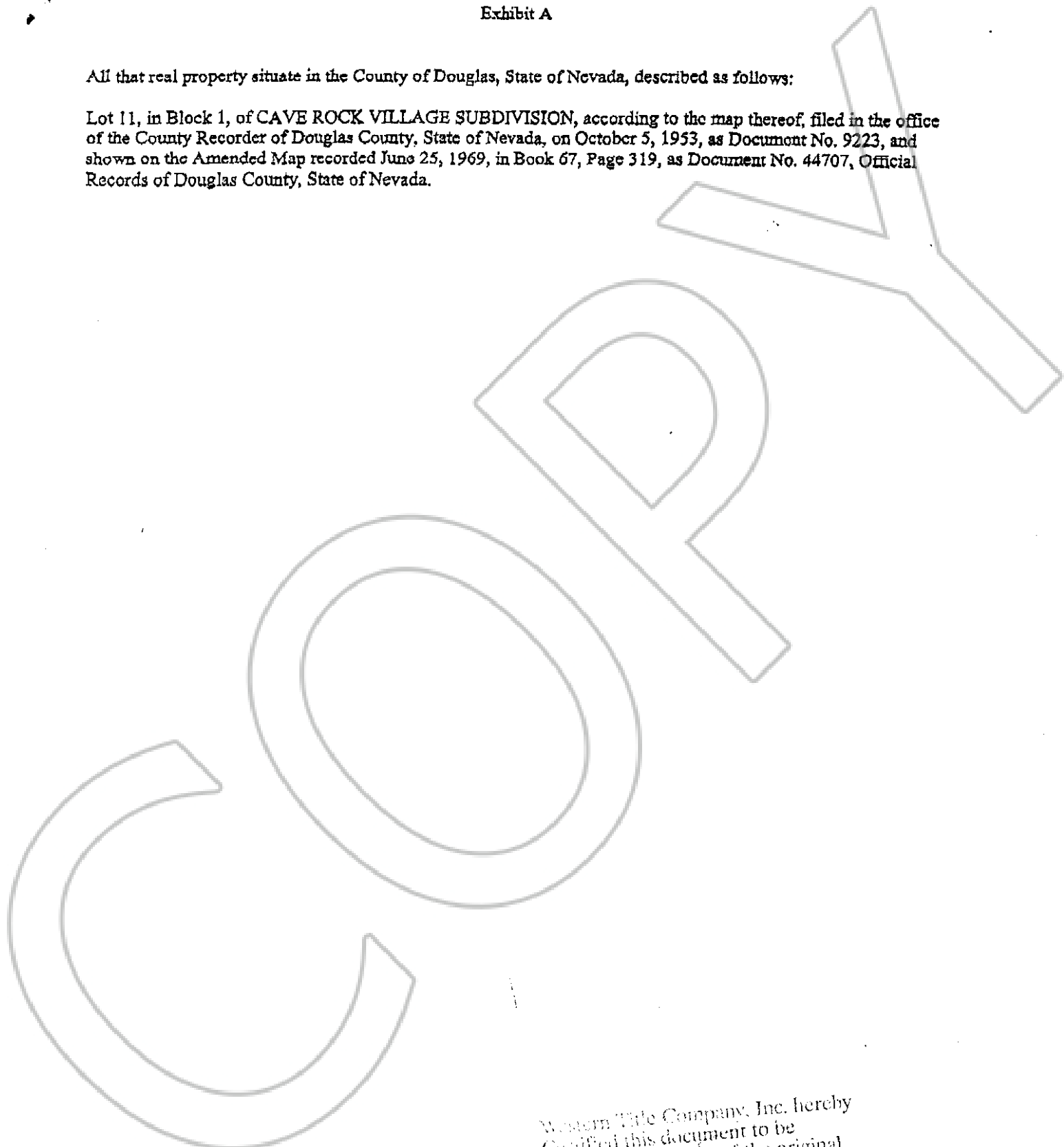

Exhibit A

All that real property situate in the County of Douglas, State of Nevada, described as follows:

Lot 11, in Block 1, of CAVE ROCK VILLAGE SUBDIVISION, according to the map thereof, filed in the office of the County Recorder of Douglas County, State of Nevada, on October 5, 1953, as Document No. 9223, and shown on the Amended Map recorded June 25, 1969, in Book 67, Page 319, as Document No. 44707, Official Records of Douglas County, State of Nevada.



Western Title Company, Inc. hereby  
Certified this document to be  
True and exact copy of the original.  
Western Title Company, Inc.  
By \_\_\_\_\_

0604061  
BK0204PG03036