

A.P.N. # 1320-30-211-036

R.P.T.T. \$ 975.00
ESCROW NO. 040700272

RECORDING REQUESTED BY:
STEWART TITLE COMPANY
MAIL TAX STATEMENTS TO:
SAME AS BELOW

WHEN RECORDED MAIL TO:
GRANTEE
5333 PORT SAILWOOD DRIVE
NEWARK, CA 94560

REQUESTED BY
Stewart Title of Douglas County
IN OFFICIAL RECORDS OF
DOUGLAS CO., NEVADA

2004 FEB 11 PM 3:54

WERNER CHRISTEN
RECORDER

\$15.00 PAID KJ DEPUTY

(Space Above for Recorder's Use Only)

GRANT, BARGAIN, SALE DEED

THIS INDENTURE WITNESSETH: That **SMITH & SMITH, LLC.,** a Nevada
Limited Liability Company

in consideration of \$10.00, the receipt of which is hereby acknowledged, does hereby Grant, Bargain Sell
and Convey to **ALAN G. PERCELL and MARGARET R. ANDERSON, HUSBAND AND WIFE**
AS JOINT TENANTS

and to the heirs and assigns of such Grantee forever, all that real property situated in the
County of **Douglas** State of Nevada, bounded and described as:

SEE EXHIBIT "A" ATTACHED HERETO AND MADE A PART HEREOF

Together with all and singular the tenements, hereditaments and appurtenances thereunto belonging or in
anywise appertaining, and any reversions, remainders, rents, issues or profits thereof.

DATE: **February 02, 2004** **SMITH & SMITH, LLC,**
a Nevada **Limited Liability Company**

BY: *[Signature]*
COLE S. SMITH
MANAGER

BY: _____

STATE OF Nevada }
COUNTY OF Douglas } ss.



This instrument was acknowledged before me on 2-3-04,
by, COLE S. SMITH

Signature *Laurel S. Ballou*
Notary Public (One Inch Margin on all sides of Document for Recorders Use Only)

0604360

BK0204PG04502

EXHIBIT "A"

LEGAL DESCRIPTION

ESCROW NO.: 040700272

Lot 3, Block E, as shown on the Official Map of WESTWOOD VILLAGE UNIT NO. 1, filed for record in the Office of the County Recorder on October 5, 1979, in Book 1079, Page 440, Document No. 37417, and A Certificate of Amendment recorded July 14, 1980, in Book 780, Page 783 and further A Certificate of Amendment recorded January 31, 1991, in Book 191, Page 3820, Official Records of Douglas County, Nevada.

Assessor's Parcel No. 1320-30-211-036

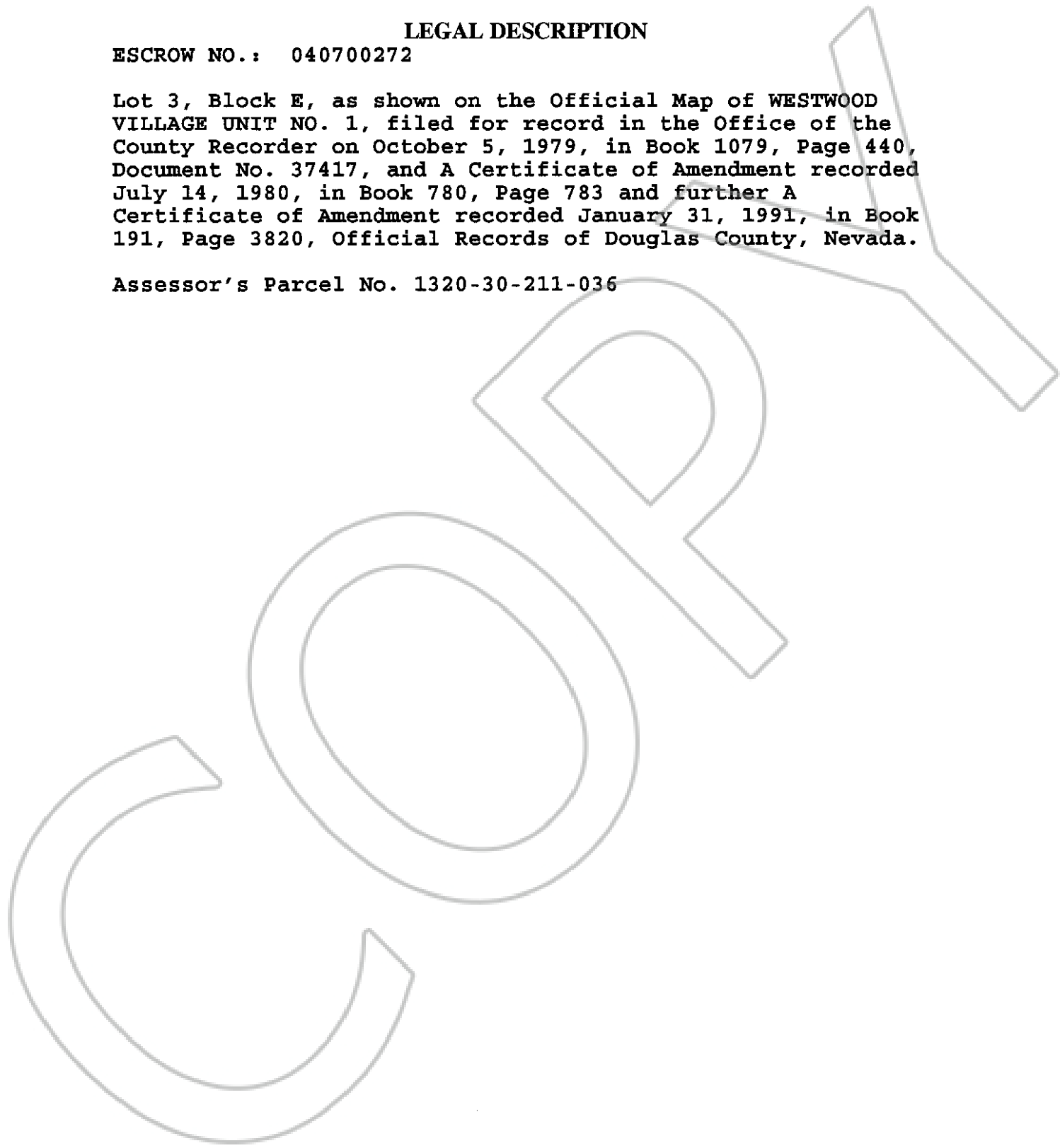

0604360

BK0204PG04503