

A.P.N. # 1219-03-002-044
R.P.T.T. \$ 0.00 Ex #6
ESCROW NO. _____
RECORDING REQUESTED BY:

MAIL TAX STATEMENTS TO:
SAME AS BELOW

WHEN RECORDED MAIL TO:
GRANTEE
✓ 226 AUTUMN HILLS ROAD
GARDNERVILLE, NV 89460

REQUESTED BY
Hazel Stewart
IN OFFICIAL RECORDS OF
DOUGLAS CO., NEVADA
2004 FEB 12 AM 11:15
WERNER CHRISTEN
RECORDER
\$ 15⁰⁰ PAID K2 DEPUTY

(Space Above for Recorder's Use Only)

GRANT, BARGAIN, SALE DEED

THIS INDENTURE WITNESSETH: That ROBERT D. STEWART AND HAZEL M. STEWART, HUSBAND AND WIFE AS JOINT TENANTS

in consideration of \$10.00, the receipt of which is hereby acknowledged, does hereby Grant, Bargain Sell and Convey to DOUG AND HAZEL STEWART LIVING TRUST u/d/t February 10, 1990, as amended February 21, 1997, as amended May 18, 2000

and to the heirs and assigns of such Grantee forever, all that real property situated in the County of DOUGLAS State of Nevada, bounded and described as:

SEE EXHIBIT "A" ATTACHED HERETO AND MADE A PART HEREOF

Together with all and singular the tenements, hereditaments and appurtenances thereunto belonging or in anyway appertaining, and any reversions, remainders, rents, issues or profits thereof.

DATE: February 12, 2004

Robert D. Stewart
ROBERT D. STEWART

Hazel M. Stewart
HAZEL M. STEWART

STATE OF NEVADA }
 } SS.
COUNTY OF DOUGLAS }

 HELEN PETRI
NOTARY PUBLIC
STATE OF NEVADA
Appt. Recorded in Douglas County
My Appt. Expires July 3, 2007
No: 02-74814-5

This instrument was acknowledged before me on 2/12/04
by: ROBERT D. STEWART and HAZEL M. STEWART

Signature Helen Petri
Notary Public (One inch margin on all sides of document for Recorder's Use Only)

0604466
BK0204PG04869

EXHIBIT "A"

LEGAL DESCRIPTION

All that certain lot, piece or parcel of land situate in the Southwest 1/4 of Section 3, Township 12 North, Range 19 East, Douglas County, Nevada, more particularly described as follows:

Parcel 2, as set forth on the Parcel Map for LAURENCE CARMAGNOLA, filed for record on April 11, 1979, in the office of the County Recorder of Douglas County, Nevada, in Book 479, Page 564, as Document No. 31453.

Assessor's Parcel Number: 1219-03-002-044

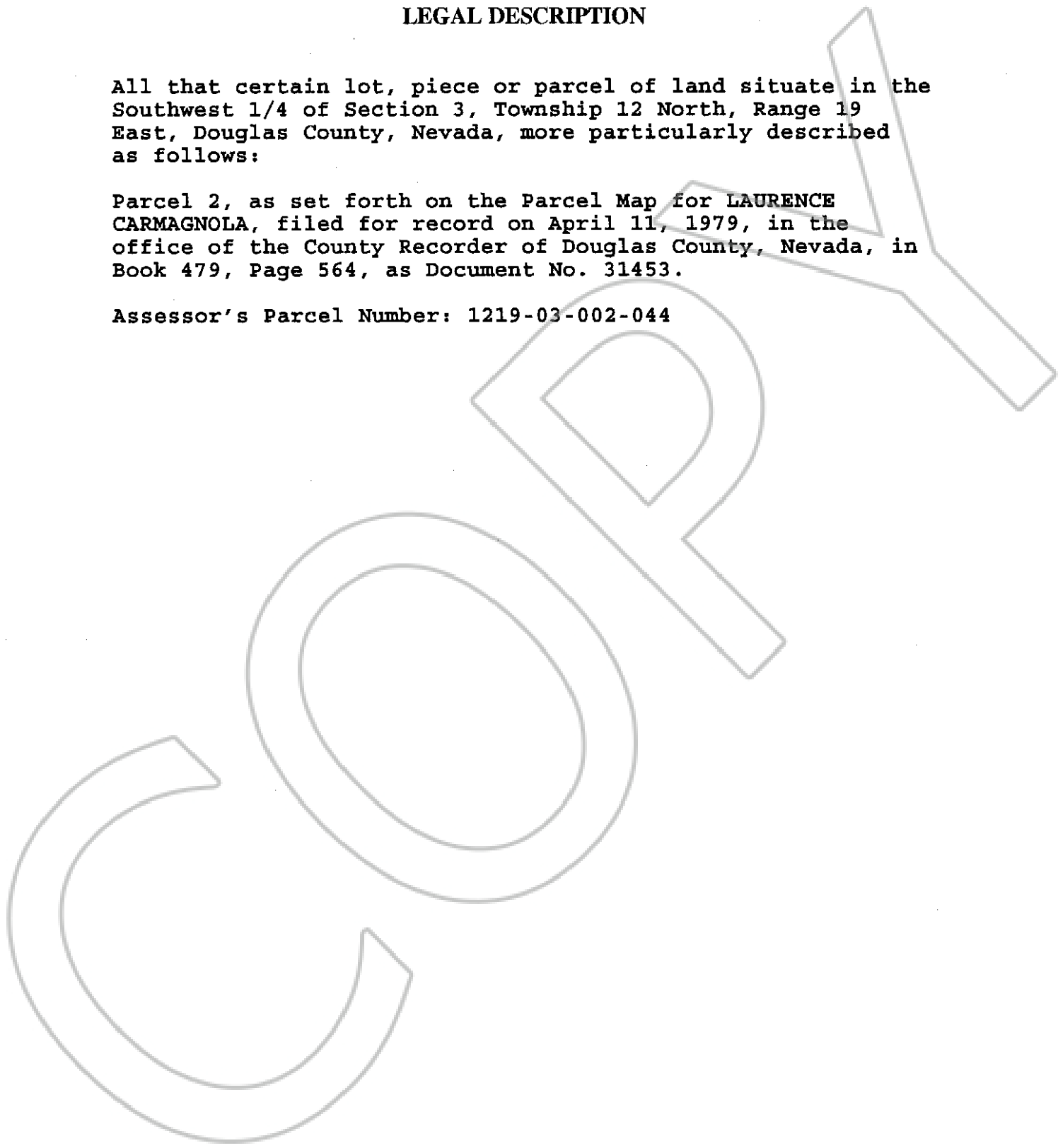

0604466
BK0204PG04870