

REQUESTED BY
WESTERN TITLE COMPANY, INC.
IN OFFICIAL RECORDS OF
DOUGLAS CO., NEVADA

APN: 1318-26-512-003
RPTT \$Ex. # Full Value Full Value less liens

2004 FEB 12 PM 2: 39

LC CB
WHEN RECORDED MAIL TO:
Name GRIFFETH E. TULLY TRUSTEE
Street 4485 HILLSBOROUGH DR.
Address
City,State CASTRO VALLEY, CA 94546
Zip

WERNER CHRISTEN
RECORDER

s 16 PAID *KJ* DEPUTY

MAIL TAX STATEMENTS TO:
Name GRIFFETH E. TULLY TRUSTEE
Street 4485 HILLSBOROUGH DR.
Address
City,State CASTRO VALLEY, CA 94546
Zip
Order 00089423-201- JWG
No.

(SPACE ABOVE THIS LINE FOR RECORDERS USE)

GRANT, BARGAIN AND SALE DEED

THIS INDENTURE WITNESSETH: That

FOR A VALUABLE CONSIDERATION, receipt of which is hereby acknowledged, GRIFFETH E. TULLY, PERSONAL REPRESENTATIVE OF THE ESTATE OF PIERCE EDWARD TULLY, DECEASED, NINTH JUDICIAL DISTRICT COURT OF THE STATE OF NEVADA, CASE #03 PB0066, do(es) hereby GRANT(s) BARGAIN SELL and CONVEY to GRIFFETH E. TULLY, SUCCESSOR TRUSTEE OF THE PIERCE E. TULLY AND DOROTHY A. TULLY DECLARATION OF TRUST DATED NOVEMBER 30, 1990 and to the heirs and assigns of such Grantee forever, all the following real property situated in the City of Stateline, County of Douglas, State of Nevada bounded and described as follows:

See Exhibit A attached hereto and made a part hereof.

TOGETHER with all tenements, hereditaments and appurtenances, if any, thereto belonging or appertaining, and any reversions, remainders, rents, issues or profits thereof.

Dated: January 16, 2004

0604488

BK0204PG04966

Griffeth E. Tully
GRIFFETH E. TULLY

STATE OF CALIFORNIA }
COUNTY OF SANTA CLARA } ss
This instrument was acknowledged before me on

2-10-2004

by GRIFFETH E. TULLY

Maria Schopplein
Notary Public



0604488

BK0204PG04967

Exhibit A

All that real property situate in the County of Douglas, State of Nevada, described as follows:

Lot 3, in Block, A, as shown on the Official Map of KINGSBURY HEIGHTS SUBDIVISION, filed for record in the Office of the County Recorder of Douglas County, State of Nevada, on August 5, 1959, as Document No. 14738.

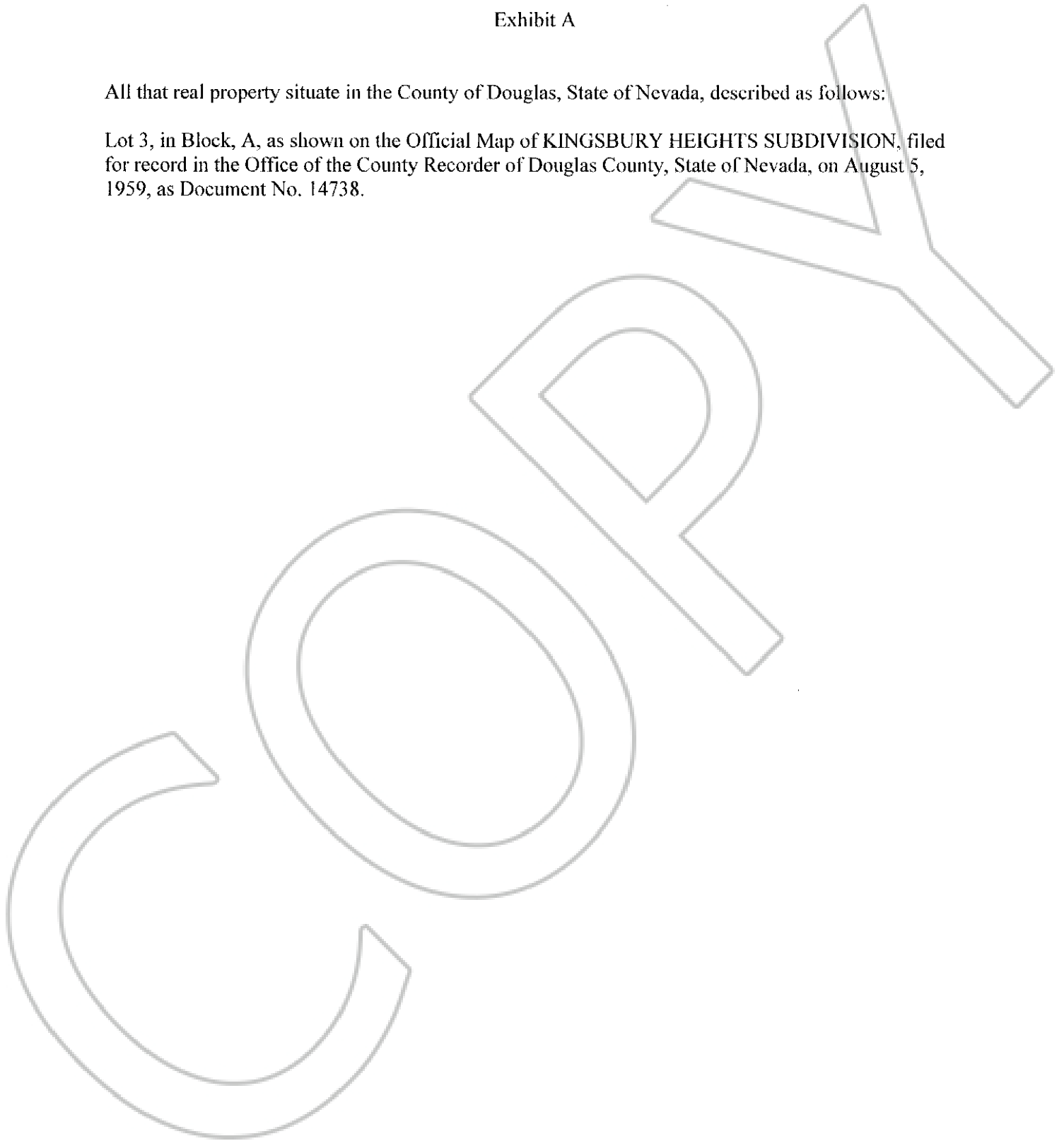

0604488
BK0204PG04968