

A.P.N. # 1220-10-310-003

R.P.T.T. \$ 1657.50  
ESCROW NO. 040100217

RECORDING REQUESTED BY:  
**STEWART TITLE COMPANY**  
MAIL TAX STATEMENTS TO:  
**SAME AS BELOW**

WHEN RECORDED MAIL TO:  
**GRANTEE**  
**1480 GLENWOOD DRIVE**  
**GARDNERVILLE, NV. 89410**

REQUESTED BY  
**Stewart Title of Douglas County**  
IN OFFICIAL RECORDS OF  
DOUGLAS CO., NEVADA

2004 FEB 17 PM 3:56

WERNER CHRISTEN  
RECORDER

\$15<sup>00</sup> PAID KJ DEPUTY

(Space Above for Recorder's Use Only)

**GRANT, BARGAIN, SALE DEED**

THIS INDENTURE WITNESSETH: That **JAMES EDWARD PETERSON and SCOTTY MARIE PETERSON, husband and wife**

in consideration of \$10.00, the receipt of which is hereby acknowledged, does hereby Grant, Bargain Sell and Convey to **DAVID CINCIALA and YVONNE CINCIALA, husband and wife** AS JOINT TENANTS WITH RIGHTS OF SURVIVORSHIP

and to the heirs and assigns of such Grantee forever, all that real property situated in the County of **Douglas** State of Nevada, bounded and described as:

**SEE EXHIBIT "A" ATTACHED HERETO AND MADE A PART HEREOF**

Together with all and singular the tenements, hereditaments and appurtenances thereunto belonging or in anywise appertaining, and any reversions, remainders, rents, issues or profits thereof.

DATE: **January 26, 2004**

[Signature]  
**JAMES EDWARD PETERSON**

[Signature]  
**SCOTTY MARIE PETERSON**

  
**SUZANNE CHEECHOV**  
NOTARY PUBLIC  
STATE OF NEVADA  
Appt. Recorded in Douglas County  
My Appt. Expires June 25, 2007  
No: 99-36458-5

STATE OF NV }  
COUNTY OF Douglas } ss.

This instrument was acknowledged before me on 2/13/04  
by **JAMES EDWARD PETERSON and SCOTTY MARIE PETERSON**

Signature [Signature]

Notary Public (One inch margin on all sides of document for Recorder's Use Only)

0604840  
BK0204PG6779

**EXHIBIT "A"**

**LEGAL DESCRIPTION**

**ESCROW NO.: 040100217**

**Lot 34, COUNTRY CLUB ESTATES, as shown on the official map recorded in the office of the County Recorder of Douglas County, Nevada, on July 17, 1967, in Book 1 of Maps and Document No. 37147.**

**Assessors Parcel No. 1220-10-310-003**

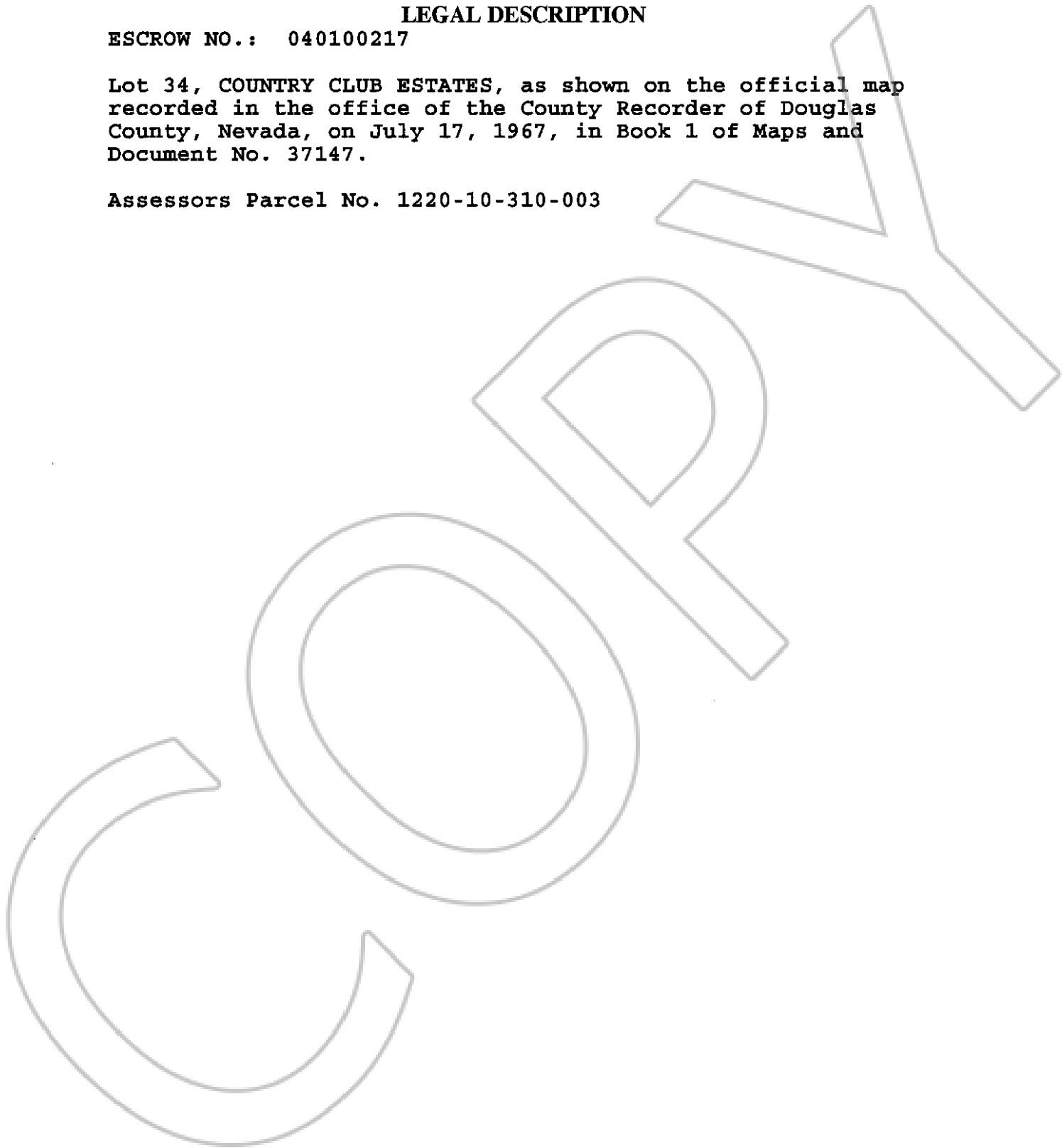

**0604840  
BK0204PG6780**