

A.P.N. # 1220-22-310-203

R.P.T.T. \$ 858.00

ESCROW NO. 040800060

RECORDING REQUESTED BY:
STEWART TITLE COMPANY

MAIL TAX STATEMENTS TO:
SAME AS BELOW

WHEN RECORDED MAIL TO:
GRANTEE
1490 KATHY WAY
GARDNERVILLE, NV

REQUESTED BY
Stewart Title of Douglas County
IN OFFICIAL RECORDS OF
DOUGLAS CO., NEVADA

2004 FEB 19 PM 3:42

WERNER CHRISTEN
RECORDER

\$15⁰⁰ PAID *Be* DEPUTY

(Space Above for Recorder's Use Only)

GRANT, BARGAIN, SALE DEED

THIS INDENTURE WITNESSETH: That **JUSTIN M. JOHNSON and BECKY JOHNSON, husband and wife**

in consideration of \$10,000, the receipt of which is hereby acknowledged, docs hereby Grant, Bargain Sell and Convey to **MAX SOUDER and MARLA SOUDER, husband and wife**
AS JOINT TENANTS

and to the heirs and assigns of such Grantee forever, all that real property situated in the County of **Douglas** State of Nevada, bounded and described as:

SEE EXHIBIT "A" ATTACHED HERETO AND MADE A PART HEREOF

Together with all and singular the tenements, hereditaments and appurtenances thereunto belonging or in anywise appertaining, and any reversions, remainders, rents, issues or profits thereof.

DATE: **January 22, 2004**

Justin M. Johnson

JUSTIN M. JOHNSON
Becky Johnson

BECKY JOHNSON

 **TRACI E. ADAMS**
NOTARY PUBLIC
STATE OF NEVADA
Appt. Recorded in Douglas County
My Appt. Expires January 5, 2007
No: 89-1891-5

 **TRACI E. ADAMS**
NOTARY PUBLIC
STATE OF NEVADA
Appt. Recorded in Douglas County
My Appt. Expires January 5, 2007
No: 89-1891-5

STATE OF NEVADA }
COUNTY OF DOUGLAS } ss.

This instrument was acknowledged before me on 2/2/2004
by JUSTIN M. JOHNSON and BECKY JOHNSON

Signature *Traci E. Adams*

Notary Public (One inch margin on all sides of document for Recorder's Use Only)

0605102
BK0204PG8020

EXHIBIT "A"

LEGAL DESCRIPTION

ESCROW NO.: 040800060

Lot 913, as shown on the map of GARDNERVILLE RANCHOS UNIT NO. 7, filed for record in the office of the County Recorder of Douglas County, Nevada, on March 27, 1974, as Document No. 72456.

Assessors Parcel No. 1220-22-310-203

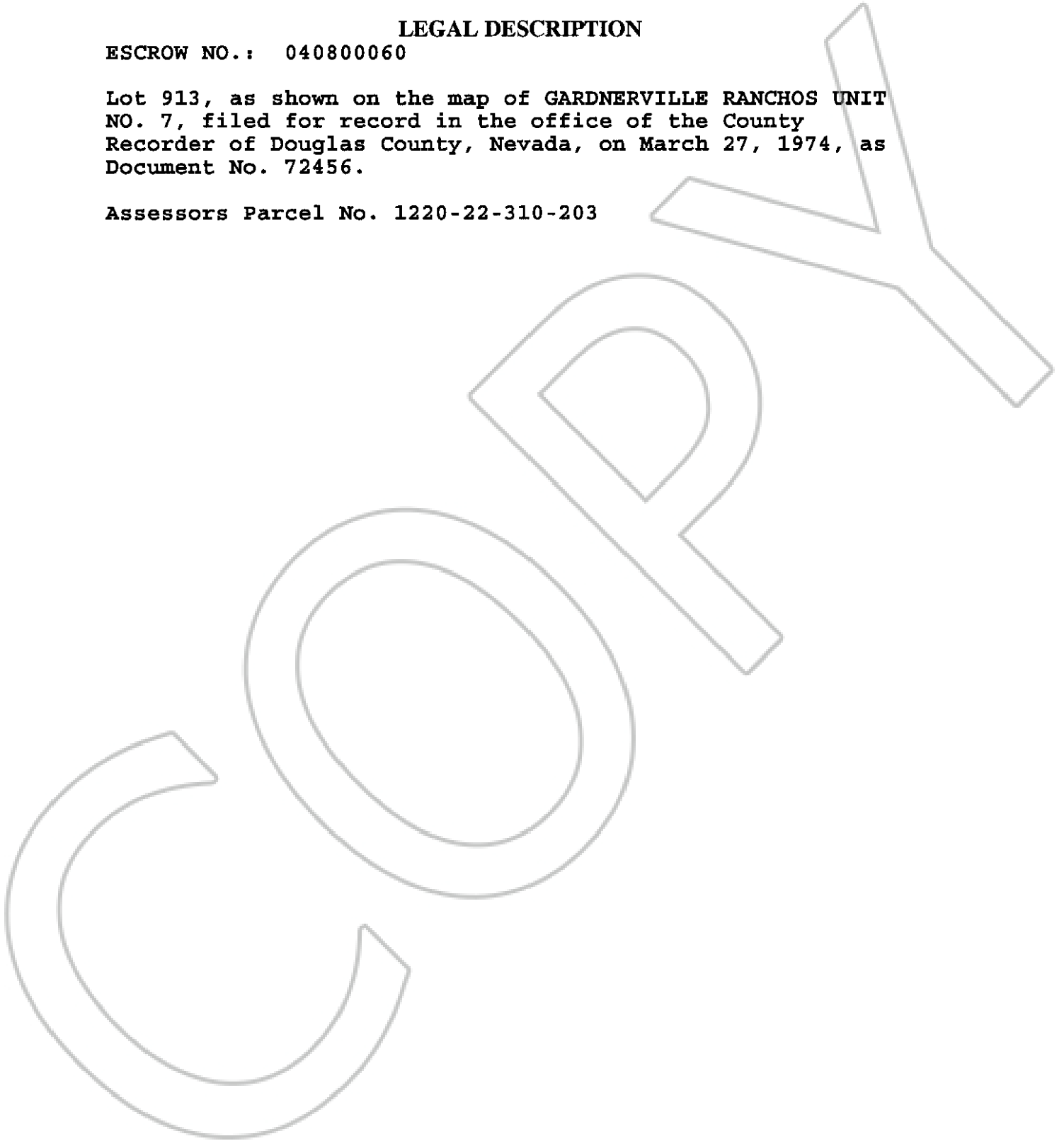

**0605102
BK0204PG8021**