

A.P.N. # 1220-22-310-187

R.P.T.T.S. 0 #5

ESCROW NO. 040100223

RECORDING REQUESTED BY:
STEWART TITLE COMPANY

MAIL TAX STATEMENTS TO:
SAME AS BELOW

WHEN RECORDED MAIL TO:

MICHAEL DELACOUR
1450 Sally Lane
Gardnerville, Nevada 89460

REQUESTED BY
Stewart Title of Douglas County
IN OFFICIAL RECORDS OF
DOUGLAS CO., NEVADA

2004 FEB 23 PM 3:39

WERNER CHRISTEN
RECORDER

\$ 15.00 PAID kg DEPUTY

(Space Above for Recorder's Use Only)

GRANT, BARGAIN, SALE DEED

THIS INDENTURE WITNESSETH: That **JULEE A. DELACOUR, AN UNMARRIED WOMAN**

in consideration of \$10.00, the receipt of which is hereby acknowledged, does hereby Grant, Bargain Sell and Convey to **MICHAEL DELACOUR, AN UNMARRIED MAN**

and to the heirs and assigns of such Grantee forever, all that real property situated in the County of **DOUGLAS** State of Nevada, bounded and described as:

SEE EXHIBIT "A" ATTACHED HERETO AND MADE A PART HEREOF

Together with all and singular the tenements, hereditaments and appurtenances thereunto belonging or in anywise appertaining, and any reversions, remainders, rents, issues or profits thereof.

DATE: **February 23, 2004**

Julee A. Delacour
JULEE A. DELACOUR

This document is recorded as an accommodation only and without liability on the consideration therefor, or as to the validity or sufficiency of said instrument, or for the effect thereof recording on the title of the property involved.



SUZANNE CHEECHOV
NOTARY PUBLIC
STATE OF NEVADA
Appt. Recorded in Douglas County
My Appt. Expires June 25, 2007
No: 99-3458-5

STATE OF NEVADA }
COUNTY OF DOUGLAS } SS.

This instrument was acknowledged before me on 2/23/2004
by JULEE A. DELACOUR

Signature *Suzanne Cheechov*

Notary Public (One inch margin on all sides of document for Recorder's Use Only)

0605370

BK0204PG09505

**EXHIBIT "A"
LEGAL DESCRIPTION**

Order No.: 040100223

The land referred to herein is situated in the State of Nevada,
County of Douglas, described as follows:

Lot 845, as shown on the map of GARDNERVILLE RANCHOS UNIT
NO. 7, filed for record in the office of the County
Recorder of Douglas County, Nevada, on March 27, 1974, as
Document No. 72456.

Assessors Parcel No. 1220-22-310-187

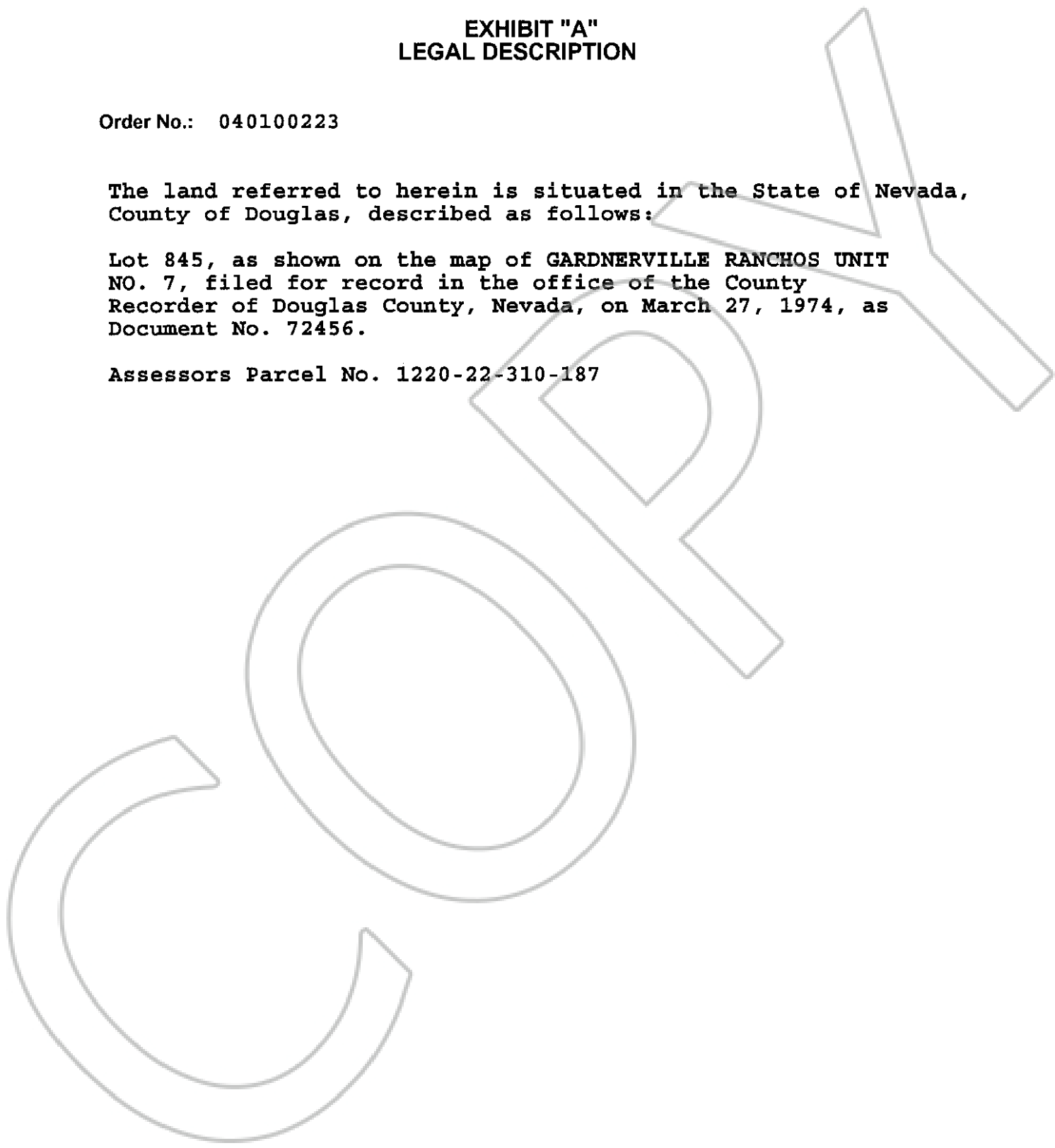

0605370
BK0204PG09506