

EXHIBIT "A"

LEGAL DESCRIPTION

ESCROW NO.: 040700291

The Westerly 220 feet of that portion of the Southeast Quarter of the Southeast Quarter of the South Half of Lot 1 of the Southwest Quarter of Section 6, Township 14 North, Range 20 East, M.D.B.&M., lying Southerly of the existing Jack's Valley Road.

ASSESSOR'S PARCEL NO. 1420-06-410-019

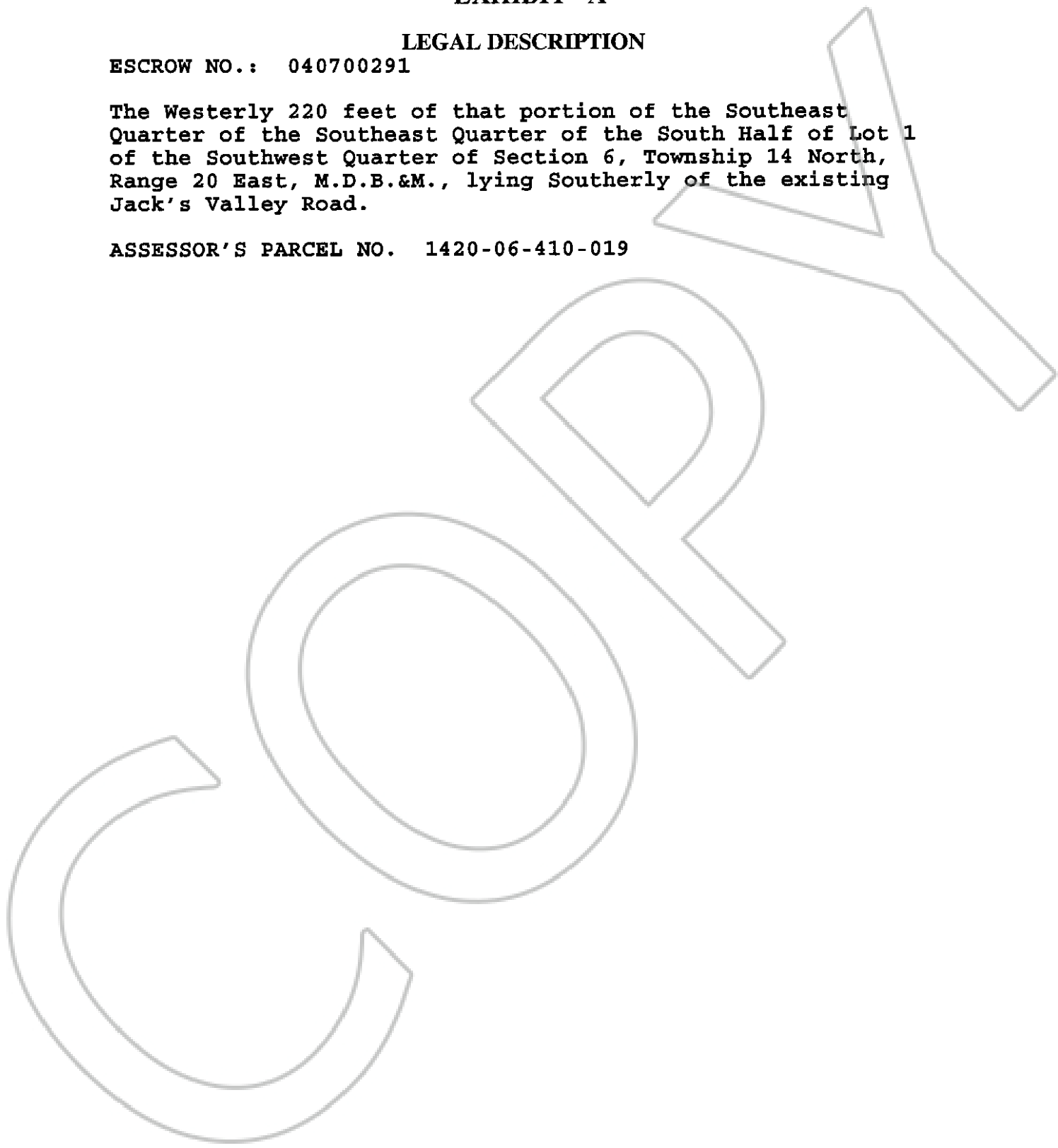

0605393

BK0204PG09716