

A.P.N. # 1220-04-515-001

R.P.T.T. \$ 0 #5

ESCROW NO. 040700286

RECORDING REQUESTED BY:
STEWART TITLE COMPANY

MAIL TAX STATEMENTS TO:
SAME AS BELOW

WHEN RECORDED MAIL TO:
GRANTEE
3990 Shale Drive
Wellington, NV 89444

REQUESTED BY
Stewart Title of Douglas County
IN OFFICIAL RECORDS OF
DOUGLAS CO., NEVADA

2004 FEB 24 PM 3:34

WERNER CHRISTEN
RECORDER

\$15⁰⁰ PAID Kg DEPUTY

(Space Above for Recorder's Use Only)

GRANT, BARGAIN, SALE DEED

THIS INDENTURE WITNESSETH: That **SANDRA KAY KUEHNEL, a married woman and spouse of within Grantee**

in consideration of \$10.00, the receipt of which is hereby acknowledged, does hereby Grant, Bargain Sell and Convey to **ERNEST M. KUEHNEL, a married man as his sole and separate property**

and to the heirs and assigns of such Grantee forever, all that real property situated in the County of **Douglas** State of Nevada, bounded and described as :

SEE EXHIBIT "A" ATTACHED HERETO AND MADE A PART HEREOF

IT IS THE EXPRESS INTENT OF THE GRANTOR, BEING THE SPOUSE OF THE GRANTEE, TO CONVEY ALL RIGHT, TITLE AND INTEREST OF THE GRANTOR, COMMUNITY OR OTHERWISE, IN AND TO THE HEREIN DESCRIBED PROPERTY TO THE GRANTEE AS GRANTEE'S SOLE AND SEPARATE PROPERTY.

Together with all and singular the tenements, hereditaments and appurtenances thereunto belonging or in anywise appertaining, and any reversions, remainders, rents, issues or profits thereof.

DATE: **February 19, 2004**

SANDRA KAY KUEHNEL

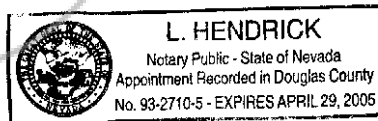

STATE OF Nevada }
COUNTY OF Douglas } ss.

This instrument was acknowledged before me on 2-19-04
by, **SANDRA KAY KUEHNEL**

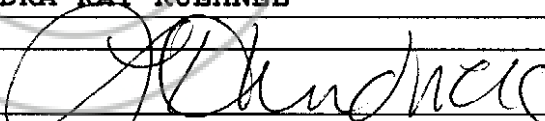
Signature 
Notary Public (One Inch Margin on all sides of Document for Recorder's Use Only)

0605496

BK0204PG10264

EXHIBIT "A"

LEGAL DESCRIPTION

ESCROW NO.: 040700286

**The land referred to herein is situated in the
State of Nevada, County of Douglas
City of GARDNERVILLE described as follows:**

**Lot 42, CARSON VALLEY ESTATES UNIT NO. 3, as shown on the
official map recorded in the office of the County Recorder
of Douglas County, Nevada, on September 15, 1971, as
Document No. 54454.**

Assessor's Parcel No. 1220-04-515-001

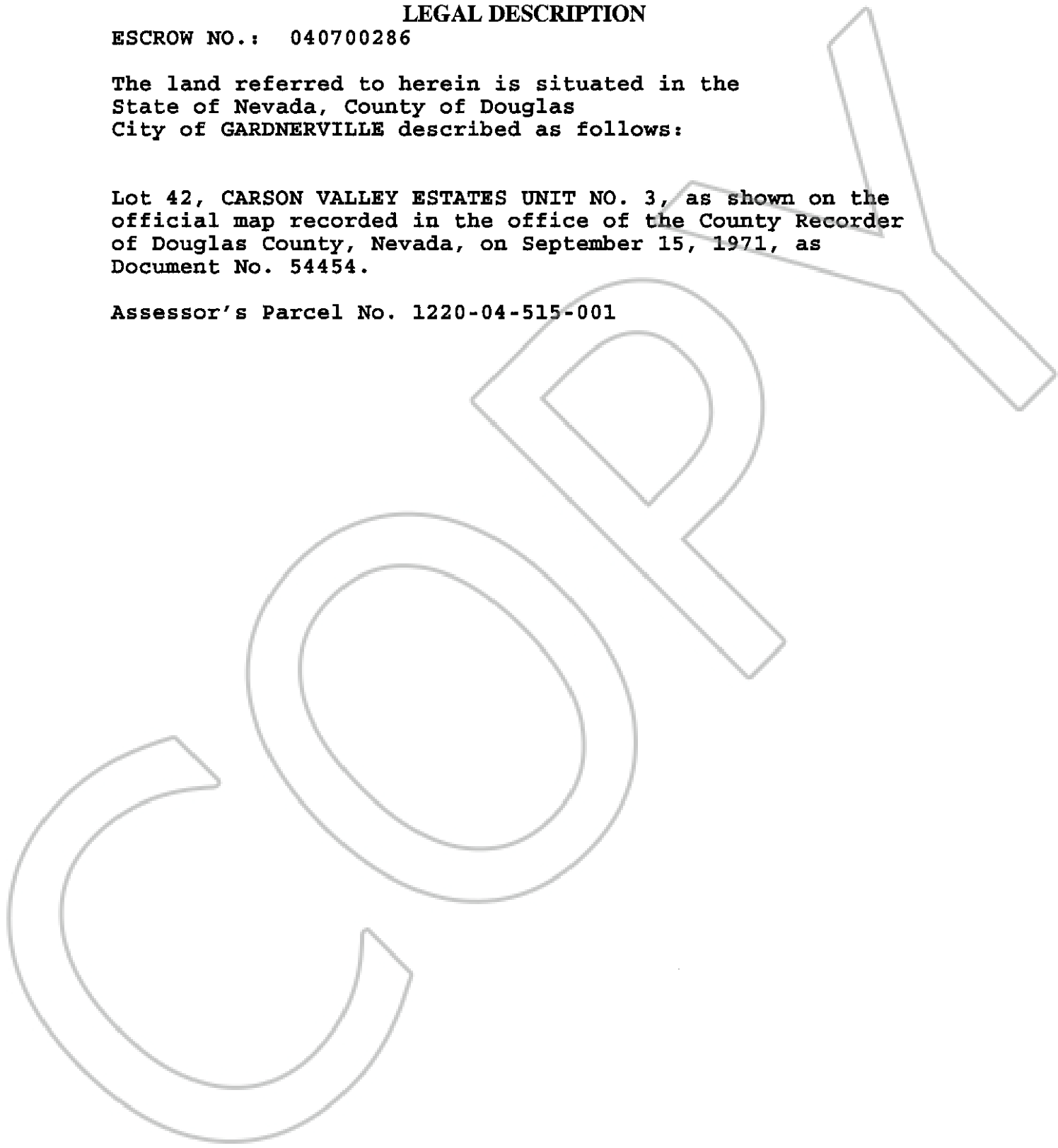

0605496

BK0204PG10265