

EXHIBIT "A"

LEGAL DESCRIPTION

ESCROW NO.: 040200134

Lot 131, Block B, as shown on the Final Map of WILDHORSE UNIT 4, A PLANNED UNIT DEVELOPMENT, filed for record in the office of the County Recorder of Douglas County, State of Nevada, on December 12, 1990 in Book 1290, Page 3944, as Document No. 241974.

Assessors Parcel No. 1420-33-212-007

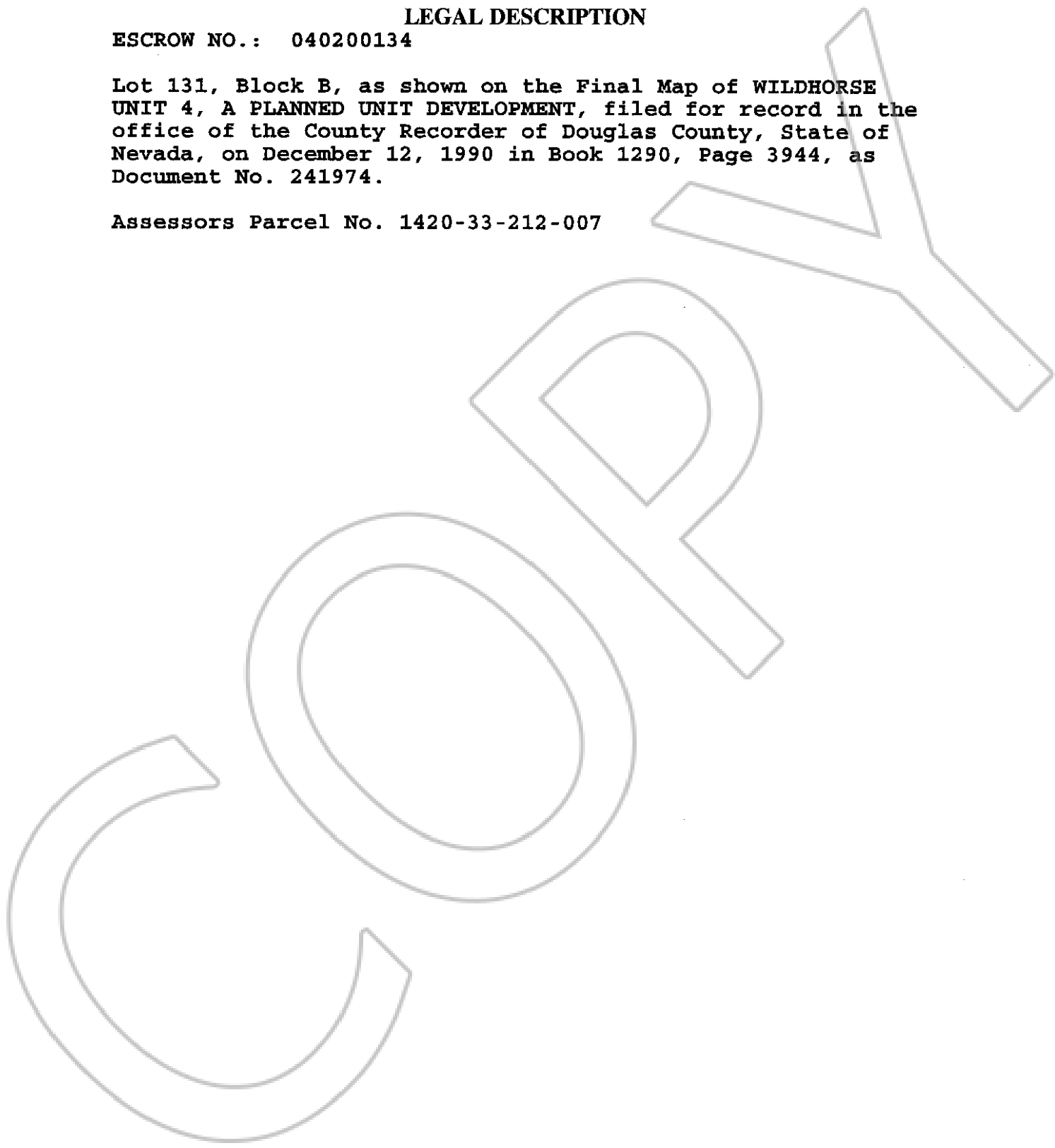

0605701

BK0204PG11383