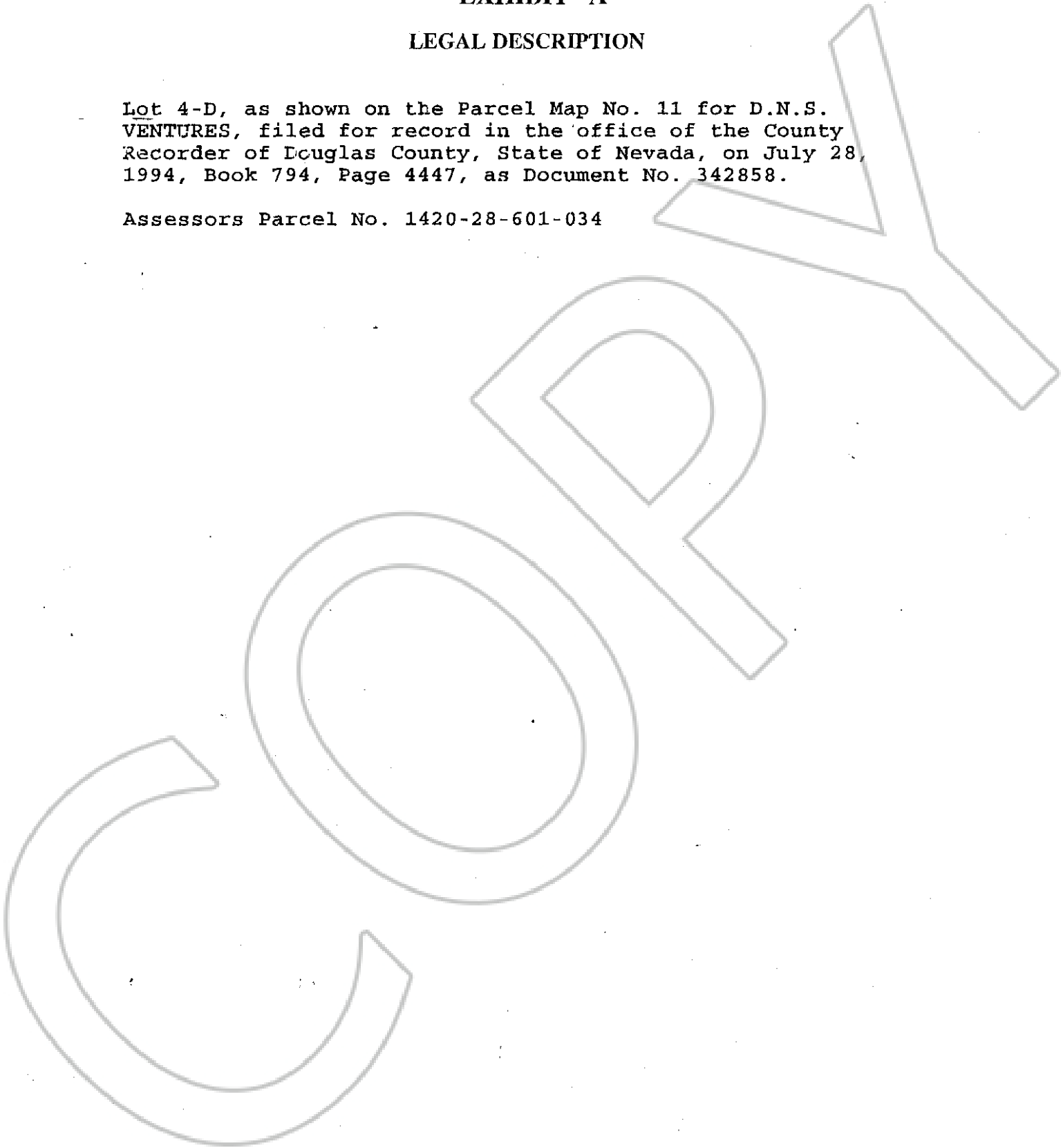

EXHIBIT "A"

LEGAL DESCRIPTION

Lot 4-D, as shown on the Parcel Map No. 11 for D.N.S. VENTURES, filed for record in the office of the County Recorder of Douglas County, State of Nevada, on July 28, 1994, Book 794, Page 4447, as Document No. 342858.

Assessors Parcel No. 1420-28-601-034



0605747

BK0204PG11763