

A.P.N. # 1320-33-312-014

R.P.T.T. \$ 943.80

ESCROW NO. 040800462

RECORDING REQUESTED BY:  
**STEWART TITLE COMPANY**

MAIL TAX STATEMENTS TO:  
**SAME AS BELOW**

WHEN RECORDED MAIL TO:  
GRANTEE  
1223 Pleasantview Drive  
Gardnerville, Nv 89460

REQUESTED BY  
**Stewart Title of Douglas County**

IN OFFICIAL RECORDS OF  
DOUGLAS CO., NEVADA

2004 FEB 27 PM 2:49

WERNER CHRISTEN  
RECORDER

\$ 15.00 PAID Kj DEPUTY

(Space Above for Recorder's Use Only)

**GRANT, BARGAIN, SALE DEED**

THIS INDENTURE WITNESSETH: That **SHANNON BRECICK, an unmarried person AND MARJORY BRECICK, an unmarried person**

in consideration of \$10.00, the receipt of which is hereby acknowledged, does hereby Grant, Bargain Sell and Convey to **MARTIN/HUARTE AND MARIA/HUARTE, HUSBAND AND WIFE AS JOINT TENANTS** M.

and to the heirs and assigns of such Grantee forever, all that real property situated in the County of **DOUGLAS** State of Nevada, bounded and described as:

**SEE EXHIBIT "A" ATTACHED HERETO AND MADE A PART HEREOF**

Together with all and singular the tenements, hereditaments and appurtenances thereunto belonging or in anyway appertaining, and any reversions, remainders, rents, issues or profits thereof.

DATE: **February 20, 2004**

*Shannon Brecick*  
SHANNON BRECICK

*Marjory Brecick*  
MARJORY BRECICK

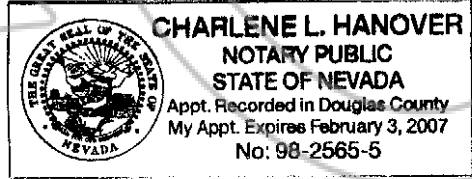

STATE OF NEVADA }  
} ss.  
COUNTY OF DOUGLAS }

This instrument was acknowledged before me on 2/25/2004 by SHANNON BRECICK and MARJORY BRECICK

Signature Charlene L. Hanover  
Notary Public (One inch margin on all sides of document for Recorder's Use Only)

**EXHIBIT "A"**

**LEGAL DESCRIPTION**

**ESCROW NO.: 040800462**

**The land referred to herein is situated in the  
State of Nevada, County of DOUGLAS  
City of GARDNERVILLE described as follows:**

**Lot 9, in Block A, as set forth on Final Subdivision Map FSM  
#1006-3 of CHICHESTER ESTATES, PHASE 3, filed for record in  
the office of the County Recorder of Douglas County, State  
of Nevada, on September 11, 1997 in Book 997, at Page 2121,  
as Document No. 421409, Official Records.**

**Assessors Parcel No. 1320-33-312-014**

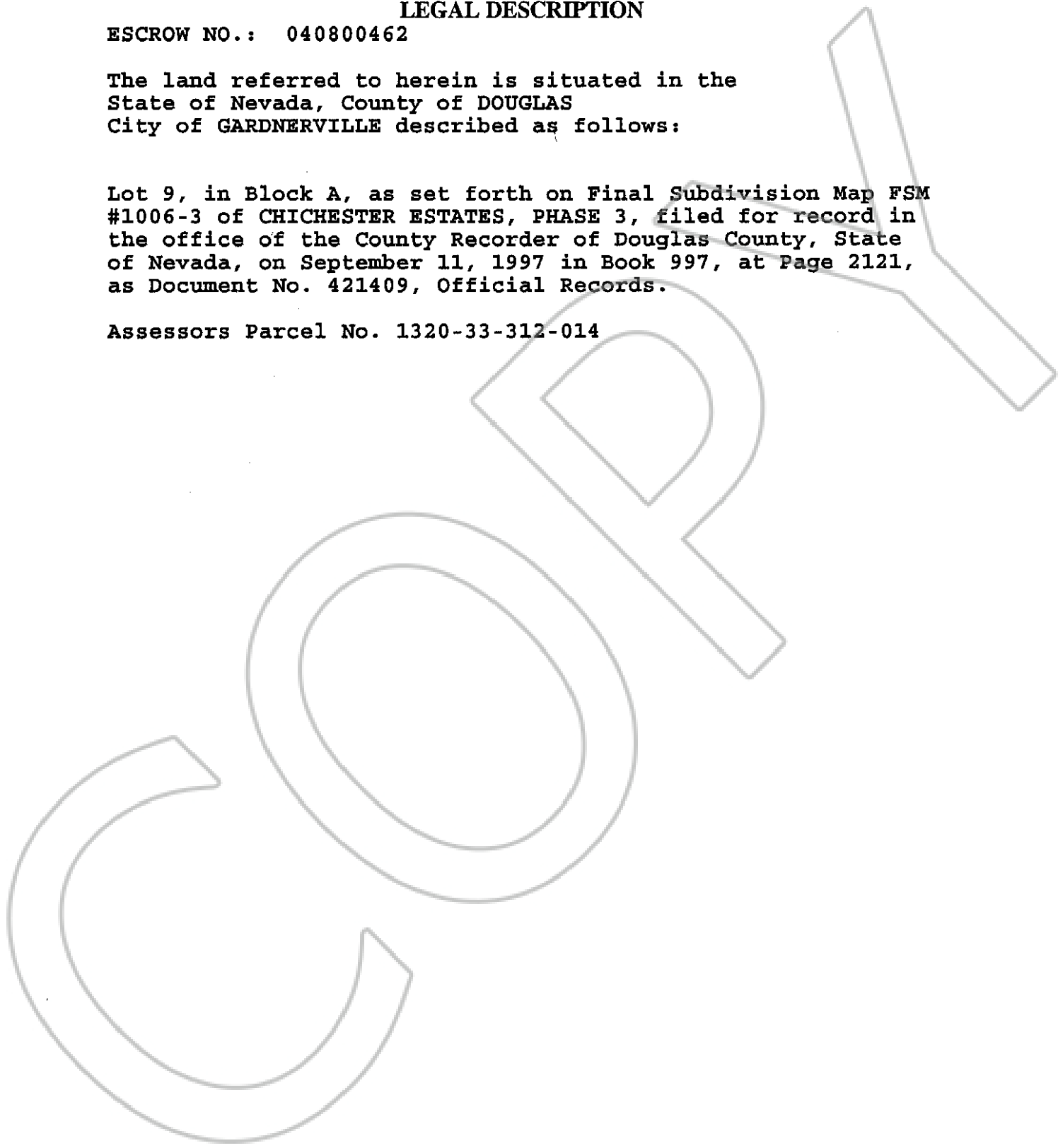

0605889

BK0204PG12584