

REQUESTED BY

**MARQUIS TITLE & ESCROW**

IN OFFICIAL RECORDS  
DOUGLAS CO., NEVADA

A.P.N. 1320-02-002-018  
Escrow No. 243020  
R.P.T.T. ~~\$0.00~~ #5

2004 FEB 27 PM 3: 50

When recorded Mail To:  
(Tax Statement Same)  
Mr. & Mrs. Roger V. Watts, Jr.  
1691 Devon Ct.  
Minden, Nevada 89423

WERNER CHRISTEN  
RECORDER

\$15<sup>02</sup> PAID *RJ* DEPUTY

**GRANT, BARGAIN AND SALE DEED**

**THIS INDENTURE WITNESSETH:** That for a valuable consideration, receipt of which is hereby acknowledged,

ROGER V. WATTS, JR. and ELIZABETH K. WATTS, husband and wife as joint tenants

do(es) hereby **GRANT, BARGAIN, SELL and CONVEY** to ROGER V. WATTS, JR. and ELIZABETH K. WATTS, husband and wife as joint tenants with the right of survivorship

all that real property situated in the County of Douglas, State of Nevada, being Assessor's Parcel Number **1320-02-002-018**, specifically described as follows:

SEE EXHIBIT "A" ATTACHED HERETO AND MADE A PART HEREOF

TOGETHER with all and singular the tenements, hereditaments and appurtenances, including easements and water rights, if any, thereto belonging or in anywise appertaining, and any reversions, remainders, rents, issues of profits thereof.

WITNESS my hand this 23 day of February, 2004.

*Roger V. Watts, Jr.*

ROGER V. WATTS, JR.

*Elizabeth K. Watts*

ELIZABETH K. WATTS

STATE OF NEVADA  
COUNTY OF DOUGLAS



On 2-23, 2004, ROGER V. WATTS, JR. and ELIZABETH K. WATTS personally appeared before me, a Notary Public, who acknowledged that they executed the above instrument.

*Deborah L. Ortiz*  
Notary Public

0605923

BK0204PG12897

## EXHIBIT "A"

**The land referred to herein is situate in Douglas County, State of Nevada, and is described as follows:**

Situate in the Southeast 1/4 of the Northeast 1/4 of the Southwest 1/4 of Section 2, Township 13 North, Range 20 East, M.D.B. & M., described as follows:

Parcel No. 4, as set forth on Parcel Map #1020 for DANIEL AND KATHY BARNES, recorded September 16, 1996, in Book 996, Page 1906, Document No. 396356 of Official Records.

Assessor's Parcel No. 1320-02-002-018

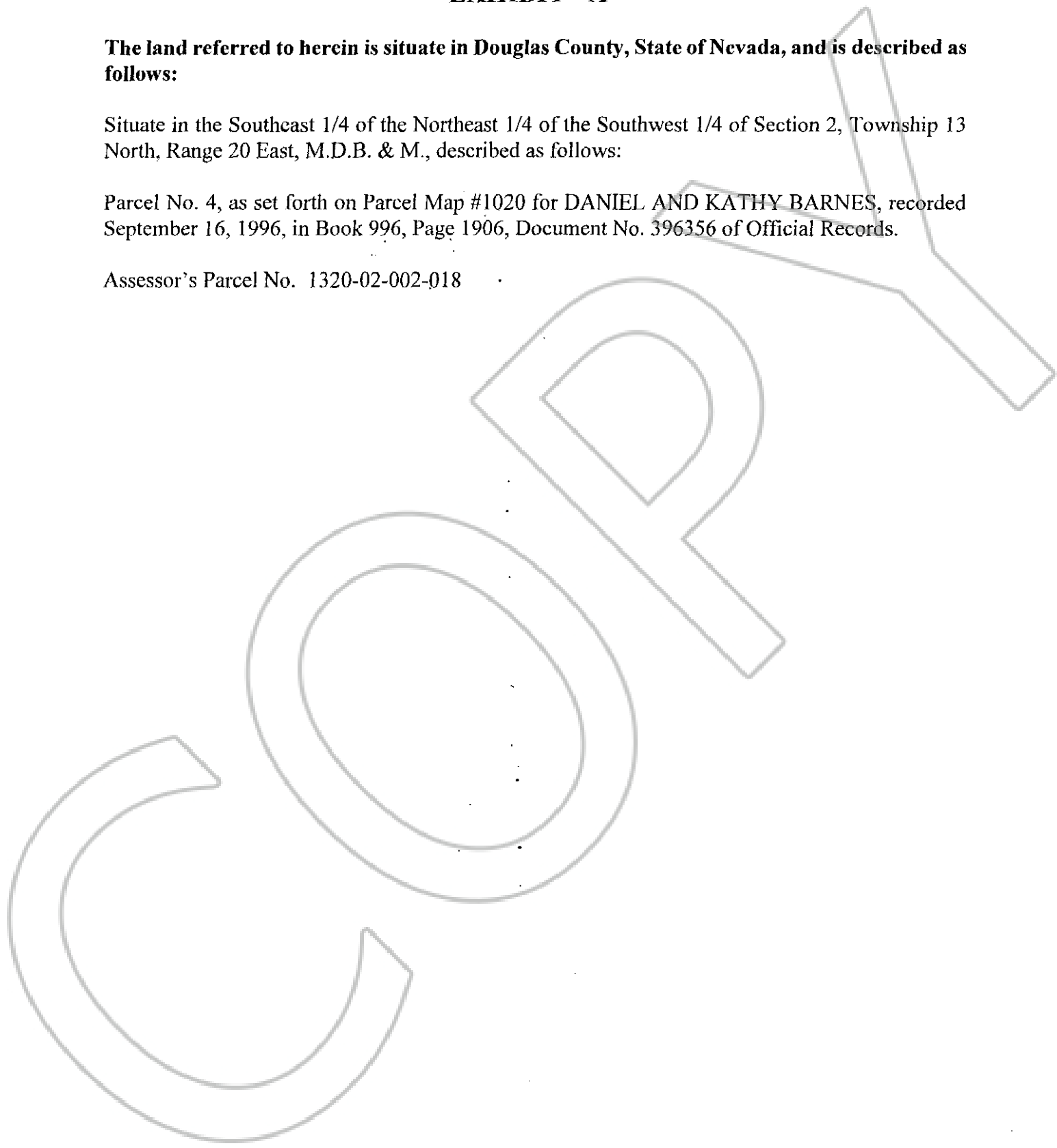

0605923

BK0204 PG12898