

A.P.N. # 1420-33-701-052

R.P.T.T. \$ 1423.50

ESCROW NO. 040800459

RECORDING REQUESTED BY:
STEWART TITLE COMPANY
MAIL TAX STATEMENTS TO:
SAME AS BELOW

WHEN RECORDED MAIL TO:
GRANTEE
2670 DEL SUR COURT
MINDEN, NEVADA

REQUESTED BY
Stewart Title of Douglas County

IN OFFICIAL RECORDS OF
DOUGLAS CO., NEVADA

2004 MAR -1 PM 3: 27

WERNER CHRISTEN
RECORDER

\$15⁰⁰ PAID KJ DEPUTY

(Space above for Recorder's Use Only)

CORPORATION
GRANT, BARGAIN, SALE DEED

THIS INDENTURE WITNESSETH: That
JEFF KIRBY HOMES, INC., a Nevada Corporation

in consideration of \$10.00, the receipt of which is hereby acknowledged, does hereby Grant, Bargain Sell and Convey to

THOMAS R. WHEELER and MICHELLE/PERRAULT, husband and wife
AS JOINT TENANTS A.

and to the heirs and assigns of such Grantee forever, all that real property situated in the
County of **Douglas** State of Nevada,

bounded and described as follows:

SEE EXHIBIT "A" ATTACHED HERETO AND MADE A PART HEREOF

Together with all and singular the tenements, hereditaments and appurtenances thereunto belonging or in anywise appertaining, and any reversions, remainders, rents, issues or profits thereof.

DATE: **February 11, 2004**

JEFF KIRBY HOMES, INC.,
a Nevada Corporation

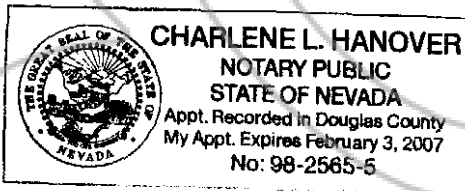

BY: [Signature]
JEFFREY K. KIRBY
PRESIDENT

BY: _____

STATE OF NEVADA }
} ss.

COUNTY OF DOUGLAS }

This instrument was acknowledged before me on 2/19/2004
by JEFFREY K. KIRBY

Signature [Signature]

Notary Public (One Inch Margin on all sides of Document for Recorder's Use Only)

0606053

BK0304PG00478

EXHIBIT "A"

LEGAL DESCRIPTION

ESCROW NO.: 040800459

Parcel 6 of Parcel Map LDA 01-057 for Sierra View
Development filed for record on September 26, 2001, book
0901, Page 6251, as Document No. 523546, Official Records,
Douglas County, Nevada.

ASSESSOR'S PARCEL NO. 1420-33-701-052

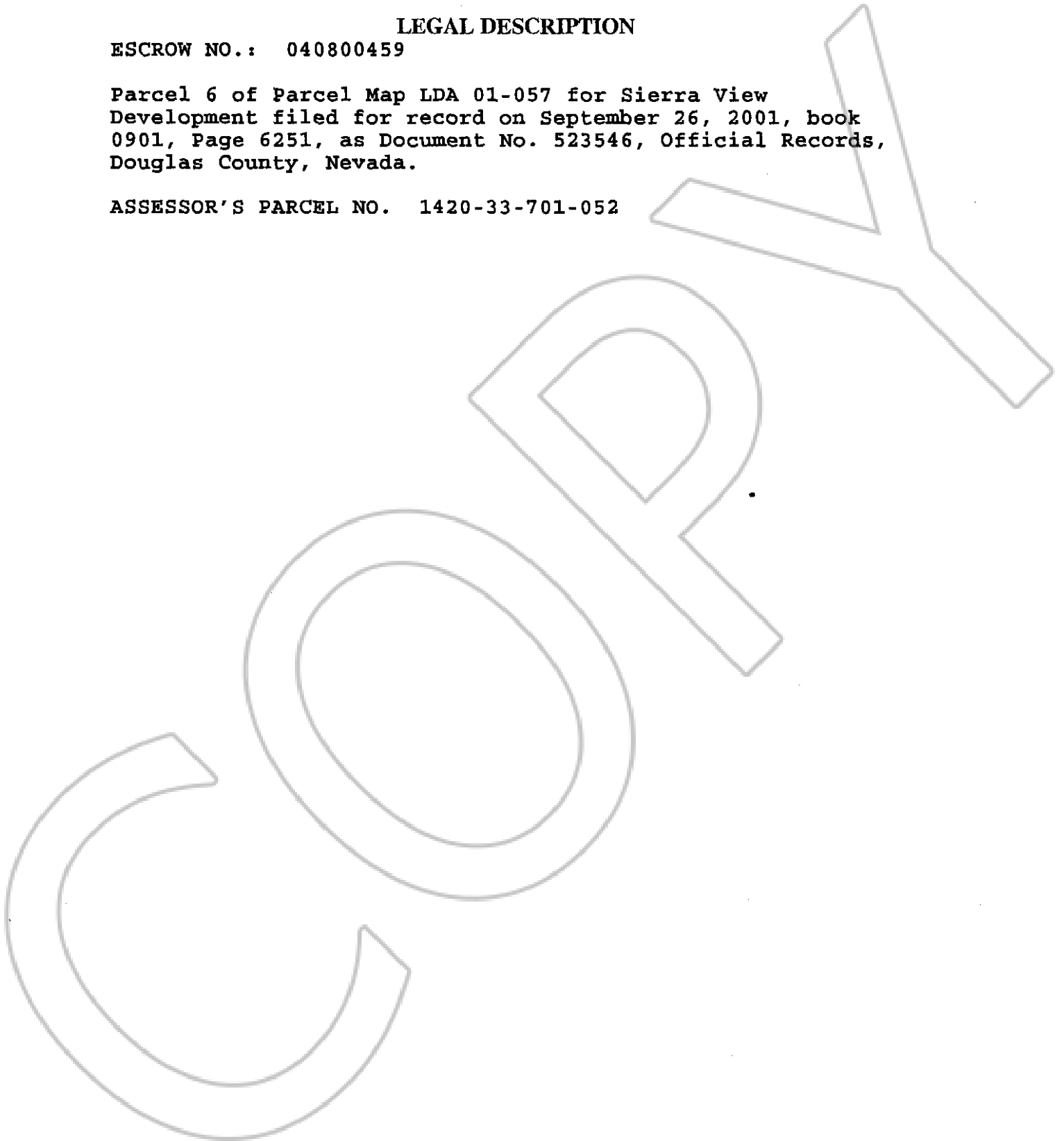

0606053

BK0304PG00479